

# Ordinance No. 82425

AN ORDINANCE relating to and providing for the annexation to the city of the area between 1st Avenue Northeast and Puget Sound and the City Limits and East 145th Street.

RES. NO. 1645-1

FILE NO. 222397

# Council Bill No. 73809

INTRODUCED: OCT 26 1953	BY: JUDICIARY
REFERRED: OCT 26 1953	COMMITTEE OF WHOLE
REFERRED:	
REPORTED: OCT 26 1953	VETO:
SECOND READING: OCT 26 1953	PUBLISHED:
THIRD READING: NOV 2 1953	VETO SUSTAINED:
SIGNED: NOV 2 1953	PASSED OVER VETO:
PRESENTED TO MAYOR: NOV 2 1953	APPROVED: NOV 2 1953
FILED: NOV 2 1953	PUBLISHED: NOV 7 1953
ENGROSSED: VOL. 12 PAGE 99	BY: jc ✓
COMPARED BY:	

AND

ORDINANCE NO. 82425

AN ORDINANCE relating to and providing for the annexation to the city of the area between 1st Avenue Northeast and Puget Sound and the City Limits and East 145th Street.

WHEREAS, pursuant to Remington's Revised Statutes Section 8896 et seq, R. C. W. Sec. 35.13.010 et seq, residents of the area between 1st Avenue Northeast and Puget Sound and the City Limits and East 145th Street duly filed with the County Commissioners of King County a petition for annexation of the territory hereinafter described to the City of Seattle; and

WHEREAS, as shown by the duly certified abstract of votes and Resolution No. 14284 of the Board of King County Commissioners (Comptroller's File No. 222397) an election was duly held in said territory on the 15th day of September, 1953, at which a majority of the votes cast were for annexation and the King County Canvassing Board has so found and certified; and

WHEREAS, by Resolution No. 16451, adopted October 26, 1953, the City Council has declared that it is expedient that such territory be annexed; Now, Therefore,

BE IT ORDAINED BY THE CITY OF SEATTLE AS FOLLOWS:

Section 1. That the following described contiguous territory,

to-wit:

Beginning at a point on the present city limits at the intersection of the center line of North and East 125th Street and the center line of 1st Avenue Northeast; thence following present city limits, south on 1st Avenue Northeast to East 90th Street; thence west to the intersection of North 90th Street and Fremont Avenue; thence south to North 85th Street; thence west to 24th Avenue Northwest; thence north to a line midway between West 91st Street and West 92nd Street; thence west to the production north of the east line of 26th Avenue Northwest as platted between West 85th Street and West 88th Street; thence south to West 85th Street; thence west to the west line of Golden Avenue; thence northerly to "V" Street; thence northwesterly to the easterly line of the Great Northern Railway Company right of way; thence southerly to section line on the center line of West 85th Street produced; thence west to the westerly line of the Great Northern Railway Company right of way; thence northerly to the center line of West 95th Street; thence westerly to the middle of Puget Sound; thence, leaving the present city limits, northerly along the center line of Puget Sound to an intersection with the north line of Section 24, Township 26 North, Range 3 East, W.M., produced west; thence east along said section line and the center line of North 145th Street on the north line of Sections 19 and 20, Township 26 North, Range 4 East, W.M., to an intersection with the center line of 1st Avenue Northeast; thence south on said center line of 1st Avenue Northeast to the point of beginning at the intersection of North and East 125th Street.

be and the same is hereby annexed to the City of Seattle as of the

(To be used for all Ordinances except Emergency.)

4th day of January, 1954 and from and after said date shall become and be a part of the City of Seattle subject to all the laws and ordinances thereof then and thereafter in force.

Section 2. This ordinance shall take effect and be in force thirty days from and after its passage and approval, if approved by the Mayor; otherwise it shall take effect at the time it shall become a law under the provisions of the city charter.

Passed by the City Council the 2 day of November, 1953,  
and signed by me in open session in authentication of its passage this 2 day of  
November, 1953 Frank J. Lander

President Pro Tem of the City Council.

Approved by me this 2 day of November, 1953,  
David Lipp  
Acting Mayor.

Filed by me this 2 day of November, 1953.

Attest: Thomas  
City Comptroller and City Clerk.

(SEAL)

Published.....

NOV 7 1953

By M. A. Perine  
Deputy Clerk.

November 5, 1953

Mr. L. M. Dimmitt  
County Superintendent of Schools  
County of King  
Seattle 4, Washington

Dear Sir:

Transmitted herewith are certified copies of the following  
Ordinances of the City of Seattle:

Ordinance No. 82425 relating to and providing for the  
annexation to the city of the area between 1st Avenue Northeast  
and Puget Sound and the City Limits and East 145th Street;

Ordinance No. 82426 relating to and providing for the  
annexation to the city of the area between 1st Avenue Northeast  
and Lake Washington and the City Limits and East 145th Street.

Very truly yours,

W. C. THOMAS  
Comptroller and  
City Clerk

Enclosure

November 5, 1953

Board of County Commissioners  
County of King  
Seattle 4, Washington

ATTN: Mr. Ralph Stender  
Clerk of the Board.

Gentlemen:

Transmitted herewith are certified copies of the following  
Ordinances of the City of Seattle:

Ordinance No. 82425 relating to and providing for the  
annexation to the city of the area between 1st Avenue Northeast  
and Puget Sound and the City Limits and East 145th Street;

Ordinance No. 82426 relating to and providing for the  
annexation to the city of the area between 1st Avenue Northeast  
and Lake Washington and the City Limits and East 145th Street.

Very truly yours,

W. C. THOMAS  
Comptroller and  
City Clerk

Enclosure

November 5, 1953

Mr. Robert A. Morris  
County Auditor  
King County  
Seattle 4, Washington

Dear Sir:

Transmitted herewith are certified copies of the following  
Ordinances of the City of Seattle:

Ordinance No. 82425 relating to and providing for the  
annexation to the city of the area between 1st Avenue Northeast  
and Puget Sound and the City Limits and East 145th Street;

Ordinance No. 82426 relating to and providing for the  
annexation to the city of the area between 1st Avenue Northeast  
and Lake Washington and the City Limits and East 145th Street.

Very truly yours,

W. C. THOMAS  
Comptroller and  
City Clerk

Enclosure

November 5, 1953

Mr. Ralph S. Stacy  
County Assessor  
King County  
Seattle 4, Washington

Dear Sir:

Transmitted herewith are certified copies of the following  
Ordinances of the City of Seattle:

Ordinance No. 82425 relating to and providing for the  
annexation to the city of the area between 1st Avenue Northeast  
and Puget Sound and the City Limits and East 145th Street;

Ordinance No. 82426 relating to and providing for the  
annexation to the city of the area between 1st Avenue Northeast  
and Lake Washington and the City Limits and East 145th Street.

Very truly yours,

W. C. THOMAS  
Comptroller and  
City Clerk

Enclosure

## ORDINANCE NO. 82425

AN ORDINANCE relating to and providing for the annexation to the city of the area between 1st Avenue Northeast and Puget Sound and the City Limits and East 145th Street.

WHEREAS, pursuant to Remington's Revised Statutes, Section 8886 et seq., R. C. W. Sec. 35.13.010 et seq., residents of the area between 1st Avenue Northeast and Puget Sound and the City Limits and East 145th Street duly filed with the County Commissioners of King County a petition for annexation of the territory hereinafter described to the City of Seattle; and

WHEREAS, as shown by the duly certified abstract of votes and Resolution No. 14284 of the Board of King County Commissioners (Comptroller's File No. 222397) an election was duly held in said territory on the 15th day of September, 1953, at which a majority of the votes cast were for annexation and the King County Canvassing Board has so found and certified; and

WHEREAS, by Resolution No. 16461, adopted October 24, 1963, the City Council has declared that it is expedient that such territory be annexed; Now, Therefore,

BE IT ORDAINED BY THE CITY OF SEATTLE AS FOLLOWS:

Section 1. That the following described contiguous territory, to-wit:

Beginning at a point on the present city limits at the intersection of the center line of North and East 125th Street and the center line of 1st Avenue Northeast; thence following present city limits, south on 1st Avenue Northeast to East 80th Street; thence west to the intersection of North 80th Street and Fremont Avenue; thence south to North 85th Street; thence west to 24th Avenue Northwest; thence north to a line midway between West 91st Street and West 92nd Street; thence west to the production north of the east line of 24th Avenue Northwest as platted between West 85th Street and West 83rd Street; thence south to West 85th Street; thence south to the west line of Golden Avenue; thence northerly to "Y" Street; thence northwesterly to the easterly line of the Great Northern Railway Company right of way; thence southerly to section line on the center line of West 85th Street produced; thence west to the westerly line of the Great Northern Railway Company right of way; thence northerly to the center line of West 95th Street; thence westerly to the middle of Puget Sound; thence, leaving the present city limits, northerly along the center line of Puget Sound to an intersection with the north line of Section 24, Township 28 North, Range 3 East, W. M., produced west; thence east along said section line and the center line of North 145th Street on the north line of Sections 19 and 20, Township 28 North, Range 4 East, W. M., to an intersection with the center line of 1st Avenue Northeast; thence south on said center line of 1st Avenue Northeast to the point of beginning at the intersection of North and East 125th Street.

be and the same is hereby annexed to the City of Seattle as of the 4th day of January, 1954, and from and after said date shall become and be a part of the City of Seattle subject to all the laws and ordinances thereof then and thereafter in force.

Section 2. This ordinance shall take effect and be in force thirty days from and after its passage and approval, if approved by the Mayor; otherwise it shall take effect at the time it shall become a law under the provisions of the city charter.

Passed by the City Council the 2nd day of November, 1953, and signed by me in open session in authentication of its passage this 2nd day of November, 1953.

FRANK J. LAUBE,  
President pro tem. of the City Council.

Approved by me this 2nd day of November, 1953.

DAVID LEVIN,  
Acting Mayor.

Filed by me this 2nd day of November, 1953.

Attest: W. C. THOMAS,  
City Comptroller and City Clerk.

(Seal) By W. A. PERIN,  
Deputy Clerk.

Date of official publication in the Daily Journal of Commerce, Seattle, November 7, 1953. (C-2310)

## Affidavit of Publication

STATE OF WASHINGTON. } ss.  
COUNTY OF KING

M. E. Brown, being first duly sworn, on oath deposes and says that he is the business manager and one of the publishers of The Daily Journal of Commerce, a daily newspaper. That said newspaper is a legal newspaper and it is now and has been for more than six months prior to the date of the publication hereinafter referred to, published in the English language continuously as a daily newspaper in Seattle, King County, Washington, and it is now and during all of said time was printed in an office maintained at the aforesaid place of publication of said newspaper. That the said Daily Journal of Commerce was on the 12th day of June, 1941, approved as a legal newspaper by the Superior Court of said King County

That the annexed is a true copy of .....

ORDINANCE NO 82425

....., as it was published in the regular issue (and not in supplement form) of said newspaper on the 7TH day of NOVEMBER, 1953, and that said newspaper was regularly distributed to its subscribers during all of said period.

*M. E. Brown*

Subscribed and sworn to before me this

7TH day of NOVEMBER 1953

*E. Campbell*

Notary Public in and for the State of Washington, residing at Seattle.  
(This form officially sanctioned by Washington State Press Association.)  
affidavit Form D.



JAMES A. GIBBS, CHAIRMAN  
COMMISSIONER, FIRST DISTRICT

WM. H. SEARS  
COMMISSIONER, SECOND DISTRICT

DEAN C. MCLEAN  
COMMISSIONER, THIRD DISTRICT

KING COUNTY COMMISSIONERS  
402 COUNTY-CITY BUILDING  
SEATTLE 4

November 12, 1953

RALPH R. STENDER  
CLERK OF THE BOARD

The City Council  
Seattle  
Washington

Gentlemen:

This will acknowledge receipt of communication of November 5, 1953 filing copy of Ordinance No. 82425 relating to and providing for annexation to the City of Seattle of the area between 1st Avenue Northeast and Puget Sound and the City Limits and East 145th Street, as of Jan. 4, 1954.

The Board of County Commissioners in regular session on November 9, 1953, on motion, placed same on file.

Very truly yours,

BOARD OF COUNTY COMMISSIONERS  
ROBERT J. MORRIS, Clerk of Board

By   
Ralph R. Stender, Deputy

RRS:b

May SR 425

PROPOSED  
ANNEXATION AREA  
GREENWOOD DISTRICT  
7.4± SQUARE MILES  
(EAST OF HARBOR LINE.)

1 INCH = 1/4 MILE.  
PUGET SOUND

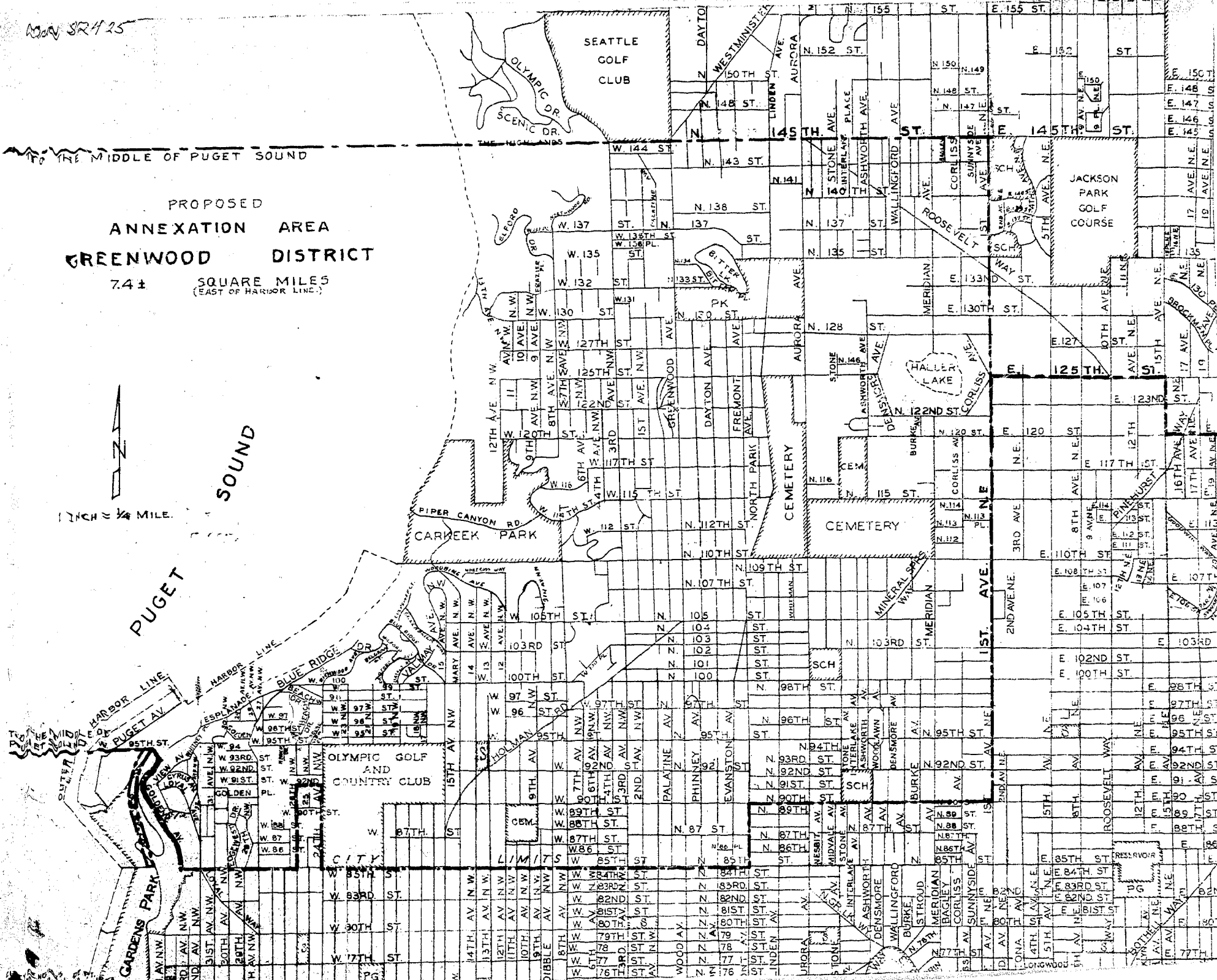

THE MIDDLE OF PUGET SOUND

PROPOSED  
ANNEXATION AREA  
GREENWOOD DISTRICT

7.4± SQUARE MILES  
(EAST OF HARBOR LINE.)

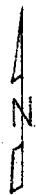

1 INCH =  $\frac{1}{4}$  MILE.

SOUND

PUGET

E MIDDLE  
T. SOUND