



Maintaining Pedestrian Mobility During Construction

2015 Work Plan

Transportation Committee Presentation

Brian de Place

December 9, 2014

SDOT's mission & vision

Mission: delivering a first-rate transportation system for Seattle.



Vision: a vibrant Seattle with connected people, places, and products.

SDOT's core principles



Presentation overview

- Access Seattle
- Current Pedestrian Access Policy
- 2014 Access Seattle Implementation
- Sidewalk Closure Standards
- Work Plan, Tools & Next Steps
- Questions

Access Seattle & SDOT

- Working for mobility with:
 - business and community support
 - traveler engagement
 - construction coordination
- Commitment to maintaining open sidewalks during construction
- #1 priority = Safety
- Vision Zero: eliminate fatalities and serious injuries on our streets by 2030

SDOT Director's Rule 1-2011

Best practices of Washington DC, NYC

Collaborative process with Auditor, pedestrians, builders

Streets with higher pedestrian volumes remain open for most construction phases



Reasons for Sidewalk Closures

- Zero lot line construction
- Subterranean structures
- Shoring systems
- Steep slopes
- Overhead power lines

Table 1—Pedestrian Mobility by Phase of Construction

Phase of Construction on private property	Preferred Method of maintaining pedestrian mobility	Alternative Method of maintaining pedestrian mobility
Demolition	Covered Walkway or open walkway	Sidewalk Closure (if significant overhead danger) with detour route across the street
Shoring/Excavation	Open walkway	Intermittent Sidewalk Closure (up to 20 days at a time) with detour route across the street
Construction on private property	Covered or open Walkway	No alternative allowed
Post Skin	Covered or open walkway	No alternative allowed
Facade/skin	Covered or open walkway	Intermittent Sidewalk Closure (up to 20 days at a time) with detour route across the street
Installing Canopies	Sidewalk Closure with detour route across the street	Covered walkway
Street Improvements	Open walkway	Sidewalk Closure: (generally 4-8 weeks) with detour route across the street
Utility Work	Open walkway	Intermittent Sidewalk Closure with detour route across the street (Temporary restoration of walkway must occur within 10 days of service connection inspection sign-off.)

Sidewalk Closures and Walkways: NYC

625 W 57th St

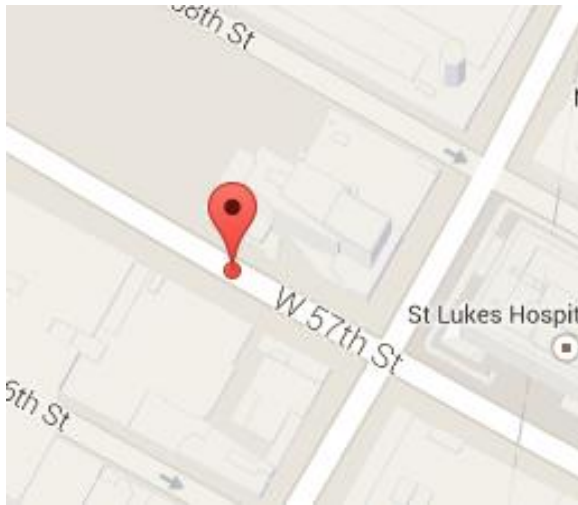

Sidewalk Closures and Walkways: NYC

E 26th & 1st Ave

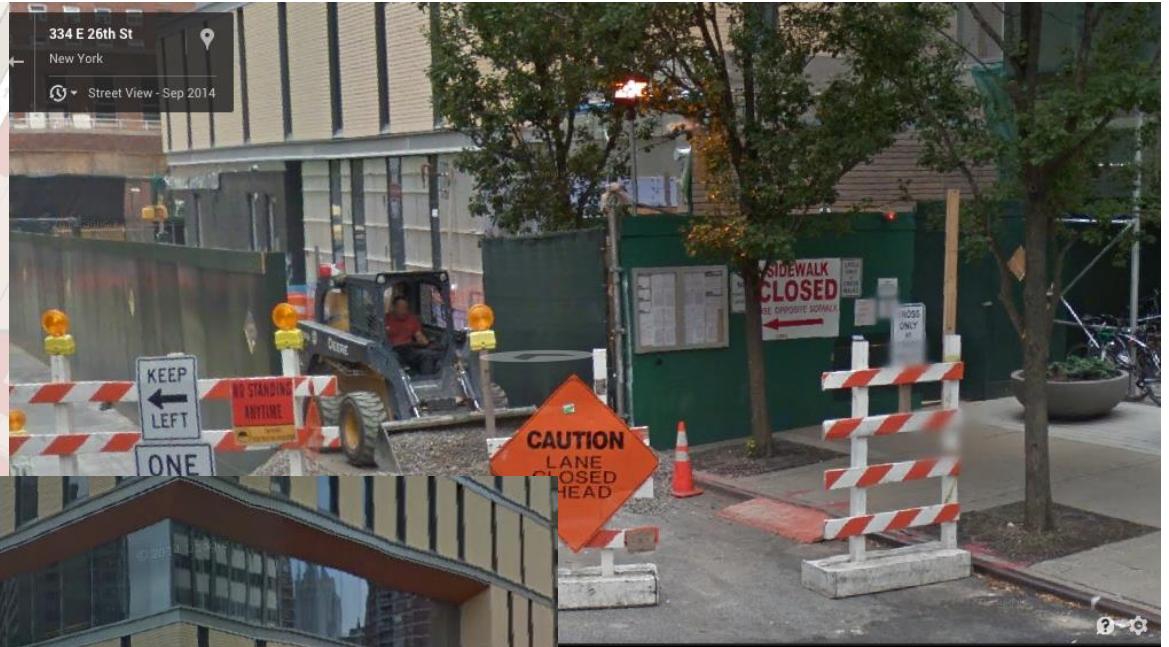
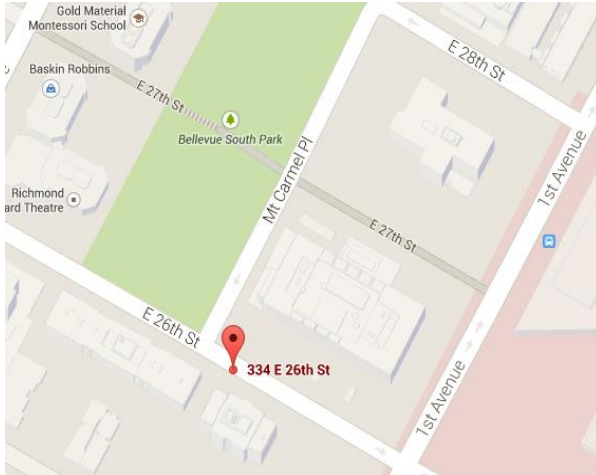

Sidewalk Closures and Walkways: NYC

1715 Broadway

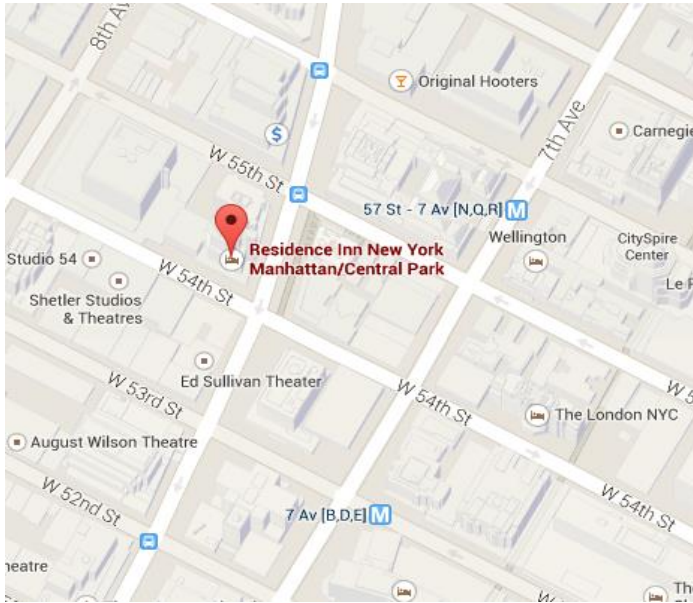

Sidewalk Closures and Walkways: NYC

400 Park Ave S

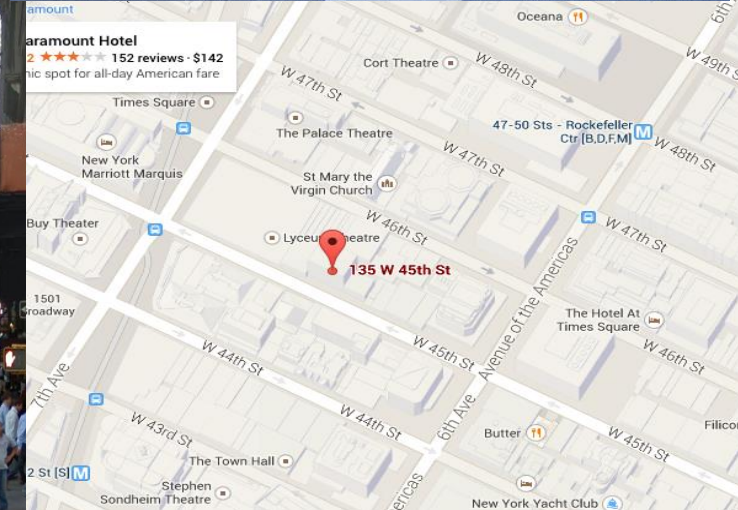
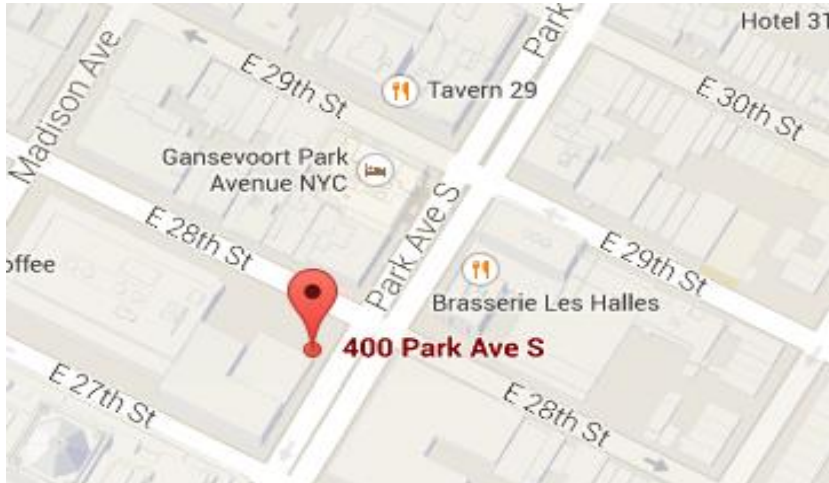

135 w 45th St

2013: The Seattle Construction Boom

Multiple projects occur simultaneously

Creation of Construction Hub program and Access Seattle

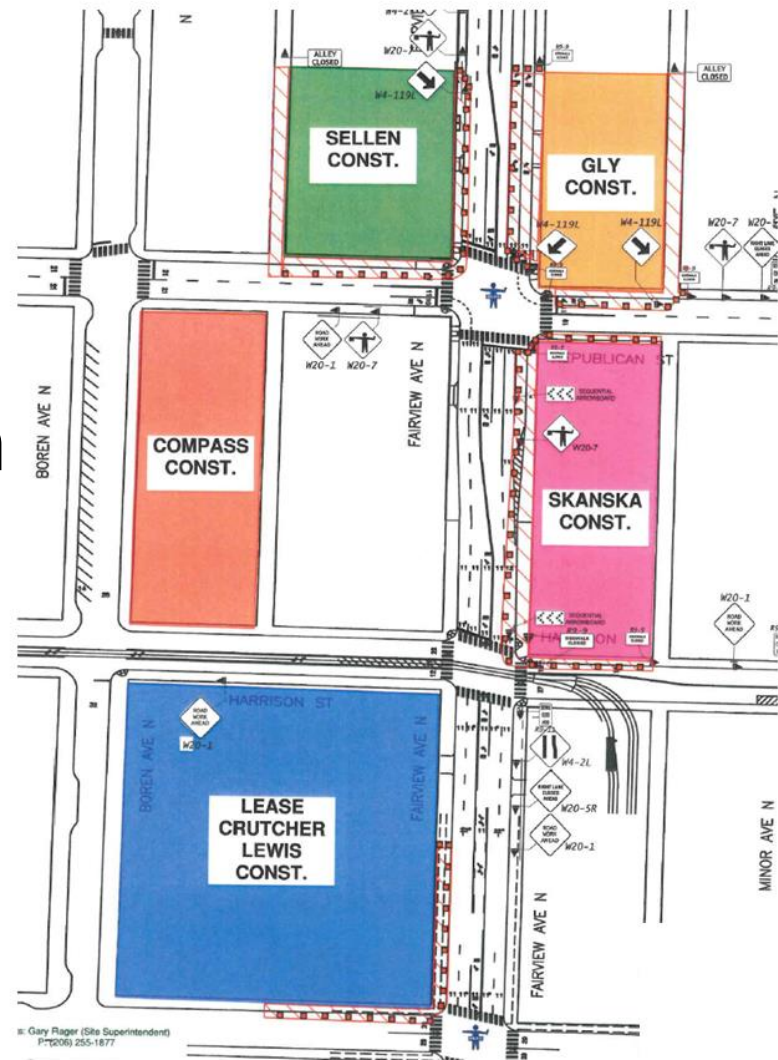

2014: The Seattle Construction Boom

1. Projects in construction
2. Projects about to break ground
3. Projects in early DPD permitting
4. New projects

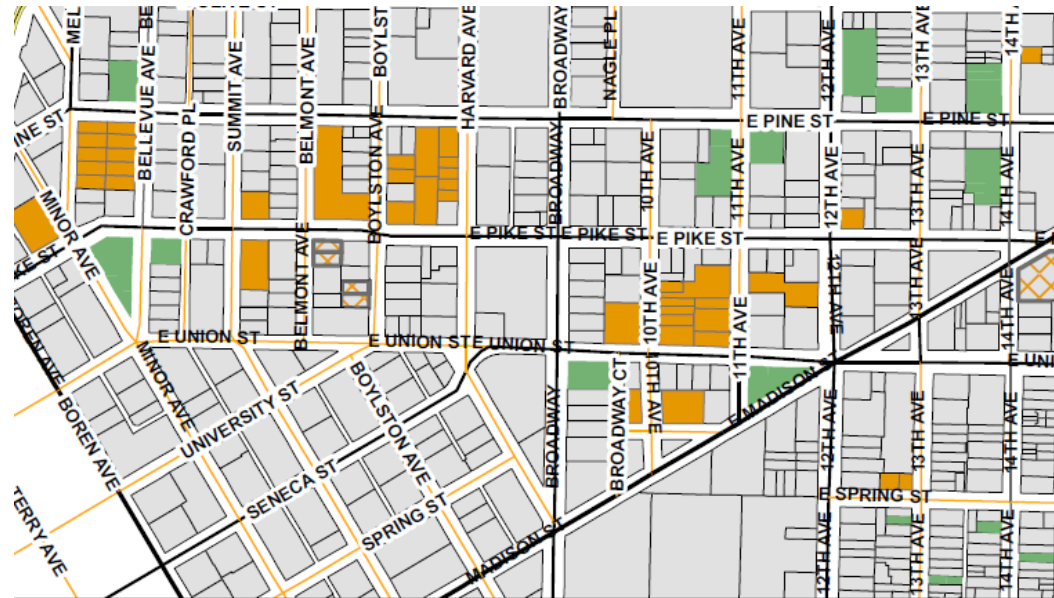

Capitol Hill
Development Status

As of Nov 19, 2014

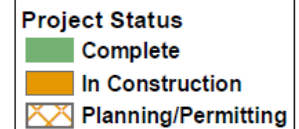

Access Seattle Accomplishments

- Creation of an Applicant Services Team
- Early-Phase *Construction Management Plan* review
- Creation of a single point of contact at SDOT
- Addition of weekly coordination meetings
- Addition of a business development manager
- Peak load inspection contractors



Maps and Schedules

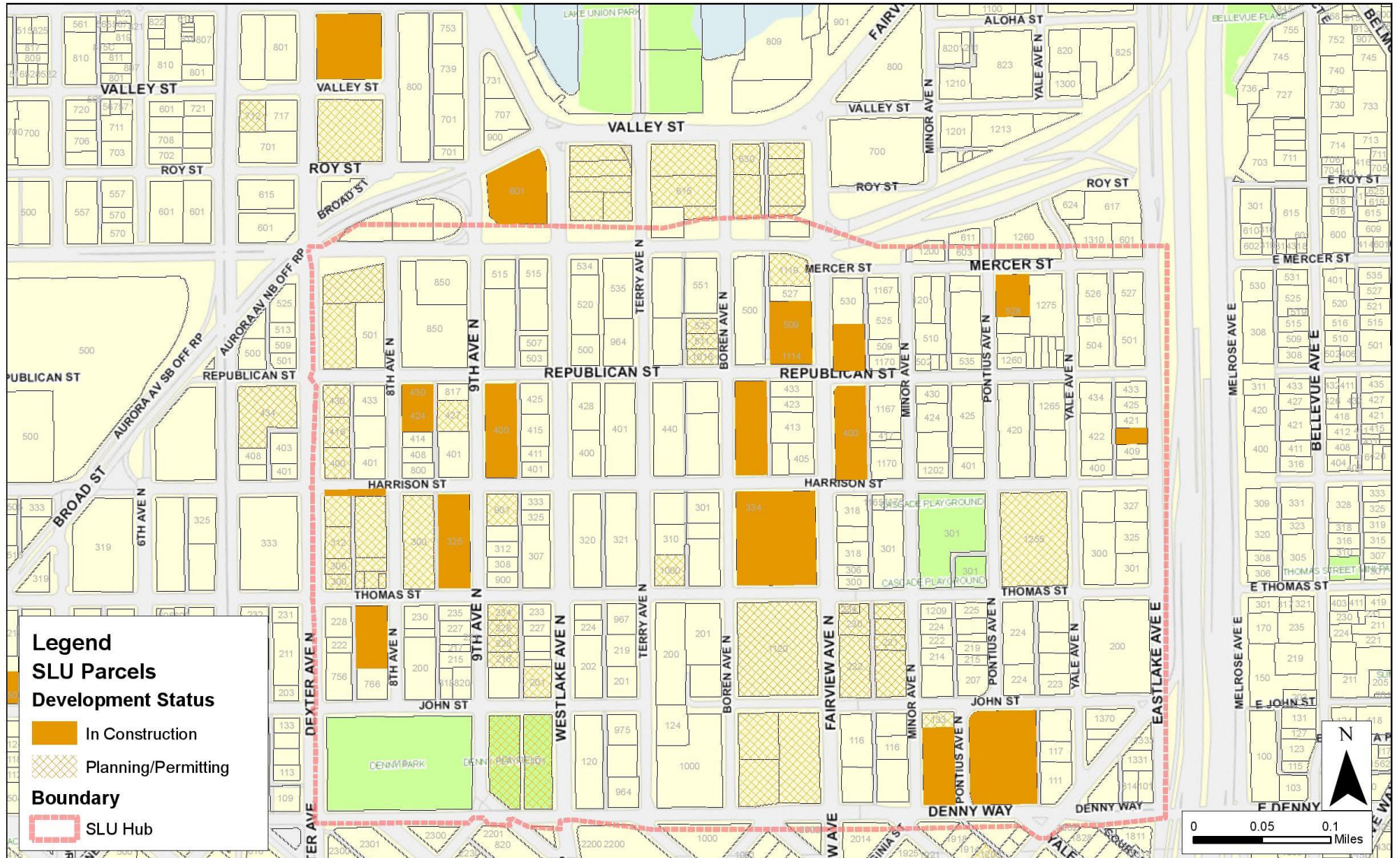

Pedestrian Access in Seattle



Harrison @ 9th Ave N



Concrete Jersey Barriers with 6' fence

Pedestrian Access in Seattle



Seattle: Current Gaps

- Projects on multiple high priority Streets
- Mid-block construction
- Low priority streets are “automatically” used for staging
- Not fully integrated with DPD processes
- Too much flexibility over covered walkways and other ped protections
- Swift and certain enforcement



Q1 2015: Standardize Pedestrian Protection



Q1: Signage and Wayfinding

- Improve wayfinding to businesses and neighborhood amenities
- Provide clear information about project status and timelines



Q2 Public-Private Partnerships

- Develop *Construction Support Toolkit* for businesses
- Identify the appropriate mitigation strategies in various construction hubs
- Stakeholders from various construction hubs



Next Steps—3 Month Push

Now	Conduct an internal review of projects
January 2015	Identify standard barriers and signage for pedestrian routes
February 2015	Address bad actors: progressive enforcement protocols
March 2015	Identify when walkways can be provided on side streets and for mid-block projects
March 2015	Establish policy for contractor parking
April 2015	Update DR 1-2011 to reflect findings
June 2015	Full integration of <i>Construction Management Plans</i> into DPD process

Questions?

[http://www.seattle.gov/transportation/
Brian.dePlace@Seattle.Gov](http://www.seattle.gov/transportation/Brian.dePlace@Seattle.Gov)

<http://www.seattle.gov/transportation>

