

New Lowrise Multifamily Zoning

- Lowrise Duplex/Triplex (LDT) rezoned to Lowrise 1 (LR1)
- Lowrise 1 (L1) outside of growth areas* rezoned to Lowrise 1 (LR1)
- Lowrise 1 (L1) inside of growth areas* rezoned to Lowrise 2 (LR2)
- Lowrise 2 (L2) rezoned to Lowrise 2 (LR2)
- Lowrise 3 (L3) rezoned to Lowrise 3 (LR3)
- Lowrise 4 (L4) rezoned to Lowrise 3 (LR3)

*Growth areas are urban centers, urban villages, and Station Area Overlay Districts

No warranties of any sort, including accuracy, fitness, or merchantability accompany this product.

- Area contains an existing Property Use and Development Agreement

Map number: 44

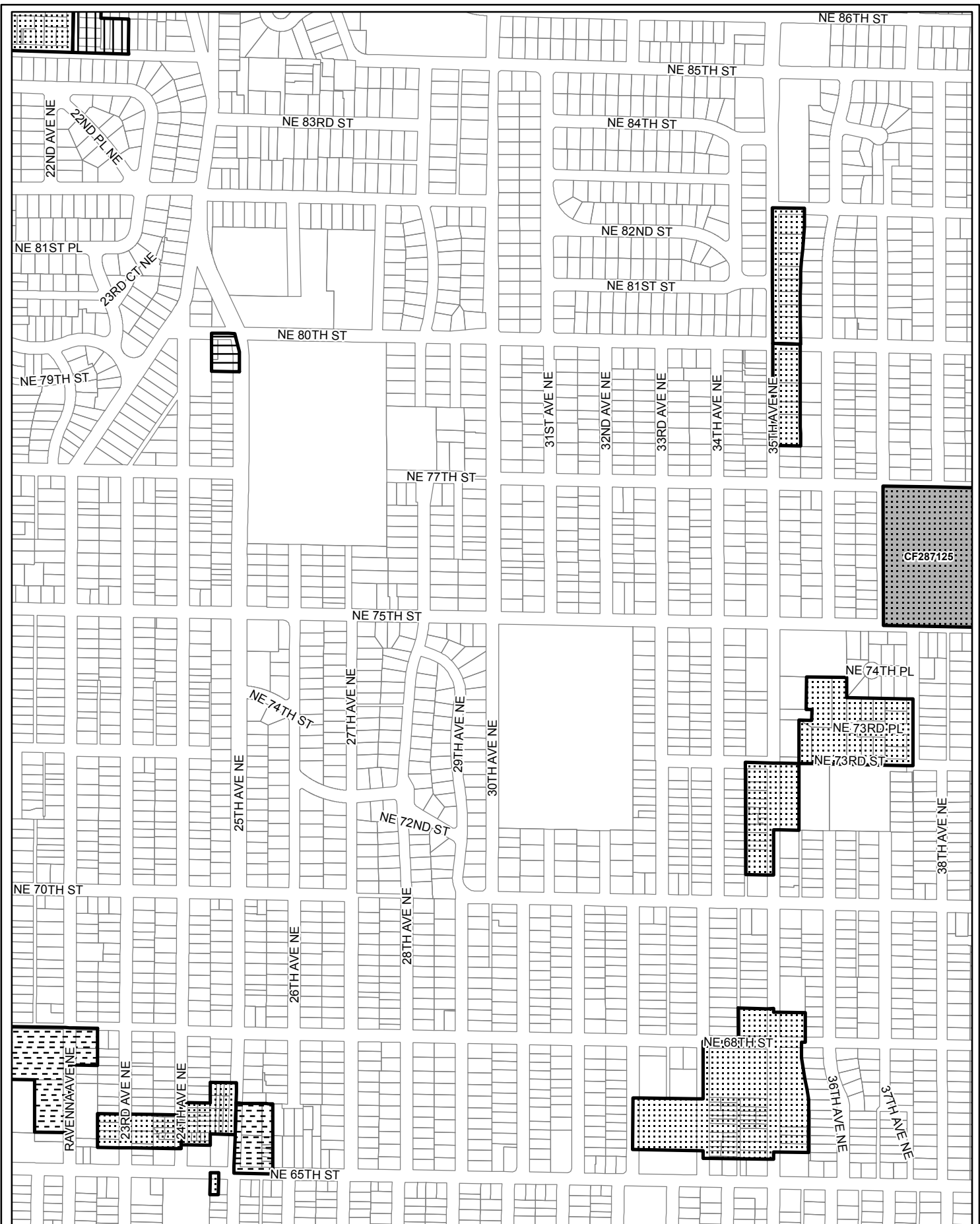

New Lowrise Multifamily Zoning

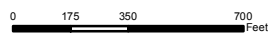

Map number: 45

- Lowrise Duplex/Triplex (LDT) rezoned to Lowrise 1 (LR1)
- Lowrise 1 (L1) outside of growth areas* rezoned to Lowrise 1 (LR1)
- Lowrise 1 (L1) inside of growth areas* rezoned to Lowrise 2 (LR2)
- Lowrise 2 (L2) rezoned to Lowrise 2 (LR2)
- Lowrise 3 (L3) rezoned to Lowrise 3 (LR3)
- Lowrise 4 (L4) rezoned to Lowrise 3 (LR3)

*Growth areas are urban centers, urban villages, and Station Area Overlay Districts

No warranties of any sort, including accuracy, fitness, or merchantability accompany this product.

Area contains an existing Property Use and Development Agreement

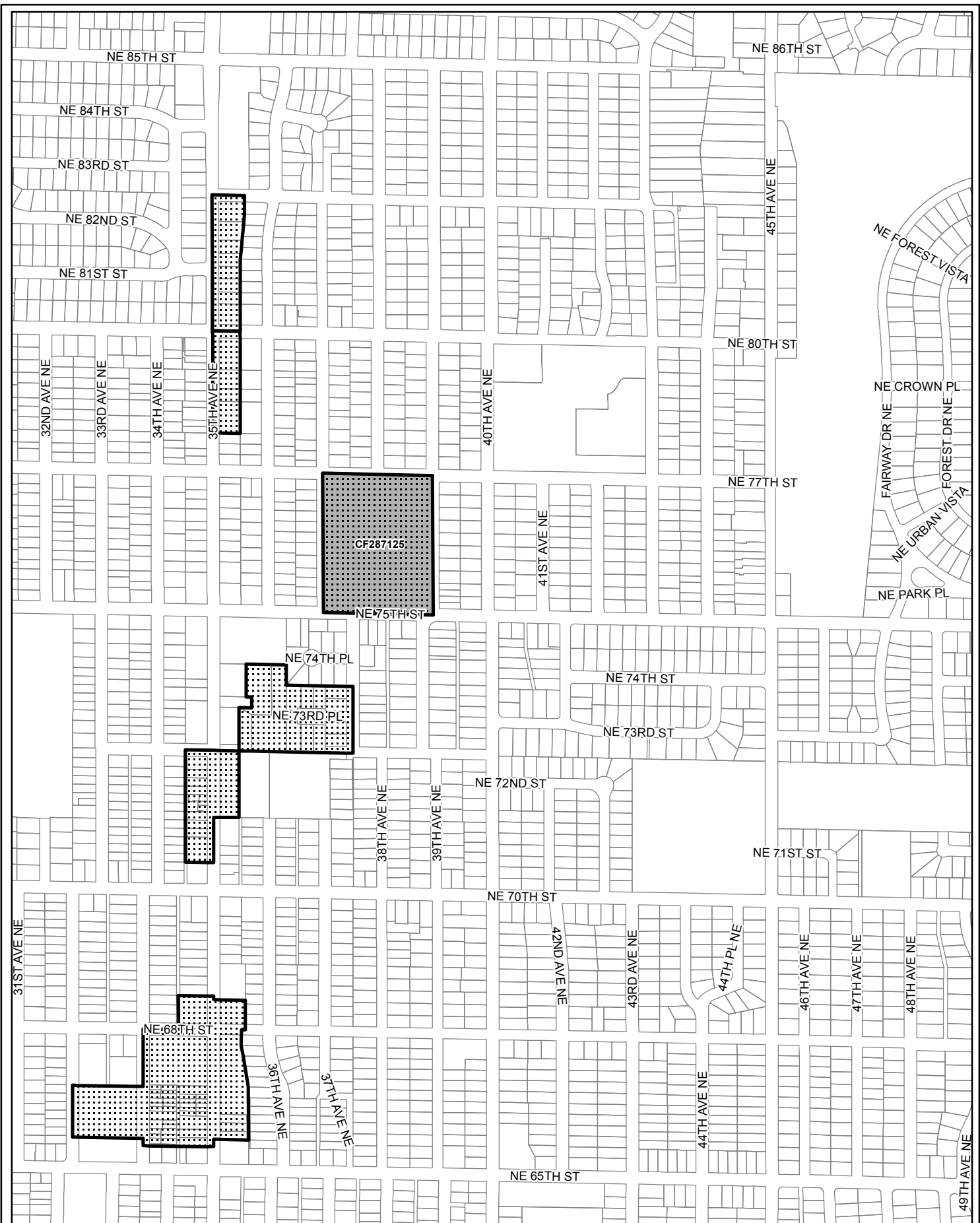

New Lowrise Multifamily Zoning

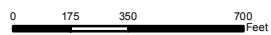

Map number: 46

- Lowrise Duplex/Triplex (LDT) rezoned to Lowrise 1 (LR1)
- Lowrise 1 (L1) outside of growth areas* rezoned to Lowrise 1 (LR1)
- Lowrise 1 (L1) inside of growth areas* rezoned to Lowrise 2 (LR2)
- Lowrise 2 (L2) rezoned to Lowrise 2 (LR2)
- Lowrise 3 (L3) rezoned to Lowrise 3 (LR3)
- Lowrise 4 (L4) rezoned to Lowrise 3 (LR3)

*Growth areas are urban centers, urban villages, and Station Area Overlay Districts

No warranties of any sort, including accuracy, fitness, or merchantability accompany this product.

Area contains an existing Property Use and Development Agreement

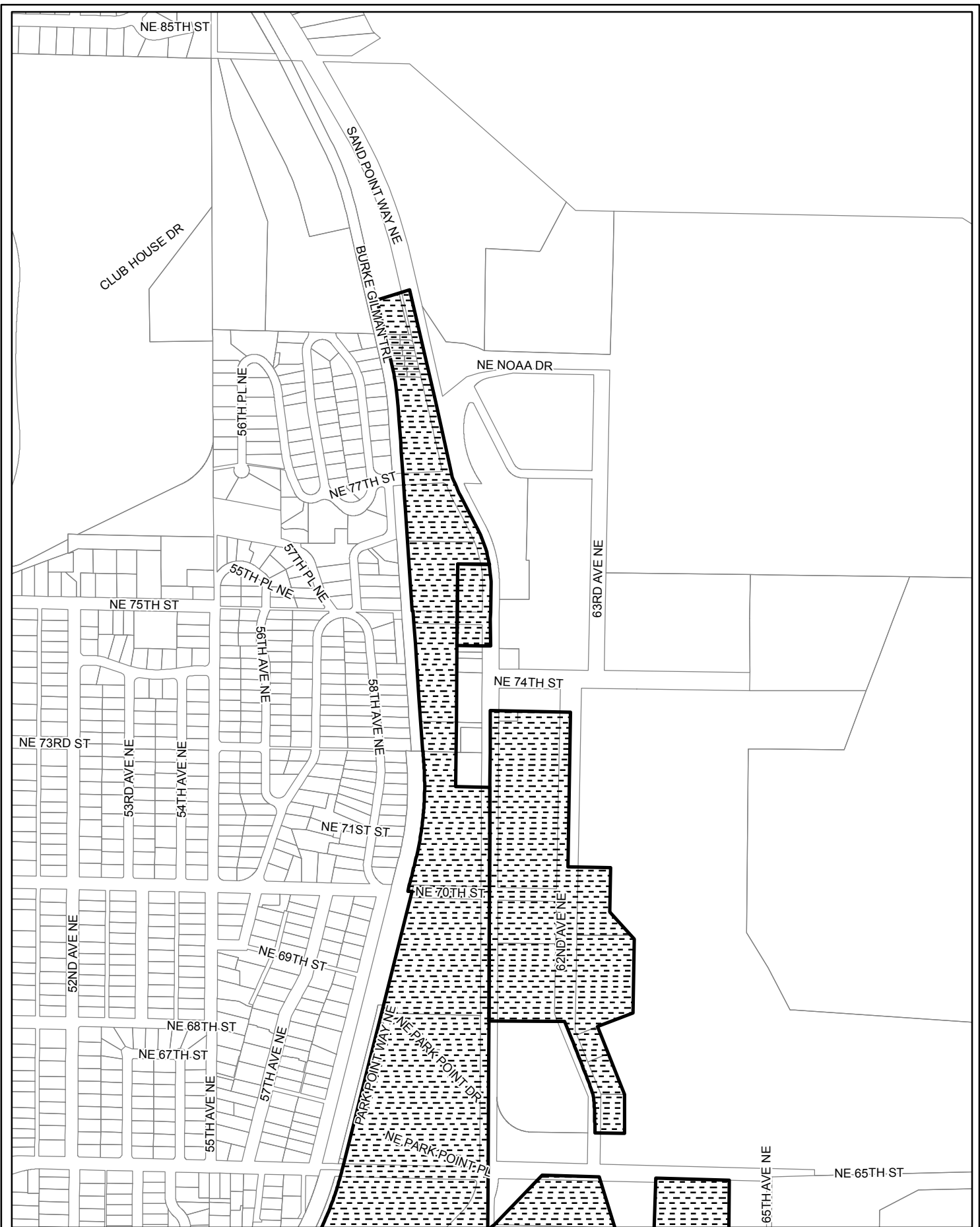

New Lowrise Multifamily Zoning

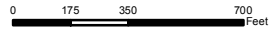

Map number: 48

- Lowrise Duplex/Triplex (LDT) rezoned to Lowrise 1 (LR1)
- Lowrise 1 (L1) outside of growth areas* rezoned to Lowrise 1 (LR1)
- Lowrise 1 (L1) inside of growth areas* rezoned to Lowrise 2 (LR2)
- Lowrise 2 (L2) rezoned to Lowrise 2 (LR2)
- Lowrise 3 (L3) rezoned to Lowrise 3 (LR3)
- Lowrise 4 (L4) rezoned to Lowrise 3 (LR3)

*Growth areas are urban centers, urban villages, and Station Area Overlay Districts

No warranties of any sort, including accuracy, fitness, or merchantability accompany this product.

- Lowrise 3 (LR3) rezoned to Lowrise 3 (LR3)
- Area contains an existing Property Use and Development Agreement