

Ordinance No. 122503

Council Bill No. 115951

AN ORDINANCE relating to real property known as Discovery Park and the laying off of portions of the park roadways within Discovery Park known as Utah Street, Washington Avenue, California Avenue, Iowa Street, Lawtonwood Road, Illinois Avenue, Texas Way, Bay Terrace Road, Idaho Avenue and 45th Avenue West, as public park boulevards; amending Appendices I and II to Ordinance 117569 and to Title 15 of the Seattle Municipal Code (Description and Maps of Park Drives and Boulevards); and naming the portions of Washington Avenue and Utah Street so laid off as Discovery Park Boulevard.

The City of Seattle - Legislative Department

Council Bill/Ordinance sponsored by: DELLA

Councilmember

Committee Action:

CF No. _____

Date Introduced: <u>7-30-07</u>	
Date 1st Referred: <u>7-30-07</u>	To: (committee) <u>PARKS, EDUCATION AND LABOR</u>
Date Re - Referred:	To: (committee)
Date Re - Referred:	To: (committee)
Date of Final Passage: <u>9-24-07</u>	Full Council Vote: <u>7-0</u>
Date Presented to Mayor: <u>9-25-07</u>	Date Approved: <u>10-3-07</u>
Date Returned to City Clerk: <u>10-4-07</u>	Date Published: <u>19</u> T.O. <input checked="" type="checkbox"/> F.T. <input checked="" type="checkbox"/>
Date Vetoed by Mayor:	Date Veto Published:
Date Passed Over Veto:	Veto Sustained:

9/19/07 VLA = DD, RE, JD

Nay = 0

DF

9-24-07 Passed 7-0 (EXCLUDED: LICATA, McIVER)

This file is complete and ready for presentation to Full Council. Committee: _____ (initial/date)

Law Department

Law Dept. Review

OMP Review

City Clerk Review

Electronic Copy Loaded

Indexed



City of Seattle

Gregory J. Nickels, Mayor

Office of the Mayor

July 17, 2007

Honorable Nick Licata
President
Seattle City Council
City Hall, 2nd Floor

Dear Council President Licata:

I am transmitting the attached proposed Council Bill that changes the designation of several of Discovery Park's roadways to Park Boulevards. In addition, the proposed legislation designates and renames the roadway known as "Utah Street," and part of the roadway known as "Washington Avenue," to "Discovery Park Boulevard." This proposed Council Bill will provide public access to historic homes that will be in private ownership when the Navy vacates the Park, legal access to private homeowners in the Lawtonwood/Bay Terrace communities, and access for transportation and utility purposes.

Park Boulevards serve as public rights of way for transportation and utilities purposes as well as for park purposes. Designating the roadways described in this legislation as Park Boulevards provides the same legal status as public streets, while preserving them in the Department of Parks and Recreation's jurisdiction. Passage of this legislation will result in the newly-designated boulevards being jointly maintained by Seattle Department of Parks and Recreation, Seattle Department of Transportation, and Seattle Public Utilities.

Thank you for your consideration of this legislation. Should you have questions, please contact Terry Dunning at 684-4860.

Sincerely,

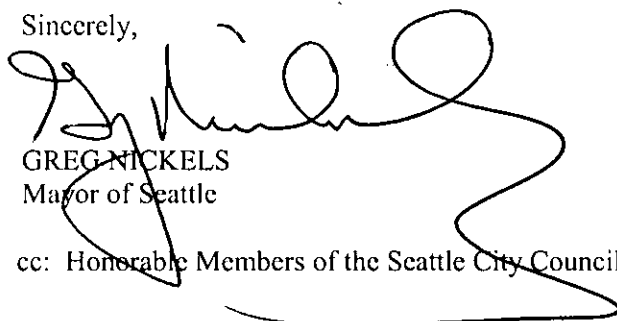
A large, stylized handwritten signature in black ink, which appears to be "Greg Nickels".

GREG NICKELS
Mayor of Seattle

cc: Honorable Members of the Seattle City Council

600 Fourth Avenue, 7th Floor, P.O. Box 94749, Seattle, WA 98124-4749

Tel: (206) 684-4000, TDD: (206) 684-8811 Fax: (206) 684-5360, Email: mayors.office@seattle.gov

An equal employment opportunity, affirmative action employer. Accommodations for people with disabilities provided upon request.



ORDINANCE 122503

AN ORDINANCE relating to real property known as Discovery Park and the laying off of portions of the park roadways within Discovery Park known as Utah Street, Washington Avenue, California Avenue, Iowa Street, Lawtonwood Road, Illinois Avenue, Texas Way, Bay Terrace Road, Idaho Avenue and 45th Avenue West, as public park boulevards; amending Appendices I and II to Ordinance 117569 and to Title 15 of the Seattle Municipal Code (Description and Maps of Park Drives and Boulevards); and naming the portions of Washington Avenue and Utah Street so laid off as Discovery Park Boulevard.

WHEREAS, owners of private properties abutting several of the rights of way in Discovery Park require access across the rights of way for utility purposes or ingress and egress to adjacent private properties; and

WHEREAS, the rights of private property owners will be preserved if the street rights of way are characterized as Park Boulevards; and

WHEREAS, designation as a Park Boulevard provides for uses for transportation and utility purposes; and

WHEREAS, public safety will be enhanced within Discovery Park as traffic codes and regulations are fully enforceable on Park Boulevards as they are on City of Seattle streets, but not necessarily on park roads which are considered "private"; and

WHEREAS, the proposed designation will cause the newly designated boulevards to be part of the joint maintenance responsibilities (to the extent required) by the Seattle Department of Parks and Recreation ("DPR"), Seattle Department of Transportation, and Seattle Public Utilities; and

WHEREAS, Park Boulevards are under the jurisdiction of DPR and thus are consistent with covenants made with the grantors of the property, the United States, requiring that the lands of Discovery Park be maintained in perpetuity for park purposes;
NOW, THEREFORE,

BE IT ORDAINED BY THE CITY OF SEATTLE AS FOLLOWS:

Section 1. The portions of the park roadways known as Utah Street, Washington Avenue, California Avenue, Iowa Street, Lawtonwood Road, Illinois Avenue, Texas Way, Bay Terrace



Terry Dunning
DPR Discovery Park Boulevards ORD
June 4, 2007
Version #2

1 Road, Idaho Avenue and 45th Avenue West (the ""Designated Portions""), described as follows
2 are hereby designated as Park Boulevards, as defined in SMC 15.02.046 and RCW 35.21.190:
3

4
5 Description of Discovery Park Road known as
6 Washington Avenue

7 From 36th Ave W to Discovery Park Road known as California Avenue

8 A 40 foot strip of land in the NE¼ and the NW¼ of Section 15, Township 25 North, Range 3
9 East, Willamette Meridian in the City of Seattle, King County, Washington, lying 20 feet on each
10 side of the following described line:

11 Commencing at a tack and lead 7.33 feet north of a concrete monument in case marking the
12 intersection of the centerlines of 36th Avenue West and West Government Way, thence S
13 1°17'29" W along the centerline of 36th Avenue West a distance of 9.25 feet, thence S 88°44'15"
14 W a distance of 30.03 feet to the intersection with Discovery Park boundary and the True Point
15 of Beginning;

16 Thence continuing S 88°44'15" W a distance of 185.88 feet to the beginning of a curve to the
17 right, being concave to the north,

18 Thence westerly and northerly along said curve, having a radial bearing of N 1°15'45" W a
19 radius of 410.00 feet, a central angle of 50°16'52" an arc distance of 359.80 feet to a point of
20 tangency,

21 Thence N 40°58'33" W a distance of 554.29 feet to the beginning of a curve to the left, being
22 concave to the south,

23 Thence northerly and westerly along said curve, having a radial bearing of S49°01'07"W, a
24 radius of 500.00 feet, a central angle of 40°22'34" an arc distance of 352.35 feet to the
25 intersection with Illinois Avenue to the north, designated here as "V",
26



1 Thence continuing westerly along said curve through an additional central angle of 7°01'46" an
2 arc distance of 61.34 feet to a point of tangency,
3 Thence N 88°23'13" W a distance of 539.11 feet to the beginning of a curve to the right, being
4 concave to the south,
5 Thence westerly and southerly along said curve, having a radial bearing of S 1°36'47" W, a
6 radius of 540.00 feet, a central angle of 26°51'24" an arc distance of 253.12 feet to a point of
7 tangency,
8 Thence S 64°45'23" W a distance of 52.43 feet to the intersection with California Avenue to the
9 south, designated here as "C",
10 Thence continuing S 64°45'23" W a distance of 49.54 feet to a point bearing S22°06'01"E and
11 20.03 feet distant from a concrete monument marked USN-WN-3 and the terminus of this
12 description,
13 Sidelines at the point of beginning and at the terminus to be extended or shortened to their
14 intersections with crossing lines.

15
16
17
18 Description of Discovery Park Road known as
19 California Avenue
20 From Washington Avenue to Iowa Street
21

22 A variable width strip of land in the NW¼ of Section 15, Township 25 North, Range 3 East,
23 Willamette Meridian in the City of Seattle, King County, Washington, the westerly margin of
24 which abuts and is contiguous with the easterly boundaries of the parcels known as Washington
25
26
27



1 Housing North, NOAA, and Washington Housing South, and the easterly margin lays 15 feet on
2 the easterly side of the following described line:

3 Commencing at the intersection of California Avenue and Washington Avenue designated "C" in
4 the Washington Avenue description,

5 Thence S 18°55'38" E a distance of 20.12 feet to the southerly margin of Washington Avenue
6 and the True Point of Beginning;

7 Thence continuing S 18°55'38" E a distance of 242.25 feet to the beginning of a curve to the
8 right, being concave to the west,

9 Thence southerly along said curve, having a radial bearing of S 71° 04'22" W, a radius of 412.00
10 feet, a central angle of 20°16'04" an arc distance of 145.74 feet, to a point of tangency,

11 Thence S 1°20'26" W a distance of 899.58 feet to the intersection with Iowa Street to the
12 southwest, designated here as "IO",

13 Thence continuing S 1°20'26" W a distance of 16.47 feet to the terminus of this described line.

14 The easterly side line at the southerly margin of Washington Avenue and at the southerly margin
15 of Iowa Street to be extended or shortened to its intersection with said crossing lines.

16 The westerly margin is more particularly described as:

17 Commencing at the intersection of the easterly boundary of a parcel of land known as
18 Washington Housing North and the centerline terminus of Washington Avenue,

19 Thence S 22°06'01" E along said easterly boundary of Washington Housing North a distance of
20 362.69 feet to a concrete monument with brass disk designated USN-WN-4,

21 Thence leaving the boundary of Washington Housing North S 8°45'58" W a distance of 155.49
22 feet to a concrete monument with brass disk designated USN-WN-7,

23 Thence along the boundary of Washington Housing North S 1°50'21" W a distance of 173.61
24 feet to a concrete monument with brass disk designated USN-WN-8,

1 Thence along the boundary of a parcel of land known as NOAA S 1°20'51" W a distance of
2 143.74 feet to a concrete monument with brass disk designated NOAA #4,
3 Thence leaving the boundary of NOAA S 1°10'09" W a distance of 194.82 feet to a concrete
4 monument with brass disk designated USN-WS-4 marking the northeasterly corner of a parcel of
5 land known as Washington Housing South,
6 Thence along the boundary of Washington Housing South S 1°15'25" W a distance of 267.94
7 feet to a concrete monument with brass disk designated USN-WS-5 and the intersection with the
8 northerly margin of Iowa Street.

9
10
11
12 Description of Discovery Park Road known as
13 Iowa Street
14 From California Avenue to Washington Avenue
15

16 A 30 foot strip of land in the NW¼ of Section 15, Township 25 North, Range 3 East, Willamette
17 Meridian in the City of Seattle, King County, Washington, lying 15 feet on each side of the
18 following described line:
19 Commencing at the intersection of California Avenue and Iowa Street designated "IO" in the
20 California Avenue description, thence S 66°16'52" W a distance of 40.88 feet to the westerly
21 margin of California Avenue extended and the True Point of Beginning:
22 Thence continuing S 66°16'52" West a distance of 217.74 feet to the terminus of this description.
23 Said point lying S 23°43'08" E and 15.00 feet distant from a concrete monument designated as
24 USN-WS-1.
25
26
27
28



1 Sideline at the easterly margin of California Avenue to be extended or shortened to the
2 intersection with said crossing line.

3
4
5 Description of Discovery Park Road known as
6 Illinois Avenue
7 From Washington Avenue to Texas Way
8

9 A 40 foot strip of land in the SW¼ of Section 10, Township 25 North, Range 3 East, and in the
10 NE¼ and the NW¼ of Section 15, Township 25 North, Range 3 East, Willamette Meridian in
11 the City of Seattle, King County, Washington, lying 20 feet on each side of the following
12 described line:

13 Commencing at the intersection of Washington Avenue and Illinois Avenue designated "V" in
14 the Washington Avenue description, and the beginning of a curve to the right, being concave to
15 the northeast, thence northerly and westerly along said curve having a radial bearing of N
16 8°38'33" E, a radius of 241.00 feet, a central angle of 19°36'09" an arc distance of 82.45 feet to
17 the northerly margin of Washington Avenue and the True Point of Beginning:

18 Thence continuing along said curve, through an additional central angle of 22°52'26" an arc
19 distance of 96.21 feet to a point of tangency,

20 Thence N 38°52'52" W a distance of 228.13 feet to the intersection with Utah Street to the west,
21 designated here as "U",

22 Thence continuing N 38°52'52" W a distance of 56.10 feet to the beginning of a curve to the
23 right being concave to the east,

24 Thence northerly along said curve, having a radial bearing of N 51°07'08" E, a radius of 212.11
25 feet, a central angle of 24°19'02" an arc distance of 90.02 feet to a point of reverse curvature,

1 Thence northerly along a curve to the left being concave to the west, having a radial bearing of S
2 75°26'10" W, a radius of 7299.31 feet, a central angle of 5°43'20" an arc distance of 729.01 feet
3 to a point of reverse curvature,

4 Thence northerly along a curve to the right being concave to the east, having a radial bearing of
5 N 69°42'49" E, a radius of 336.60 feet, a central angle of 19°06'45" an arc distance of 112.28
6 feet to a point of tangency,

7 Thence N 1°10'26" W a distance of 173.21 feet to the beginning of a curve to the right being
8 concave to the east,

9 Thence northerly along said curve, having a radial bearing of N 88°49'34" E, a radius of 922.50
10 feet, a central angle of 8°19'13" an arc distance of 133.96 feet to a point on the curve designated
11 here as "Z",

12 Thence continuing along said curve through an additional central angle of 9°06'08" an arc
13 distance of 146.55 feet to a point of compound curvature,

14 Thence northerly and easterly along a curve concave to the southeast, having a radial bearing of
15 S73°45'05"E a radius of 63.07 feet, a central angle of 81°23'45" an arc distance of 89.60 feet to
16 an intersection with Texas Way designated here as "T",

17 Thence westerly along a curve concave to the north having a radial bearing of N7°38'11"E, a
18 radius of 352.21 feet, a central angle of 15°30'47" an arc distance of 95.36 feet to a point of
19 reverse curvature,

20 Thence westerly along a curve concave to the south having a radial bearing of S23°08'58"W, a
21 radius of 33.58 feet, a central angle of 30°00'28" an arc distance of 17.59 feet to a point of
22 compound curvature,

23 Thence westerly and southerly along a curve concave to the east, having a radial bearing of S
24 6°51'30" E, a radius of 104.76 feet, a central angle of 95°11'31" an arc distance of 174.05 feet to
25 a point of compound curvature,

1 Thence southerly and easterly along a curve concave to the northeast, having a radial bearing of
2 N 77°56'59" E, a radius of 56.04 feet, a central angle of 42°11'39" an arc distance of 41.27 feet
3 to a point of tangency,

4 Thence S 54°14'40" E a distance of 96.28 feet to a point previously designated at "Z", and the
5 terminus of this description.

6 Sidelines at the northerly margin of Washington Avenue and at the terminus to be extended or
7 shortened to their intersections with crossing lines.

8
9

10 Description of Discovery Park Road known as
11 Utah Street
12 From Illinois Avenue to METRO West Point

13

14 A 36 foot strip of land in Section 9, Section 10, Section 15 and Section 16, Township 25 North,
15 Range 3 East, Willamette Meridian in the City of Seattle, King County, Washington, lying 18
16 feet on each side of the following described line:

17 Commencing at a point on the centerline of Illinois Avenue designated "U" in the Illinois
18 Avenue description, thence S 56°27'15" W a distance of 20.09 feet to the westerly margin of
19 Illinois Avenue and the True Point of Beginning:

20 Thence continuing S 56°27'15" W a distance of 65.29 feet to the beginning of a curve to the right
21 being concave to the north,

22 Thence westerly and northerly along said curve, having a radial bearing of N33°32'45"W, a
23 radius of 65.00 feet, a central angle of 64°45'03" an arc distance of 73.46 feet to a point of
24 tangency,

25
26

27
28



1 Thence N 58°47'42" W a distance of 156.43 feet to the beginning of a curve to the right being
2 concave to the northeast,
3 Thence westerly and northerly along said curve having a radial bearing of N 31°12'18" E, a
4 radius of 220.00 feet, a central angle of 49°41'04" an arc distance of 190.77 feet to a point of
5 tangency,
6 Thence N 9°06'38" W a distance of 97.88 feet to the beginning of a curve to the left being
7 concave to the southwest,
8 Thence northerly and westerly along said curve having a radial bearing of S 80°53'22" W, a radius
9 of 200.00 feet, a central angle of 73°16'58" an arc distance of 255.81 feet to a point of tangency,
10 Thence N 82°23'36" W a distance of 62.83 feet to the beginning of a curve to the left being
11 concave to the south,
12 Thence westerly and southerly along said curve having a radial bearing of S 7°36'24" W, a radius
13 of 408.00 feet, a central angle of 67°50'13" an arc distance of 483.06 feet to a point of tangency,
14 Thence S 29°46'11" W a distance of 304.98 feet to the beginning of a curve to the right being
15 concave to the northwest,
16 Thence southerly and westerly along said curve having a radial bearing of N60°13'49"W, a
17 radius of 110.00 feet, a central angle of 27°26'58" an arc distance of 52.70 feet to the intersection
18 with Idaho Avenue to the north, designated here as "ID",
19 Thence continuing along said curve through an additional central angle of 34°03'02" an arc
20 distance of 65.37 feet to a point of tangency,
21 Thence N 88°43'49" W a distance of 914.95 feet more or less to the easterly boundary of a tract
22 of land known as Capehart Housing,
23 Thence continuing N 88°43'49" W a distance of 98.81 feet to the beginning of a curve to the
24 right being concave to the north,
25
26
27
28



Terry Dunning
DPR Discovery Park Boulevards ORD
June 4, 2007
Version #2

1 Thence westerly and northerly along said curve having a radial bearing of N 1°16'11" E, a radius
2 of 300.00 feet, a central angle of 14°55'31" an arc distance of 78.15 feet to a point of tangency,
3 Thence N 73°48'18" W a distance of 64.65 feet to the beginning of a curve to the right being
4 concave to the northeast,
5 Thence westerly and northerly along said curve having a radial bearing of N 16°11'42" E a radius
6 of 150.00 feet, a central angle of 40°36'18" an arc distance of 106.30 feet to a point of tangency,
7 Thence N 33°12'00" W a distance of 150.21 feet to the beginning of a curve to the left being
8 concave to the southwest,
9 Thence northerly and westerly along said curve having a radial bearing of S56°48'00"W, a radius
10 of 700.00 feet, a central angle of 4°17'14" an arc distance of 52.38 feet to a point of tangency,
11 Thence N 37°29'14" W a distance of 214.70 feet to the beginning of a curve to the left being
12 concave to the southwest,
13 Thence northerly and westerly along said curve having a radial bearing of S52°30'46"W, a radius
14 of 120.00 feet, a central angle of 50°36'40" an arc distance of 106.00 feet to a point of tangency,
15 Thence N 88°05'54" W a distance of 375.09 feet to the beginning of a curve to the left being
16 concave to the southeast,
17 Thence westerly and southerly along said curve having a radial bearing of S1°54'06"W, a radius
18 of 250.00 feet, a central angle of 28°48'36" an arc distance of 125.71 feet to a point of tangency,
19 Thence S 63°05'30" W a distance of 142.19 feet to the beginning of a curve to the right being
20 concave to the northwest,
21 Thence westerly and southerly along said curve having a radial bearing of N26°54'30"W, a
22 radius of 700.00 feet, a central angle of 2°31'19" an arc distance of 30.81 feet to the westerly
23 boundary of a tract of land known as Capehart Housing,
24 Thence continuing along said curve through an additional 2°09'33" an arc distance of 26.38 feet
25 to a point of tangency,
26
27
28



Terry Dunning
DPR Discovery Park Boulevards ORD
June 4, 2007
Version #2

1 Thence S 67°46'22" W a distance of 156.33 feet to the beginning of a curve to the left being
2 concave to the southeast,
3 Thence westerly and southerly along said curve having a radial bearing of S22°13'38"E, a radius
4 of 350.00 feet, a central angle of 24°20'15" an arc distance of 148.67 feet to a point of tangency,
5 Thence S 43°26'07" W a distance of 506.14 feet to the beginning of a curve to the right being
6 concave to the northwest,
7 Thence southerly and westerly along said curve having a radial bearing of N46°33'53"W, a
8 radius of 230.00 feet, a central angle of 86°38'11" an arc distance of 347.78 feet to a point of
9 tangency,
10 Thence N 49°55'42" W a distance of 245.07 feet to the beginning of a curve to the left being
11 concave to the south,
12 Thence westerly along said curve having a radial bearing of S 40°04'18" W, a radius of 220.00
13 feet, a central angle of 69°40'07" an arc distance of 267.51 feet to a point of tangency,
14 Thence S 60°24'11" W a distance of 34.14 feet to the boundary of Discovery Park and METRO
15 West Point, and the terminus of this description.
16 TOGETHER WITH a strip of land northerly of the northerly margin of the above described
17 boulevard area and abutting the most southerly boundary of a parcel of land known as Montana
18 Circle Housing, described as follows:
19 Commencing at a point on the centerline of Utah Street designated "ID" previously in this
20 description, thence southerly and westerly along a curve on the centerline of Utah Street an arc
21 distance of 65.37 feet to a point of tangency, thence N 88°43'49" W a distance of 9.05 feet,
22 thence N 1°16'11" E a distance of 18.00' to the northerly margin of Utah Street and the TPOB of
23 this strip;
24 Thence continuing N 1°16'11" E a distance of 4.20 feet more or less to a capped rebar marked
25 'DEA' at the southeasterly corner of Montana Circle Housing,



1 Thence N 89°05'43" W a distance of 239.68 feet to a capped rebar marked 'DEA' at the
2 southwesterly corner of Montana Circle Housing,
3 Thence S 1°16'11" W a distance of 2.67 feet more or less to the northerly margin of Utah Street,
4 Thence S 88°43'49" E a distance of 239.67 feet to the TPOB and the end of this strip.
5 Sidelines at the initial point of beginning and at the terminus to be extended or shortened to their
6 intersections with crossing lines.

7
8 Description of Discovery Park Road known as
9 Idaho Avenue
10 From Utah Street to 230 Feet Northerly
11

12 A 40 foot strip of land in the NW¼, Section 15, Township 25 North, Range 3 East, Willamette
13 Meridian in the City of Seattle, King County, Washington, lying 20 feet on each side of the
14 following described line:

15 Commencing at a point on the centerline of Utah Street designated "ID" in the Utah Street
16 description, thence N 4°11'23" E a distance of 23.95 feet to the northwesterly margin of Utah
17 Street and the True Point of Beginning:

18 Thence continuing N 4°11'23" E a distance of 206.05 feet to the terminus of this description.
19 Sidelines at the point of beginning to be extended or shortened to their intersections with
20 crossing lines.

21
22
23
24
25
26
27
28



1 Description of Discovery Park Road known as
2 Texas Way
3 From Illinois Avenue to West Lawton St
4

5 A 40 foot strip of land in the SW¼ of Section 10, Township 25 North, Range 3 East, Willamette
6 Meridian in the City of Seattle, King County, Washington, lying 20 feet on each side of the
7 following described line:

8 Commencing at the intersection of Illinois Avenue and Texas Way designated "T" in the Illinois
9 Avenue description, and being the True Point of Beginning:

10 Thence S 82°21'20" E a distance of 57.77 feet to the beginning of a curve to the right being
11 concave to the south,

12 Thence easterly along said curve having a radial bearing of S 7°38'40" W, a radius of 200.00
13 feet, a central angle of 11°12'34" an arc distance of 39.13 feet to a point of tangency,

14 Thence S 71°08'45" E a distance of 191.54 feet to the beginning of a curve to the left being
15 concave to the northwest,

16 Thence easterly and northerly along said curve having a radial bearing of N 18°51'15" E, a radius
17 of 50.00 feet, a central angle of 107°41'33" an arc distance of 93.98 feet to a point of tangency
18 on the centerline of 40th Avenue West extended southerly,

19 Thence N 1°09'42" E along said extension of the centerline of 40th Avenue a distance of 39.31
20 feet to the intersection of Lawtonwood Road, designated here as "L",

21 Thence continuing N 1°09'42" E a distance of 51.17 feet more or less to the intersection with
22 Discovery Park boundary (southerly margin of West Lawton Street) and the terminus of this
23 description.

24 Sidelines at the beginning and at the terminus to be extended or shortened to their intersections
25 with crossing lines.
26

1 Description of Discovery Park Road known as
2 Lawtonwood Road
3 From 40th Avenue West to West Cramer Street
4

5 A 40 foot strip of land in the SW¼ and the NW¼ of Section 10, Township 25 North, Range 3
6 East, Willamette Meridian in the City of Seattle, King County, Washington, lying 20 feet on each
7 side of the following described line:

8 Commencing at a concrete monument in case marking the intersection of the centerlines of West
9 Commodore Street and 40th Avenue West, thence S 1°09'42" W along the centerline of 40th
10 Avenue West a distance of 455.57 feet to the Discovery Park boundary (southerly margin West
11 Lawton Street), thence continuing S 1°09'42" W a distance of 51.17 feet to the intersection with
12 Lawtonwood Road to the northwest designated "L" in the Texas Way description, thence N
13 41°52'56" W a distance of 29.30 feet to the westerly margin of Texas Way and the True Point of
14 Beginning:

15 Thence continuing N 41°52'56" W a distance of 176.82 feet to an intersection with a Discovery
16 Park road to the north, known as Bay Terrace Road, designated here as "BT",

17 Thence continuing N 41°52'56" W a distance of 130.51 feet to the beginning of a curve to the
18 right, being concave to the northeast,

19 Thence northerly and westerly along said curve having a radial bearing of N48°07'04"E, a radius
20 of 169.30 feet, a central angle of 17°31'40" an arc distance of 51.79 feet to a point of tangency,

21 Thence N 24°21'16 W a distance of 273.31 feet to the beginning of a curve to the left, being
22 concave to the southwest,

23 Thence northerly and westerly along said curve having a radial bearing of S65°38'44"W, a radius
24 of 379.75 feet, a central angle of 3°17'42" an arc distance of 21.84 feet to a point of tangency,
25
26
27
28



Terry Dunning
DPR Discovery Park Boulevards ORD
June 4, 2007
Version #2

1 Thence N 27°38'57" W a distance of 148.91 feet to the beginning of a curve to the right being
2 concave to the northeast,
3 Thence northerly and westerly along said curve having a radial bearing of N62°21'03"E,
4 a radius of 425.89 feet, a central angle of 7°50'39" an arc distance of 58.31 feet to a point of
5 tangency,
6 Thence N 19°48'18" W a distance of 109.47 feet to the beginning of a curve to the left being
7 concave to the southwest,
8 Thence northerly and westerly along said curve having a radial bearing of S70°11'42"W, a radius
9 of 345.05 feet, a central angle of 8°42'20" an arc distance of 52.43 feet to a point of tangency,
10 Thence N 28°30'38" W a distance of 78.78 feet to the beginning of a curve to the left being
11 concave to the southwest,
12 Thence northerly and westerly along said curve having a radial bearing of S61°29'22"W, a radius
13 of 403.00 feet, a central angle of 8°04'12" an arc distance of 56.76 feet to a point of tangency,
14 Thence N 36°34'50" W a distance of 87.89 feet to the beginning of a curve to the right being
15 concave to the northeast,
16 Thence northerly and westerly along said curve having a radial bearing of N53°25'10"E, a radius
17 of 1143.00 feet, a central angle of 4°17'55" an arc distance of 85.75 feet to a point of tangency,
18 Thence N 32°16'55" W a distance of 125.35 feet to the beginning of a curve to the left being
19 concave to the southwest,
20 Thence northerly and westerly along said curve having a radial bearing of S57°43'05"W, a radius
21 of 783.17 feet, a central angle of 3°59'37" an arc distance of 54.59 feet to a point of tangency,
22 Thence N 36°16'32' W a distance of 40.23 feet to the southerly margin of a 30 foot street right of
23 way established by Act of Congress, May 2, 1908 and known as West Cramer Street,
24 Thence continuing N 36°16'32" W a distance of 38.25 feet to the northerly margin of West
25 Cramer Street,
26
27
28



1 Thence continuing N $36^{\circ}16'32''$ W a distance of 197.98 feet to the intersection with a line 20 feet
2 southeast of and parallel with the Discovery Park boundary line, designated here as "A",
3 Thence S $60^{\circ}14'54''$ W along said line 20 feet southeast and parallel with the Discovery Park
4 boundary line a distance of 304.03 feet to the intersection with the north line of said West
5 Cramer Street as established by Act of Congress on May 2, 1908 and the terminus of this
6 description.
7 Sidelines at the point of beginning and at the south and north margins of West Cramer Street to
8 be extended or shortened to their intersections with crossing lines.

9
10
11 Description of Discovery Park Road known as
12 45th Avenue West
13 from Lawtonwood Road to the Government Meanderline
14

15 A 60 foot strip of land in the NW $\frac{1}{4}$ of Section 10, Township 25 North, Range 3 East, Willamette
16 Meridian in the City of Seattle, King County, Washington, lying 30 feet on each side of the
17 following described line:

18 Commencing at a point designated as "A" in the Lawtonwood Road description, thence
19 S $36^{\circ}16'32''$ E a distance of 10.07 feet to the intersection with a line 30 feet southeast of and
20 parallel with the Discovery Park boundary line, and the beginning of a curve to the left, concave
21 to the west, thence along said curve having a radial bearing of N $30^{\circ}05'03''$ W, a radius of
22 230.00 feet, a central angle of $4^{\circ}59'39''$ an arc distance of 20.05 feet to the northeasterly margin
23 of Lawtonwood Road and the True Point of Beginning:

24 Thence continuing along said curve through an additional central angle of $53^{\circ}50'25''$ an arc
25 distance of 216.13 feet to a point of tangency,
26
27
28



1 Thence N 1°04'54" E a distance of 656.40 feet more or less to the Government Meander Line
2 and the terminus of this description.

3 Sidelines at the point of beginning and at the Government Meander Line to be extended or
4 shortened to their intersections with crossing lines.

5
6 Description of Discovery Park Road known as

7 Bay Terrace Road

8 From Lawtonwood Road to West Cramer Street

9
10 A 40 foot strip of land in the SW¼ of Section 10, Township 25 North, Range 3 East, Willamette
11 Meridian in the City of Seattle, King County, Washington, lying 20 feet on each side of the
12 following described line:

13 Commencing at a point on the centerline of Lawtonwood Road designated "BT" in the
14 Lawtonwood Road description, thence N 8°57'22" E a distance of 25.79 feet to the northerly
15 margin of Lawtonwood Road and the True Point of Beginning:

16 Thence continuing N 8°57'22" E a distance of 22.10 feet to the beginning of a curve to the left
17 being concave to the west,

18 Thence northerly along said curve having a radial bearing of N 81°02'38" W, a radius of 653.50
19 feet, a central angle of 28°27'39" an arc distance of 324.62 feet to a point of reverse curvature,

20 Thence northerly along a curve to the right concave to the east having a radial bearing of
21 N70°29'43"E, a radius of 1280.25 feet, a central angle of 15°16'11" an arc distance of 341.20
22 feet to a point of compound curvature,

23 Thence northerly along a curve to the right concave to the east having a radial bearing of
24 N85°45'54"E, a radius of 1096.22 feet, a central angle of 22°53'48" an arc distance of 438.07
25 feet to a point of reverse curvature,

1 Thence northerly along a curve to the left concave to the west, having a radial bearing of N
2 71°20'18" W, a radius of 104.83 feet, a central angle of 21°39'32" an arc distance of 39.63 feet
3 to a point of tangency on the centerline of 42nd Avenue West extended southerly,
4 Thence N 2°59'50" W along said extension of 42nd Avenue West a distance of 1.00 feet more or
5 less to the boundary of Discovery Park and the terminus of this description.
6 Sidelines at the point of beginning and at the terminus to be extended or shortened to their
7 intersections with crossing lines.

8
9 Section 2. Appendix I to Ordinance 117569 and to Title 15 of the Seattle Municipal
10 Code (Description and Maps of Park Drives and Boulevards) is hereby amended to include the
11 laid off boulevards described above, and the code reviser is directed to add them to Appendix I.

12
13 Section 3. Appendix II, Corresponding Maps of Park Drives and Boulevards, to Title
14 15 of the Seattle Municipal Code and to Ordinance 117569, is hereby amended by the addition of
15 the maps, attached to this ordinance as Attachment A, depicting the Designated Portions as Park
16 Boulevards. In the event of conflict between the maps in Attachment A and the descriptions in
17 Section 1 of this Ordinance, the descriptions in Section 1 shall control.

18
19 Section 4. Those portions of Washington Avenue and Utah Street laid off as Park
20 Boulevards shall be named "Discovery Park Boulevard" and shall be signed accordingly.



1 Section 5. This ordinance shall take effect and be in force thirty (30) days from and after
2 its approval by the Mayor, but if not approved and returned by the Mayor within ten (10) days
3 after presentation, it shall take effect as provided by Municipal Code Section 1.04.020.

4 Passed by the City Council the 24th day of September 2007, and signed by me in open
5 session in authentication of its passage this 24th day of September 2007.

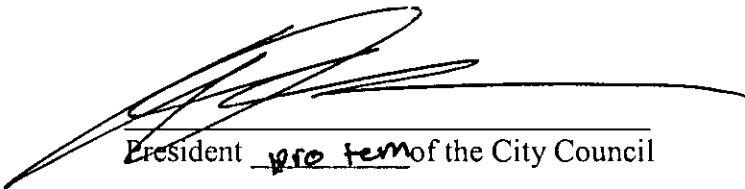
7
8
9 
President pro tem of the City Council

10 Approved by me this 3 day of October, 2007.

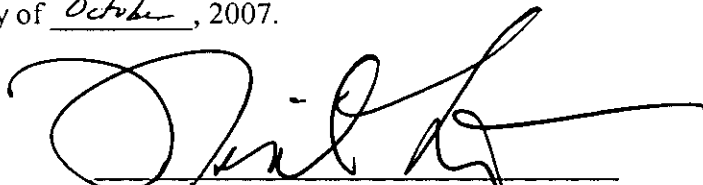
11
12
13 
14 Gregory J. Nickels, Mayor
Nick Licata, Acting Mayor

15 Filed by me this 4 day of October, 2007.

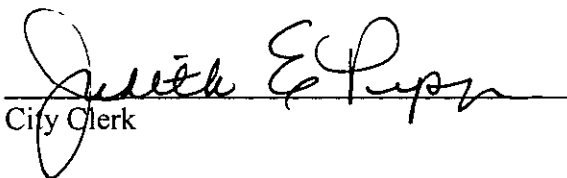
17
18 
19 City Clerk

20 (Seal)

21
22
23
24 **Attachment A: Discovery Park Boulevards Map**

Discovery Park Boulevards

Attachment A

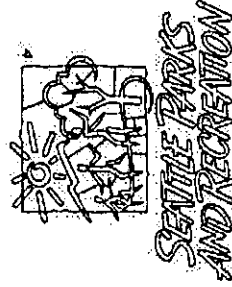
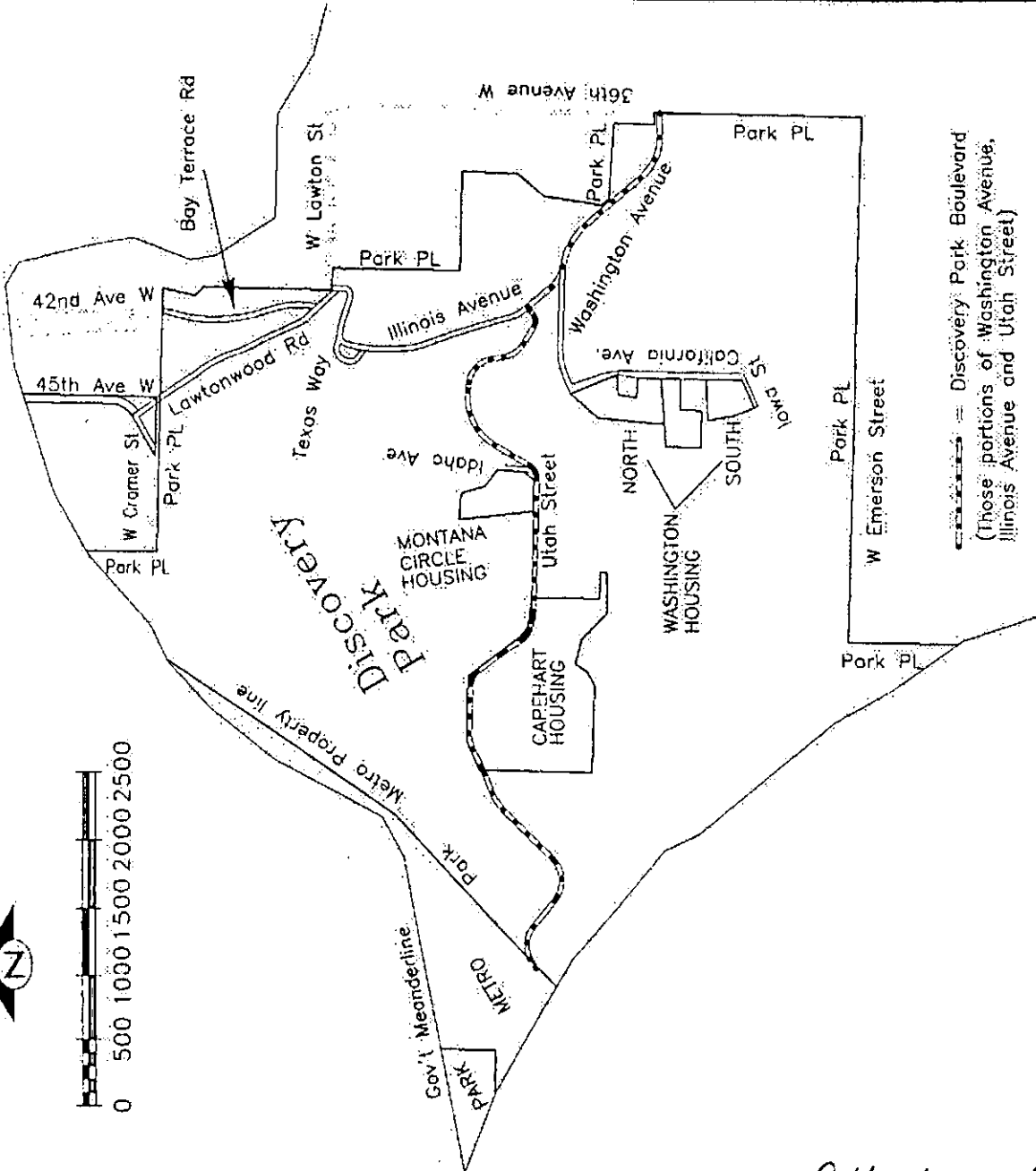

Attachment A
to
Discovery Park Boulevards Ordinance

Attachment A



FISCAL NOTE FOR NON-CAPITAL PROJECTS

Department:	Contact Person/Phone:	DOF Analyst/Phone:
Parks and Recreation	Terry Dunning / 684-4860	Jennifer Devore / 615-1328

Legislation Title:

AN ORDINANCE relating to real property known as Discovery Park and the laying off of portions of the park roadways within Discovery Park known as Utah Street, Washington Avenue, California Avenue, Iowa Street, Lawtonwood Road, Illinois Avenue, Texas Way, Bay Terrace Road, Idaho Avenue and 45th Avenue West, as public park boulevards; amending Appendices I and II to Ordinance 117569 and to Title 15 of the Seattle Municipal Code (Description and Maps of Park Drives and Boulevards); and naming the portions of Washington Avenue and Utah Street so laid off as Discovery Park Boulevard.

• **Summary of the Legislation:**

This legislation changes several portions of park roadways within Discovery Park to Park Boulevards. It also amends the Municipal Code to include these new boulevards and names the central roadway (portions of Washington Avenue and Utah Street) running from the main park entrance to the West Point Treatment Plant as "Discovery Park Boulevard".

• **Background:**

The purpose of this legislation is to create legal access, both for transportation and utility purposes over certain park roadways that have served, and will continue to serve, properties surrounded by the Park (Montana Circle and the Washington Avenue Military Housing areas) and private property accessed via the Park's northern boundary. Currently the Navy and Federal Aviation Administration have easement access only across some of the existing road system. Currently the homes in Lawtonwood and Bay Terrace are accessed via park roads, but have no legal access across these roadways. Changing their status to Park Boulevards gives these roadways the legal status of public streets while preserving them in park jurisdiction.

Although the need for public access has been raised by the Lawtonwood and Bayview Terrace communities in the past, the recent privatization of former military housing creates an additional need for those soon-to-be private homes to have public access and utilities. Failure to provide this access in this form will require the City to enter into separate easement relationships with large numbers of property owners.

In addition to access for transportation purposes, the new boulevards will also become utility corridors and the foci of any new public utility installations within or across the Park, thus preserving natural areas from potential utility encroachments that could potentially serve private properties around and within the Park.

Another important aspect of the conversion of these roadways is that traffic regulations applicable to public streets now will be fully enforceable over the affected roadways. Previously these roadways have been characterized as “private” for enforcement purposes. The new designation should enhance law enforcement within the Park.

- Please check one of the following:

This legislation does not have any financial implications.

This legislation has financial implications.

Appropriations: N/A

Fund Name and Number	Department	Budget Control Level*	2007 Appropriation	2008 Anticipated Appropriation
TOTAL	N/A			

**See budget book to obtain the appropriate Budget Control Level for your department.*

Notes: Costs associated with maintenance of the roadways addressed in this legislation are covered in the Department of Parks and Recreation (DPR) 2007 Operating budget.

Anticipated Revenue/Reimbursement: Resulting From This Legislation: NA

Fund Name and Number	Department	Revenue Source	2007 Revenue	2008 Revenue
TOTAL	N/A			

Notes: N/A



Total Regular Positions Created Or Abrogated Through This Legislation, Including FTE Impact: NA

Position Title and Department*	Fund Name	Fund Number	Part-Time/Full Time	2007 Positions	2007 FTE	2008 Positions**	2008 FTE**
TOTAL	N/A						

Notes: N/A

- **Do positions sunset in the future?** N/A

Spending/Cash Flow: N/A

Fund Name and Number	Department	Budget Control Level*	2007 Expenditures	2008 Anticipated Expenditures
TOTAL	N/A			

Notes: N/A

- **What is the financial cost of not implementing the legislation?** Multiple transactions may be needed in the future to arrange for multiple private rights (primarily access and utilities) in and across the affected roadways. This will potentially involve considerable staff time and the cost of an unknown number of separate pieces of legislation.
- **What are the possible alternatives to the legislation that could achieve the same or similar objectives?** Private easement rights could be created to support the private properties adjacent to and within the Park. This would require multiple transactions with several property owners and possibly several pieces of legislation. Costs would be greater and public services could be delayed until legislation authorizing each right being conveyed is completed.
- **Is the legislation subject to public hearing requirements:** No
- **Is the legislation subject to public hearing requirements:** No



- **Other Issues:** The Park Boulevard system is, in part, maintained consistent with the “Boulevard Agreement” between DPR, Seattle Department of Transportation (SDOT), and Seattle Public Utilities (SPU). This Agreement was adopted by Ordinance 111551 in 1984 and will need to be amended in the near future in order to address conditions and division of responsibilities for these roadways. The future maintenance of these roadways will be discussed between SPU, SDOT and DPR and any changes in maintenance responsibilities arising from these negotiations will be reflected in future budgets.

Please list attachments to the fiscal note below: None.

STATE OF WASHINGTON – KING COUNTY

--SS.

216175
CITY OF SEATTLE, CLERKS OFFICE

No.

Affidavit of Publication

The undersigned, on oath states that he is an authorized representative of The Daily Journal of Commerce, a daily newspaper, which newspaper is a legal newspaper of general circulation and it is now and has been for more than six months prior to the date of publication hereinafter referred to, published in the English language continuously as a daily newspaper in Seattle, King County, Washington, and it is now and during all of said time was printed in an office maintained at the aforesaid place of publication of this newspaper. The Daily Journal of Commerce was on the 12th day of June, 1941, approved as a legal newspaper by the Superior Court of King County.

The notice in the exact form annexed, was published in regular issues of The Daily Journal of Commerce, which was regularly distributed to its subscribers during the below stated period. The annexed notice, a

CT:122503 ORDINANCE

was published on

10/08/07

The amount of the fee charged for the foregoing publication is the sum of \$1,095.08, which amount has been paid in full.

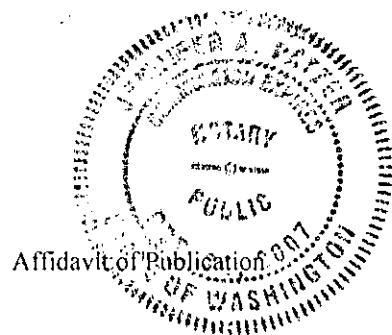

Samela Olesky

Subscribed and sworn to before me on

10/08/07

[Signature]

Notary public for the State of Washington,
residing in Seattle

City of Seattle

ORDINANCE 122503

AN ORDINANCE relating to real property known as Discovery Park and the laying off of portions of the park roadways within Discovery Park known as Utah Street, Washington Avenue, California Avenue, Iowa Street, Lawtonwood Road, Illinois Avenue, Texas Way, Bay Terrace Road, Idaho Avenue and 45th Avenue West, as public park boulevards; amending Appendices I and II to Ordinance 117569 and to Title 15 of the Seattle Municipal Code (Description and Maps of Park Drives and Boulevards); and naming the portions of Washington Avenue and Utah Street so laid off as Discovery Park Boulevard.

WHEREAS, owners of private properties abutting several of the rights of way in Discovery Park require access across the rights of way for utility purposes or ingress and egress to adjacent private properties; and

WHEREAS, the rights of private property owners will be preserved if the street rights of way are characterized as Park Boulevards; and

WHEREAS, designation as a Park Boulevard provides for uses for transportation and utility purposes; and

WHEREAS, public safety will be enhanced within Discovery Park as traffic codes and regulations are fully enforceable on Park Boulevards as they are on City of Seattle streets, but not necessarily on park roads which are considered "private"; and

WHEREAS, the proposed designation will cause the newly designated boulevards to be part of the joint maintenance responsibilities (to the extent required) by the Seattle Department of Parks and Recreation ("DPR"), Seattle Department of Transportation, and Seattle Public Utilities; and

WHEREAS, Park Boulevards are under the jurisdiction of DPR and thus are consistent with covenants made with the grantors of the property, the United States, requiring that the lands of Discovery Park be maintained in perpetuity for park purposes;

NOW, THEREFORE,

BE IT ORDAINED BY THE CITY OF SEATTLE AS FOLLOWS:

Section 1. The portions of the park roadways known as Utah Street, Washington Avenue, California Avenue, Iowa Street, Lawtonwood Road, Illinois Avenue, Texas Way, Bay Terrace Road, Idaho Avenue and 45th Avenue West (the "Designated Portions"), described as follows are hereby designated as Park Boulevards, as defined in SMC 15.02.046 and RCW 35.21.190:

Description of Discovery Park Road known as

Washington Avenue

From 36th Ave W to Discovery Park Road known as California Avenue

A 40 foot strip of land in the NE¼ and the NW¼ of Section 15, Township 25 North, Range 3 East, Willamette Meridian in the City of Seattle, King County, Washington, lying 20 feet on each side of the following described line:

Commencing at a tack and lead 7.33 feet north of a concrete monument in case marking the intersection of the centerlines of 36th Avenue West and West Government Way, thence S 1°17'29" W along the centerline of 36th Avenue West a distance of 9.25 feet, thence S 88°44'15" W a distance of 30.03 feet to the intersection with Discovery Park boundary and the True Point of Beginning;

Thence continuing S 88°44'15" W a distance of 185.88 feet to the beginning of a curve to the right, being concave to the north,

Thence westerly and northerly along said curve, having a radial bearing of N 1°15'45" W a radius of 410.00 feet, a central angle of 50°16'52" an arc distance of 359.80 feet to a point of tangency,

Thence N 40°58'33" W a distance of 554.29 feet to the beginning of a curve to the left, being concave to the south,

Thence northerly and westerly along said curve, having a radial bearing of S 49°01'07" W, a radius of 500.00 feet, a central angle of 40°22'34" an arc distance of 352.35 feet to the intersection with Illinois Avenue to the north, designated here as "V",

Thence continuing westerly along said curve through an additional central angle of 7°01'46" an arc distance of 61.34 feet to a point of tangency,

Thence N 88°23'13" W a distance of 539.11 feet to the beginning of a curve to the right, being concave to the south,

State of Washington, King County

Thence westerly and southerly along said curve, having a radial bearing of S 1°38'47" W, a radius of 540.00 feet, a central angle of 26°51'24" an arc distance of 253.12 feet to a point of tangency,

Thence S 64°45'23" W a distance of 52.43 feet to the intersection with California Avenue to the south, designated here as "C",

Thence continuing S 64°45'23" W a distance of 49.54 feet to a point bearing S 22°08'01" E and 20.03 feet distant from a concrete monument marked USN-WN-3 and the terminus of this description,

Sidelines at the point of beginning and at the terminus to be extended or shortened to their intersections with crossing lines.

Description of Discovery Park Road known as

California Avenue

From Washington Avenue to Iowa Street

A variable width strip of land in the NW¼ of Section 15, Township 25 North, Range 3 East, Willamette Meridian in the City of Seattle, King County, Washington, the westerly margin of which abuts and is contiguous with the easterly boundaries of the parcels known as Washington Housing North, NOAA, and Washington Housing South, and the easterly margin lays 15 feet on the easterly side of the following described line:

Commencing at the intersection of California Avenue and Washington Avenue designated "C" in the Washington Avenue description,

Thence S 18°55'38" E a distance of 20.12 feet to the southerly margin of Washington Avenue and the True Point of Beginning;

Thence continuing S 18°55'38" E a distance of 242.25 feet to the beginning of a curve to the right, being concave to the west,

Thence southerly along said curve, having a radial bearing of S 71°04'22" W, a radius of 412.00 feet, a central angle of 20°16'04" an arc distance of 145.74 feet, to a point of tangency,

Thence S 1°20'26" W a distance of 899.68 feet to the intersection with Iowa Street to the southwest, designated here as "I",

Thence continuing S 1°20'26" W a distance of 16.47 feet to the terminus of this described line.

The easterly side line at the southerly margin of Washington Avenue and at the southerly margin of Iowa Street to be extended or shortened to its intersection with said crossing lines.

The westerly margin is more particularly described as:

Commencing at the intersection of the easterly boundary of a parcel of land known as Washington Housing North and the centerline terminus of Washington Avenue,

Thence S 22°06'01" E along said easterly boundary of Washington Housing North a distance of 362.69 feet to a concrete monument with brass disk designated USN-WN-4,

Thence leaving the boundary of Washington Housing North S 8°45'58" W a distance of 155.49 feet to a concrete monument with brass disk designated USN-WN-7,

Thence along the boundary of Washington Housing North S 1°50'21" W a distance of 173.61 feet to a concrete monument with brass disk designated USN-WN-8,

Thence along the boundary of a parcel of land known as NOAA S 1°20'51" W a distance of 143.74 feet to a concrete monument with brass disk designated NOAA #4,

Thence leaving the boundary of NOAA S 1°10'09" W a distance of 194.82 feet to a concrete monument with brass disk designated USN-WS-4 marking the northeasterly corner of a parcel of land known as Washington Housing South,

Thence along the boundary of Washington Housing South S 1°15'25" W a distance of 267.94 feet to a concrete monument with brass disk designated USN-WS-5 and the intersection with the northerly margin of Iowa Street.

Description of Discovery Park Road known as

Iowa Street

From California Avenue to Washington Avenue

A 30 foot strip of land in the NW¼ of Section 15, Township 25 North, Range 3 East, Willamette Meridian in the City of Seattle, King County, Washington, lying 15 feet on each side of the following described line:

Commencing at the intersection of California Avenue and Iowa Street designated "IO" in the California Avenue description, thence S 66°18'52" W a distance of 40.88 feet to the westerly margin of California Avenue extended and the True Point of Beginning;

Thence continuing S 66°18'52" West a distance of 217.74 feet to the terminus of this description.

Said point lying S 23°43'08" E and 15.00 feet distant from a concrete monument designated as USN-WS-1.

Sidelines at the easterly margin of California Avenue to be extended or shortened to the intersection with said crossing line.

Description of Discovery Park Road known as

Illinois Avenue

From Washington Avenue to Texas Way

A 40 foot strip of land in the SW¼ of Section 10, Township 25 North, Range 3 East, and in the NE¼ and the NW¼ of Section 15, Township 25 North, Range 3 East, Willamette Meridian in the City of Seattle, King County, Washington, lying 20 feet on each side of the following described line:

Commencing at the intersection of Washington Avenue and Illinois Avenue designated "V" in the Washington Avenue description, and the beginning of a curve to the right, being concave to the northeast, thence northerly and westerly along said curve having a radial bearing of N 8°38'33" E, a radius of 241.00 feet, a central angle of 19°36'09" an arc distance of 82.45 feet to the northerly margin of Washington Avenue and the True Point of Beginning;

Thence continuing along said curve, through an additional central angle of 22°52'26" an arc distance of 96.21 feet to a point of tangency,

Thence N 38°52'52" W a distance of 228.13 feet to the intersection with Utah Street to the west, designated here as "U",

Thence continuing N 38°52'52" W a distance of 56.10 feet to the beginning of a curve to the right being concave to the east,

Thence northerly along said curve, having a radial bearing of N 51°07'08" E, a radius of 212.11 feet, a central angle of 24°18'02" an arc distance of 90.02 feet to a point of reverse curvature,

Thence northerly along a curve to the left being concave to the west, having a radial bearing of S 75°26'10" W, a radius of 7299.31 feet, a central angle of 5°43'20" an arc distance of 729.01 feet to a point of reverse curvature,

Thence northerly along a curve to the right being concave to the east, having a radial bearing of N 69°42'49" E, a radius of 336.60 feet, a central angle of 19°06'45" an arc distance of 112.28 feet to a point of tangency,

Thence N 1°10'26" W a distance of 173.21 feet to the beginning of a curve to the right being concave to the east,

Thence northerly along said curve, having a radial bearing of N 88°49'34" E, a radius of 922.50 feet, a central angle of 8°19'13" an arc distance of 133.96 feet to a point on the curve designated here as "Z",

Thence continuing along said curve through an additional central angle of 9°06'08" an arc distance of 146.55 feet to a point of compound curvature,

Thence northerly and easterly along a curve concave to the southeast, having a radial bearing of S 73°45'06" E a radius of 83.07 feet, a central angle of 81°23'45" an arc distance of 89.60 feet to an intersection with Texas Way designated here as "T",

Thence westerly along a curve concave to the north having a radial bearing of N 73°38'11" E, a radius of 352.21 feet, a central angle of 15°30'47" an arc distance of 95.36 feet to a point of reverse curvature,

Thence westerly along a curve concave to the south having a radial bearing of S 23°08'58" W, a radius of 33.58 feet, a central angle of 30°00'28" an arc distance of 17.59 feet to a point of compound curvature,

Thence westerly and southerly along a curve concave to the east, having a radial bearing of S 6°51'30" E, a radius of 104.76 feet, a central angle of 95°11'31" an arc distance of 174.05 feet to a point of compound curvature,

Thence southerly and easterly along a curve concave to the northeast, having a radial bearing of N 77°56'59" E, a radius of 56.04 feet, a central angle of 42°11'39" an arc distance of 41.27 feet to a point of tangency,

Thence S 54°14'40" E a distance of 98.28 feet to a point previously designated as "Z", and the terminus of this description.

Sidelines at the northerly margin of Washington Avenue and at the terminus to be extended or shortened to their intersections with crossing lines.

Description of Discovery Park Road known as

Utah Street

From Illinois Avenue to METRO West Point

A 36 foot strip of land in Section 9, Section 10, Section 15 and Section 16, Township 25 North, Range 3 East, Willamette Meridian in the City of Seattle, King County, Washington, lying 18 feet on each side of the following described line:

Commencing at a point on the centerline of Illinois Avenue designated "U" in the Illinois Avenue description, thence S 56°27'15" W a distance of 20.09 feet to the westerly margin of Illinois Avenue and the True Point of Beginning;

Thence continuing S 56°27'15" W a distance of 65.29 feet to the beginning of a curve to the right being concave to the north,

Thence westerly and northerly along said curve, having a radial bearing of N 33°32'45" W, a radius of 65.00 feet, a central angle of 64°45'03" an arc distance of 73.46 feet to a point of tangency,

Thence N 58°47'42" W a distance of 166.43 feet to the beginning of a curve to the right being concave to the northeast,

Thence westerly and northerly along said curve having a radial bearing of N 31°12'18" E, a radius of 220.00 feet, a central angle of 49°41'04" an arc distance of 190.77 feet to a point of tangency,

Thence N 8°06'38" W a distance of 97.88 feet to the beginning of a curve to the left being concave to the southwest,

Thence northerly and westerly along said curve having a radial bearing of S 80°53'22" W, a radius of 200.00 feet, a central angle of 73°18'58" an arc distance of 256.81 feet to a point of tangency,

Thence N 82°23'36" W a distance of 62.83 feet to the beginning of a curve to the left being concave to the south,

Thence westerly and southerly along said curve having a radial bearing of S 7°36'24" W, a radius of 408.00 feet, a central angle of 67°50'13" an arc distance of 483.06 feet to a point of tangency,

Thence S 29°46'11" W a distance of 304.98 feet to the beginning of a curve to the right, being concave to the northwest,

Thence southerly and westerly along said curve having a radial bearing of N 60°13'49" W, a radius of 110.00 feet, a central angle of 27°28'58" an arc distance of 52.70 feet to the intersection with Idaho Avenue to the north, designated here as "ID".

Thence continuing along said curve through an additional central angle of 34°03'02" an arc distance of 65.37 feet to a point of tangency,

Thence N 88°43'49" W a distance of 914.95 feet more or less to the easterly boundary of a tract of land known as Capehart Housing,

Thence continuing N 88°43'49" W a distance of 98.81 feet to the beginning of a curve to the right being concave to the north,

Thence westerly and northerly along said curve having a radial bearing of N 1°16'11" E, a radius of 300.00 feet, a central angle of 14°55'31" an arc distance of 78.15 feet to a point of tangency,

Thence N 78°48'18" W a distance of 64.65 feet to the beginning of a curve to the right being concave to the northeast,

Thence westerly and northerly along said curve having a radial bearing of N 18°11'42" E, a radius of 150.00 feet, a central angle of 40°38'18" an arc distance of 106.30 feet to a point of tangency,

Thence N 33°12'00" W a distance of 150.21 feet to the beginning of a curve to the left being concave to the southwest,

Thence northerly and westerly along said curve having a radial bearing of S 56°48'00" W, a radius of 700.00 feet, a central angle of 4°17'14" an arc distance of 52.38 feet to a point of tangency,

Thence N 37°29'14" W a distance of 214.70 feet to the beginning of a curve to the left being concave to the southwest,

Thence northerly and westerly along said curve having a radial bearing of S 52°30'46" W, a radius of 120.00 feet, a central angle of 60°38'40" an arc distance of 106.00 feet to a point of tangency,

Thence N 88°05'54" W a distance of 375.09 feet to the beginning of a curve to the left being concave to the southeast,

Thence westerly and southerly along said curve having a radial bearing of S 1°54'06" W, a radius of 250.00 feet, a central angle of 28°48'36" an arc distance of 126.71 feet to a point of tangency,

Thence S 63°05'30" W a distance of 142.19 feet to the beginning of a curve to the right being concave to the northwest,

Thence westerly and southerly along said curve having a radial bearing of N 26°54'30" W, a radius of 700.00 feet, a central angle of 2°31'19" an arc distance of 30.81 feet to the westerly boundary of a tract of land known as Capehart Housing,

Thence continuing along said curve through an additional 2°09'33" an arc distance of 26.38 feet to a point of tangency,

Thence S 67°46'22" W a distance of 156.83 feet to the beginning of a curve to the left being concave to the southeast,

Thence westerly and southerly along said curve having a radial bearing of S 22°13'38" E, a radius of 350.00 feet, a central angle of 24°20'15" an arc distance of 146.67 feet to a point of tangency,

Thence S 43°26'07" W a distance of 506.14 feet to the beginning of a curve to the right being concave to the northwest,

Thence southerly and westerly along said curve having a radial bearing of N 46°39'53" W, a radius of 230.00 feet, a central angle of 66°38'11" an arc distance of 347.78 feet to a point of tangency,

Thence N 49°55'42" W a distance of 245.07 feet to the beginning of a curve to the left being concave to the south,

Thence westerly along said curve having a radial bearing of S 40°04'18" W, a radius of 220.00 feet, a central angle of 69°40'07" an arc distance of 267.51 feet to a point of tangency,

Thence S 60°24'11" W a distance of 34.14 feet to the boundary of Discovery Park and METRO West Point, and the terminus of this description.

TOGETHER WITH a strip of land northerly of the northerly margin of the above described boulevard area and abutting the most southerly boundary of a parcel of land known as Montana Circle Housing, described as follows:

Commencing at a point on the centerline of Utah Street designated "ID" previously in this description, thence southerly and westerly along a curve on the centerline of Utah Street an arc distance of 65.37 feet to a point of tangency, thence N 88°43'49" W a distance of 9.05 feet, thence N 1°16'11" E a distance of 18.00' to the northerly margin of Utah Street and the TPOB of this strip;

Thence continuing N 1°16'11" E a distance of 4.20 feet more or less to a capped rebar marked "DEA" at the southeasterly corner of Montana Circle Housing,

Thence N 89°05'43" W a distance of 239.68 feet to a capped rebar marked "DEA" at the southwesterly corner of Montana Circle Housing,

Thence S 1°16'11" W a distance of 2.67 feet more or less to the northerly margin of Utah Street,

Thence S 88°43'49" E a distance of 239.67 feet to the TPOB and the end of this strip.

Sidelines at the initial point of beginning and at the terminus to be extended or shortened to their intersections with crossing lines.

Description of Discovery Park Road known as
Idaho Avenue

From Utah Street to 230 Feet Northerly

A 40 foot strip of land in the NW¼, Section 15, Township 25 North, Range 3 East, Willamette Meridian in the City of Seattle, King County, Washington, lying 20 feet on each side of the following described line:

Commencing at a point on the centerline of Utah Street designated "ID" in the Utah Street description, thence N 4°11'23" E a distance of 28.95 feet to the northwesterly margin of Utah Street and the True Point of Beginning;

Thence continuing N 4°11'23" E a distance of 206.05 feet to the terminus of this description.

Sidelines at the point of beginning to be extended or shortened to their intersections with crossing lines.

Description of Discovery Park Road known as
Texas Way

From Illinois Avenue to West Lawton St

A 40 foot strip of land in the SW¼ of Section 10, Township 25 North, Range 3 East, Willamette Meridian in the City of Seattle, King County, Washington, lying 20 feet on each side of the following described line:

Commencing at the intersection of Illinois Avenue and Texas Way designated "T" in the Illinois Avenue description, and being the True Point of Beginning;

Thence S 82°21'20" E a distance of 57.77 feet to the beginning of a curve to the right being concave to the south,

Thence easterly along said curve having a radial bearing of S 7°38'40" W, a radius of 200.00 feet, a central angle of 11°12'34" an arc distance of 39.13 feet to a point of tangency,

Thence S 71°08'45" E a distance of 191.64 feet to the beginning of a curve to the left being concave to the northwest,

Thence easterly and northerly along said curve having a radial bearing of N 18°51'15" E, a radius of 50.00 feet, a central angle of 107°41'33" an arc distance of 95.98 feet to a point of tangency on the centerline of 40th Avenue West extended southerly.

Thence N 1°09'42" E along said extension of the centerline of 40th Avenue a distance of 39.31 feet to the intersection of Lawtonwood Road, designated here as "L".

Thence continuing N 1°09'42" E a distance of 51.17 feet more or less to the intersection with Discovery Park boundary (southerly margin of West Lawton Street) and the terminus of this description.

Sidelines at the beginning and at the terminus to be extended or shortened to their intersections with crossing lines.

Description of Discovery Park Road known as

Lawtonwood Road

From 40th Avenue West to West Cramer Street

A 40 foot strip of land in the SW¼ and the NW¼ of Section 10, Township 25 North, Range 3 East, Willamette Meridian in the City of Seattle, King County, Washington, lying 20 feet on each side of the following described line:

Commencing at a concrete monument in case marking the intersection of the centerlines of West Commodore Street and 40th Avenue West, thence S 1°09'42" W along the centerline of 40th Avenue West a distance of 455.57 feet to the Discovery Park boundary (southerly margin West Lawton Street), thence continuing S 1°09'42" W a distance of 51.17 feet to the intersection with Lawtonwood Road to the northwest designated "L" in the Texas Way description, thence N 41°52'56" W a distance of 29.30 feet to the westerly margin of Texas Way and the True Point of Beginning;

Thence continuing N 41°52'56" W a distance of 176.82 feet to an intersection with a Discovery Park road to the north, known as Bay Terrace Road, designated here as "BT".

Thence continuing N 41°52'56" W a distance of 130.51 feet to the beginning of a curve to the right, being concave to the northeast,

Thence northerly and westerly along said curve having a radial bearing of N 48°07'04" E, a radius of 169.30 feet, a central angle of 17°31'40" an arc distance of 51.79 feet to a point of tangency,

Thence N 24°21'16" W a distance of 273.31 feet to the beginning of a curve to the left, being concave to the southwest,

Thence northerly and westerly along said curve having a radial bearing of S 65°38'44" W, a radius of 379.75 feet, a central angle of 3°17'42" an arc distance of 21.84 feet to a point of tangency,

Thence N 27°38'57" W a distance of 148.91 feet to the beginning of a curve to the right being concave to the northeast,

Thence northerly and westerly along said curve having a radial bearing of N 62°21'03" E,

a radius of 425.89 feet, a central angle of 7°60'39" an arc distance of 68.31 feet to a point of tangency,

Thence N 19°48'18" W a distance of 109.47 feet to the beginning of a curve to the left being concave to the southwest,

Thence northerly and westerly along said curve having a radial bearing of S 70°11'42" W, a radius of 345.05 feet, a central angle of 8°42'20" an arc distance of 52.43 feet to a point of tangency,

Thence N 28°30'38" W a distance of 78.78 feet to the beginning of a curve to the left being concave to the southwest,

Thence northerly and westerly along said curve having a radial bearing of S 61°29'22" W, a radius of 403.00 feet, a central angle of 8°04'12" an arc distance of 56.76 feet to a point of tangency,

Thence N 38°34'50" W a distance of 87.89 feet to the beginning of a curve to the right being concave to the northeast,

Thence northerly and westerly along said curve having a radial bearing of N 53°25'10" E, a radius of 1143.00 feet, a central angle of 4°17'55" an arc distance of 85.76 feet to a point of tangency,

Thence N 32°16'55" W a distance of 125.35 feet to the beginning of a curve to the left being concave to the southwest,

Thence northerly and westerly along said curve having a radial bearing of S 57°48'05" W, a radius of 783.17 feet, a central angle of 3°59'37" an arc distance of 54.59 feet to a point of tangency,

Thence N 36°16'32" W a distance of 40.23 feet to the southerly margin of a 30 foot street right of way established by Act of Congress, May 2, 1908 and known as West Cramer Street,

Thence continuing N 36°16'32" W a distance of 38.25 feet to the northerly margin of West Cramer Street,

Thence continuing N 36°16'32" W a distance of 197.98 feet to the intersection with a line 20 feet southeast of and parallel with the Discovery Park boundary line, designated here as "A".

Thence S 60°14'64" W along said line 20 feet southeast and parallel with the Discovery Park boundary line a distance of 304.03 feet to the intersection with the north line of said West Cramer Street as established by Act of Congress on May 2, 1908 and the terminus of this description.

Sidelines at the point of beginning and at the south and north margins of West Cramer Street to be extended or shortened to their intersections with crossing lines.

Description of Discovery Park Road known as
45th Avenue West

from Lawtonwood Road to the Government Meanderline

A 60 foot strip of land in the NW¼ of Section 10, Township 25 North, Range 3 East, Willamette Meridian in the City of Seattle, King County, Washington, lying 30 feet on each side of the following described line:

Commencing at a point designated as "A" in the Lawtonwood Road description, thence S 38°16'32" E a distance of 10.07 feet to the intersection with a line 30 feet southeast of and parallel with the Discovery Park boundary line, and the beginning of a curve to the left, concave to the west, thence along said curve having a radial bearing of N 30°05'03" W, a radius of 230.00 feet, a central angle of 4°59'39" an arc distance of 20.05 feet to the northeasterly margin of Lawtonwood Road and the True Point of Beginning;

Thence continuing along said curve through an additional central angle of 53°50'25" an arc distance of 216.13 feet to a point of tangency,

Thence N 1°04'54" E a distance of 656.40 feet more or less to the Government Meander Line and the terminus of this description.

Sidelines at the point of beginning and at the Government Meander Line to be extended or shortened to their intersections with crossing lines.

Description of Discovery Park Road known as
Bay Terrace Road

From Lawtonwood Road to West Cramer Street

A 40 foot strip of land in the SW¼ of Section 10, Township 25 North, Range 3 East, Willamette Meridian in the City of Seattle, King County, Washington, lying 20 feet on each side of the following described line:

Commencing at a point on the centerline of Lawtonwood Road designated "BT" in the Lawtonwood Road description, thence N 8°57'22" E a distance of 25.79 feet to the northerly margin of Lawtonwood Road and the True Point of Beginning;

Thence continuing N 8°57'22" E a distance of 22.10 feet to the beginning of a curve to the left being concave to the west,

Thence northerly along said curve having a radial bearing of N 81°02'38" W, a radius of 653.50 feet, a central angle of 28°27'39" an arc distance of 324.62 feet to a point of reverse curvature,

Thence northerly along a curve to the right concave to the east having a radial bearing of N 70°29'43" E, a radius of 1280.25 feet, a central angle of 15°16'11" an arc distance of 341.20 feet to a point of compound curvature;

Thence northerly along a curve to the right concave to the east having a radial bearing of N 85°45'54" E, a radius of 1096.22 feet, a central angle of 22°53'48" an arc distance of 438.07 feet to a point of reverse curvature,

Thence northerly along a curve to the left concave to the west, having a radial bearing of N 71°20'18" W, a radius of 104.83 feet, a central angle of 21°39'32" an arc distance of 99.63 feet to a point of tangency on the centerline of 42nd Avenue West extended southerly,

Thence N 2°59'50" W along said extension of 42nd Avenue West a distance of 1.00 feet more or less to the boundary of Discovery Park and the terminus of this description.

Sidelines at the point of beginning and at the terminus to be extended or shortened to their intersections with crossing lines.

Section 2. Appendix I to Ordinance 117569 and to Title 15 of the Seattle Municipal Code (Description and Maps of Park Drives and Boulevards) is hereby amended to include the laid off boulevards described above, and the code reviser is directed to add them to Appendix I.

Section 3. Appendix II, Corresponding Maps of Park Drives and Boulevards, to Title 15 of the Seattle Municipal Code and to Ordinance 117569, is hereby amended by the addition of the maps, attached to this ordinance as Attachment A, depicting the Designated Portions as Park Boulevards. In the event of conflict between the maps in Attachment A and the descriptions in Section 1 of this Ordinance, the descriptions in Section 1 shall control.

Section 4. Those portions of Washington Avenue and Utah Street laid off as Park Boulevards shall be named "Discovery Park Boulevard" and shall be signed accordingly.

Section 5. This ordinance shall take effect and be in force thirty (30) days from and after its approval by the Mayor, but if not approved and returned by the Mayor within ten (10) days after presentation, it shall take effect as provided by Municipal Code Section 1.04.020.

Passed by the City Council the 24th day of September, 2007, and signed by me in open session in authentication of its passage this 24th day of September, 2007.

Nick Licata

President of the City Council

Approved by me this 3rd day of October, 2007.

Gregory J. Nickels, Mayor

Filed by me this 4th day of October, 2007.

(Seal) Judith Pippin

City Clerk

Attachment A: Discovery Park Boulevards Map

See City Clerk for Attachment

Publication ordered by JUDITH PIPPIN,
City Clerk

Date of publication in the Seattle Daily Journal of Commerce, October 8, 2007.

10/8(216175)