

IMPROVEMENTS: OPEN LAWN AREAS, VIEWPOINT, TRAILS  
FOOT/BIKE PATH

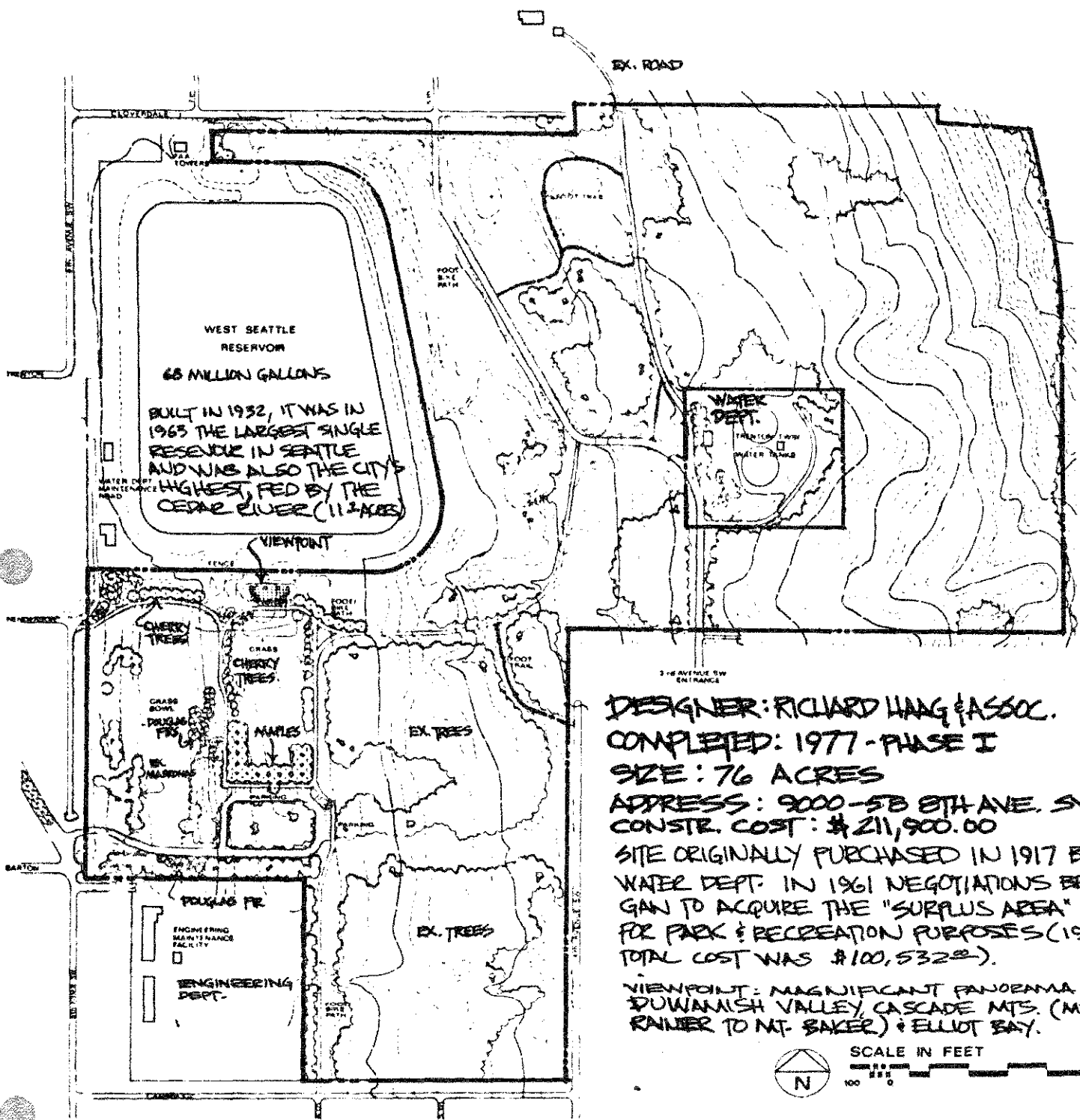

DESIGNER: RICHARD HAAG & ASSOC.  
 COMPLETED: 1977 - PHASE I  
 SIZE: 76 ACRES  
 ADDRESS: 9000-58 8TH AVE. SW.  
 CONSTR. COST: \$211,900.00  
 SITE ORIGINALLY PURCHASED IN 1917 BY  
 WATER DEPT. IN 1961 NEGOTIATIONS BE-  
 GAN TO ACQUIRE THE "SURPLUS AREA"  
 FOR PARK & RECREATION PURPOSES (1917  
 TOTAL COST WAS \$100,532.00).  
 VIEWPOINT: MAGNIFICANT PANORAMA OF  
 DUWAMISH VALLEY, CASCADE MTS. (MT.  
 RAINIER TO MT. BAKER) & ELLIOT BAY.



634

WESTCREST PARK

062976 DNS REVISED 7-14-77 DYS