

# GOLDEN GARDENS PARK

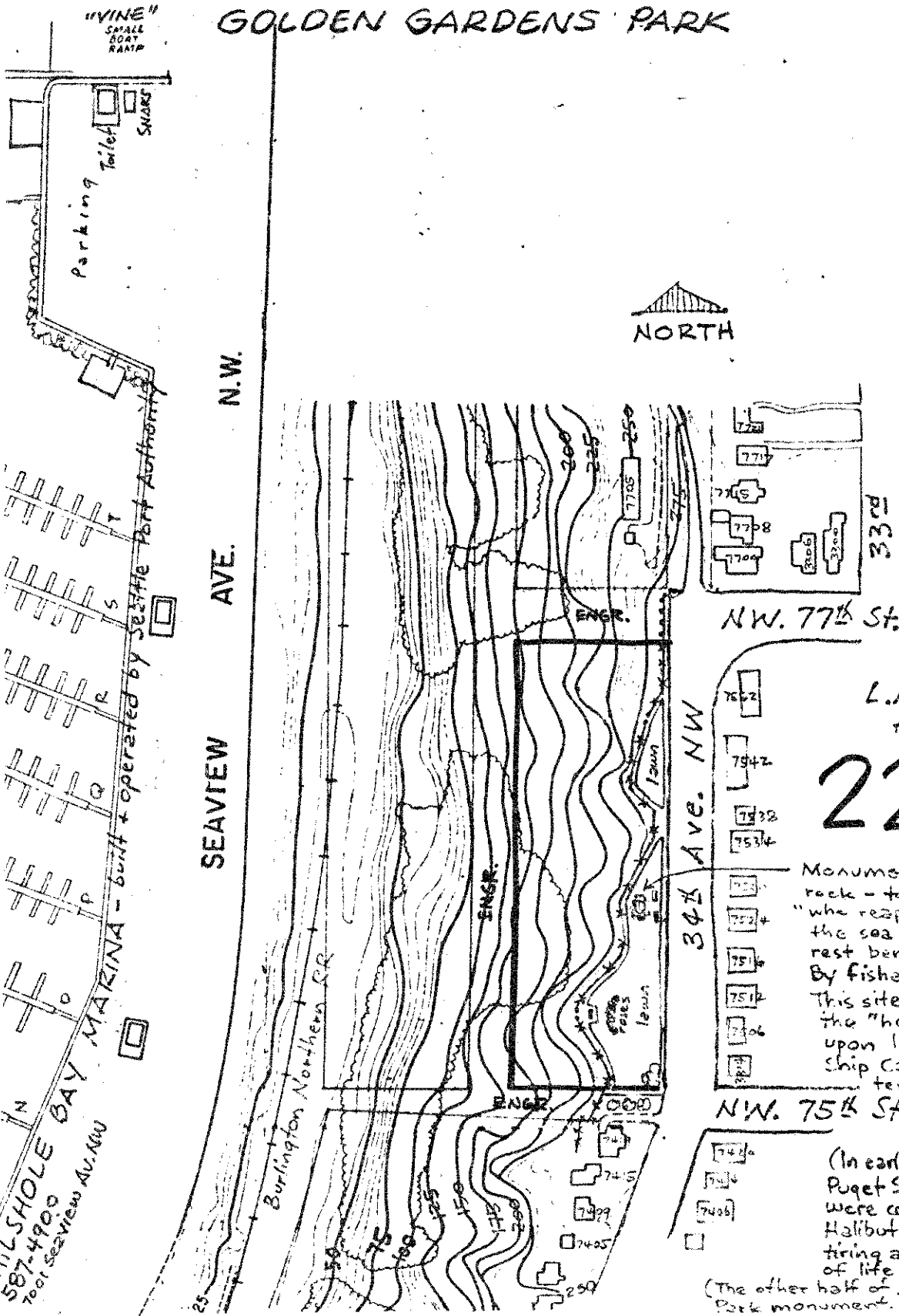

In 1930's a path ceded this park with Golden Gardens Park and, upon petition of the Community Club (1931), named in honor of H.D. Coale - the club's first president - promoter of this park. Path was lined with rhododendrons.

L.I.D. 1929: 56,924 = for park improv.

## 222

Monument - plaque on a granite rock - to Halibut fishermen "who reaped their living from the sea and found their final rest beneath its waves." By fishermen's Wives Assn. 1960  
 This site chosen because it is the "home" point of land seen upon leaving or entering the ship canal (south of here); fleet terminal @ SW end of Ballard Bridge; fishing fields in Bering Sea.  
 (In early 1900's Halibut abounded in Puget Sound; Norwegian immigrants were core of fishing crews.) Halibut fishing is a tough, cold, tiring and often dangerous way of life.  
 (The other half of rock is used for in our Park monument.)

(Shilshole comes from Indian tribe camped at "Salmon Bay" - "citeole" which meant "shoving a thread thru a bead" - the stream passing from Lake Washington thru Lake Union, Salmon Bay to Puget Sound.)  
 A magnificent panorama of Shilshole Bay, Puget Sound and the Olympic Mountains from a 300 ft. high bluff.

2.7 Acres  
 Gift in 1903 (to Ballard) of Mr. & Mrs. Geo. A. Moomaw & Mrs. Mrs. John M. Anderson Assoc. w/ Phoenix Mut. Life.

Annex. 1907

# SUNSET HILL PARK

082476