

Thistle St. honors the national flower of Scotland  
 Sullivan St. honors the English musical team of  
 Gilbert + Sullivan.

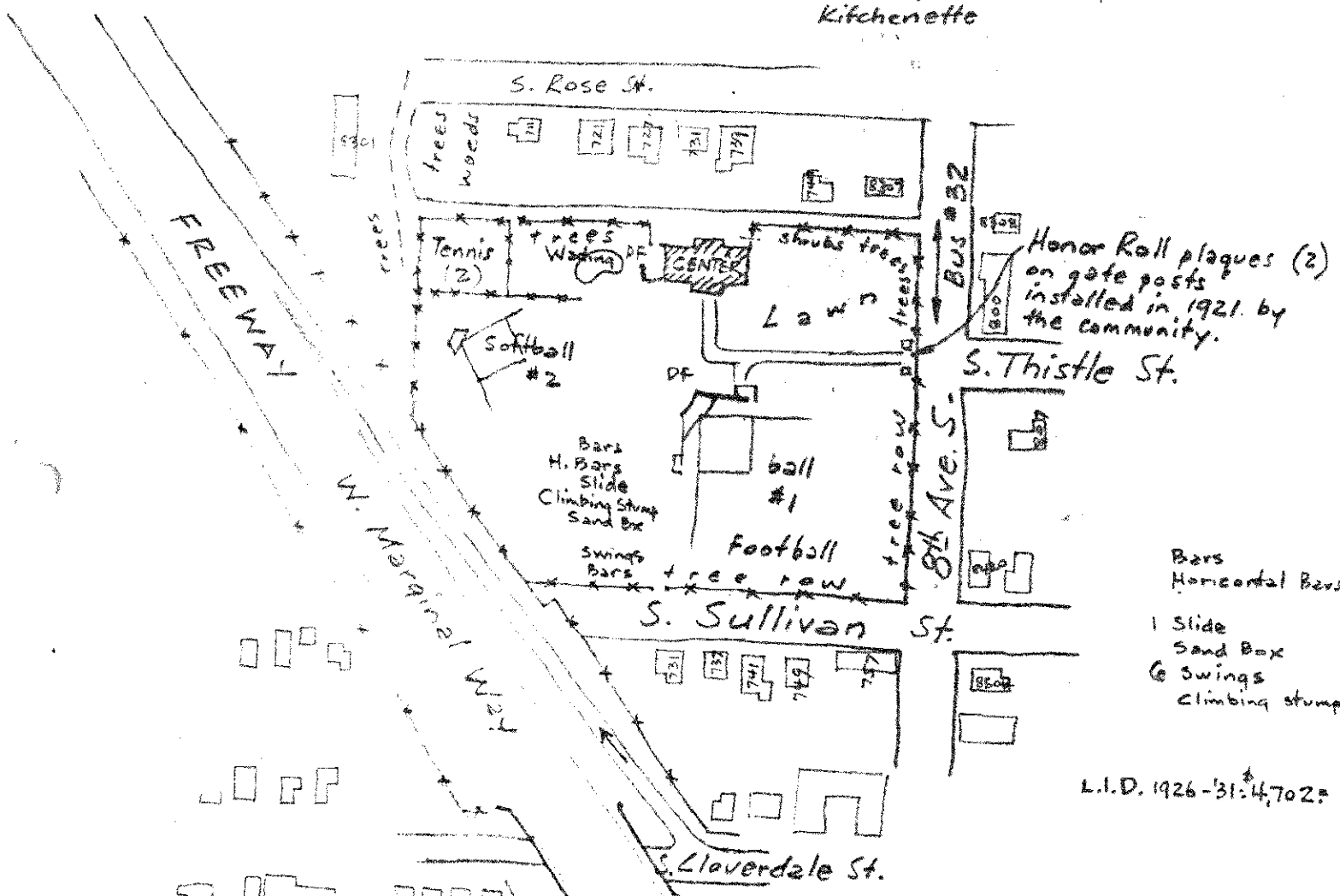

Recreation Center : 1912, \$18,000 = 10 BF  
 "A" 4th Center constr. in Seattle

Gym / stage : 66' x 34' = 320 persons  
 lockers/showers  
 Social Room 32' x 35'  
 Craft Room 10' x 14'  
 Game Room 10' x 14'  
 Kitchenette



Honor Roll plaques (2)  
 on gate posts  
 installed in 1921 by  
 the community.

- Horizontal Bars
- 1 Slide
- Sand Box
- 6 Swings
- Climbing stump

L.I.D. 1926-'31: 4,702 =

Name taken from early town founded prior to 1894 on the Duwamish River, on a Land Donation Claim in 1865 by John + Eva Buckley. About 1900 Joe Desimone bought a large farm tract of this rich river valley: he was instrumental in formation of the Seattle Public Market, Inc. (Pike Place Market) and his gift of property induced Boeing to establish here rather than in Calif. The community, led by Tony Ferrucci, was able to convince Freeway engineers to "miss" the playground.

5.4 Acres  
 Purch. 1910; Freeway 1958  
 (\$30,571 = '08 B.F.)  
 8319 - 8th Ave. S.  
 PA 2-0890  
 (Foreman WE 5-2520)

SOUTH PARK P.G.

00  
 062660