

Olympic Golf + Country Club (— to 1928) from 85th to 95 + 15th to 24th except SE corner
 (18 hole) 90th to 20th to 85th to 15th

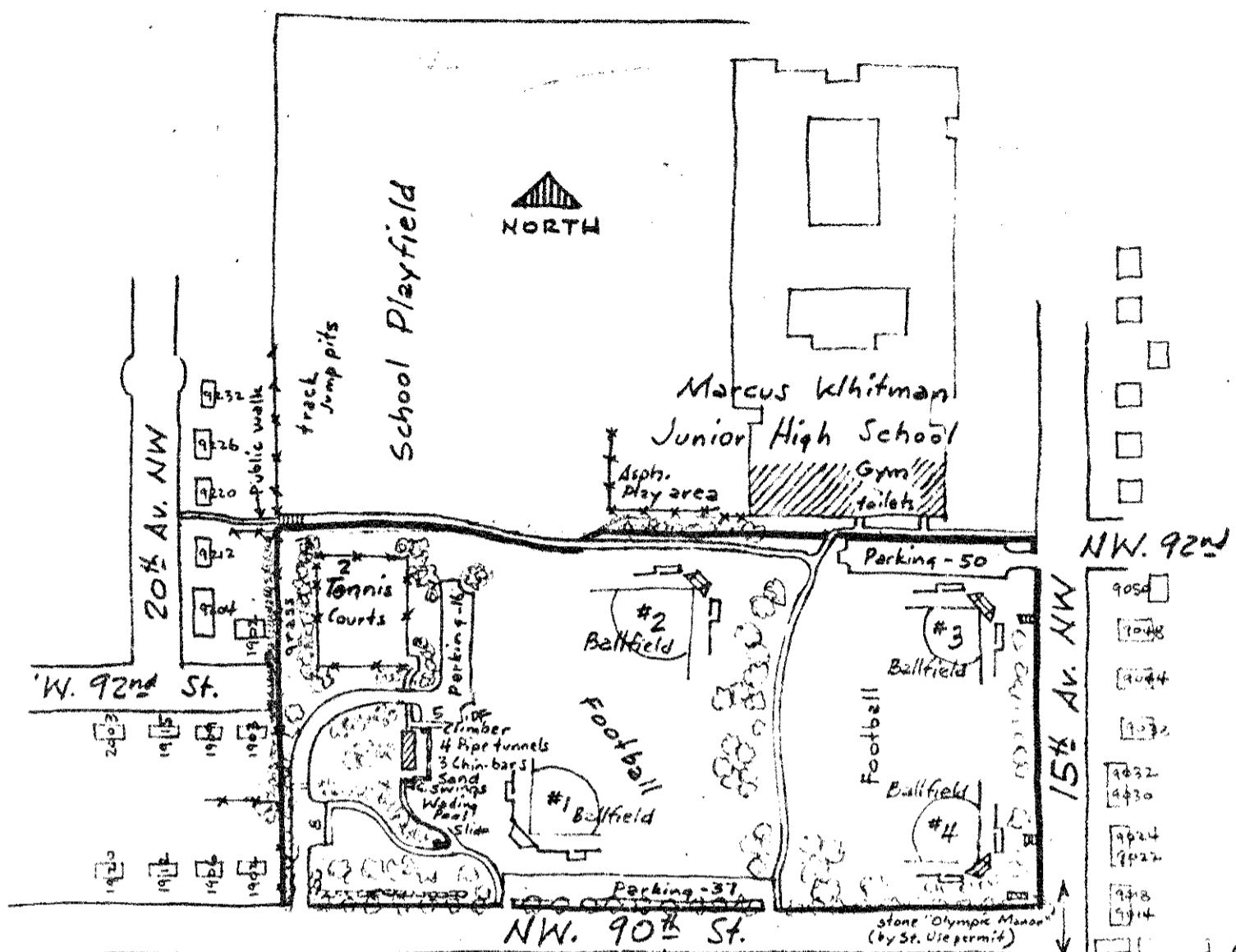

(District known as Crown Hill)
 Former NE corner of Olympic Golf + Country Club (until 1928) and Nat'l Guard Facility S-91; Admin. Bldg. remodelled for present park Shelter House (20'x48') w/playroom.
 Name chosen by community contest in 1959: won by Mr. and Mrs. John Renner.

Improvements by L.I.D. - 1961-3
 \$89,581⁰⁰ by district
 7,192⁰⁰ by Engr. Dept.
 (Option to buy did not allow time for L.I.D. purch.)

Joint-use agreement w/school for Gym + playfield facilities.

221

10.5 Acres
 Purch. 1953 - (\$57,750 = 48 BF)
 1590 NW. 90th St.

SOUNDVIEW P.F.

090376