

In petition of the community the PLAYGROUND was named in honor of NEIL J. SANDEL (1917-1968) Greenwood District Community and Business leader, former supt. of Greenwood A.S. Sewer District; spent much of his life in the greenhouse business. He was a member of the Roosevelt High School Varsity Football + Baseball Teams.

The North Greenwood neighborhood is a shallow basin lined with peat. Homes were built about 1910 without proper drainage, so that flooded basements and drainage ditches filled with standing water were normal. Sandel P.G. was the neighborhood's first play ground and required removal of peat to depths of 6 to 10 feet prior to development: its location was determined by the Planning Commission. The neighborhood was listed as a Critical Area in 1971 by the Model City Program.

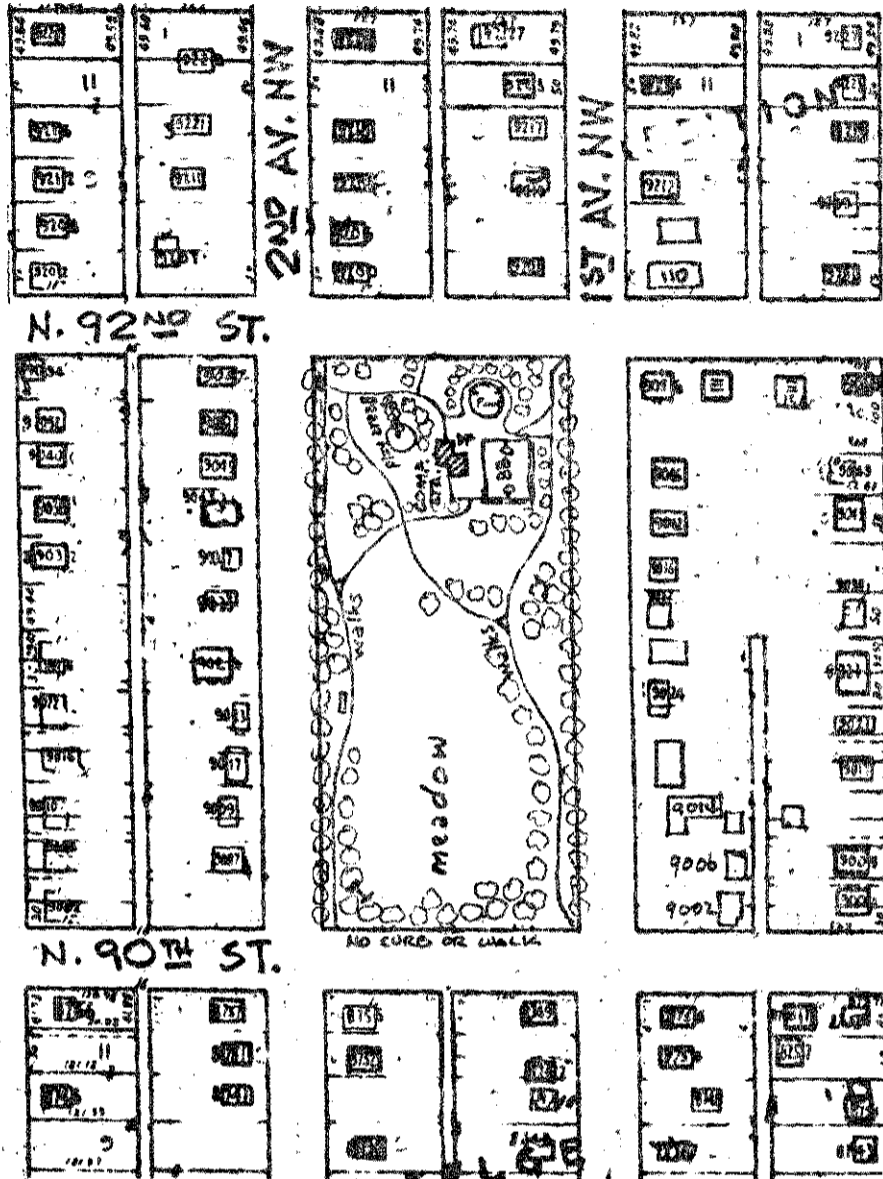

- Play area:
- Boulders
 - Sand circle
 - Swings
 - Slide
 - Climbing Plaff.
 - Wading pool
 - 2 Sculp. sandst. blks
 - by John Geisz
 - 1974 (Spray heads)

220

4.4 Acres
 Purch. 1969 ↑
 (9001-57 1ST AVE. NW
 113 NW 92ND ST.)

SANDEL PLAYGROUND

090376