

Name taken from adjacent school which was named for the Shoshone Indian woman who accompanied Lewis and Clark Expedition. Sacajawea\* means "bird woman". [Hunger had forced the Shoshones from the Rocky Mts. (of Montana) on a hunting expedition to the plains where Sacajawea was captured by Plains Indians. Their chief lost Sacajawea in a dice game to a Frenchman, Charbonneau, who took her East to Fort Mandan, † On their Westward journey, Lewis and Clark arrived at Mandan in 1804 and took her and her child with them, as a guide and so she could rejoin her tribe. Her presence with the party prevented Indian attacks, for "a woman with a party of men is a token of peace." Her husband accompanied the party as interpreter.

\* This spelling used on tombstone in Reservation in Wyo.; other spellings use a "g" in place of "j"  
 † North Dakota, where there is a monument.

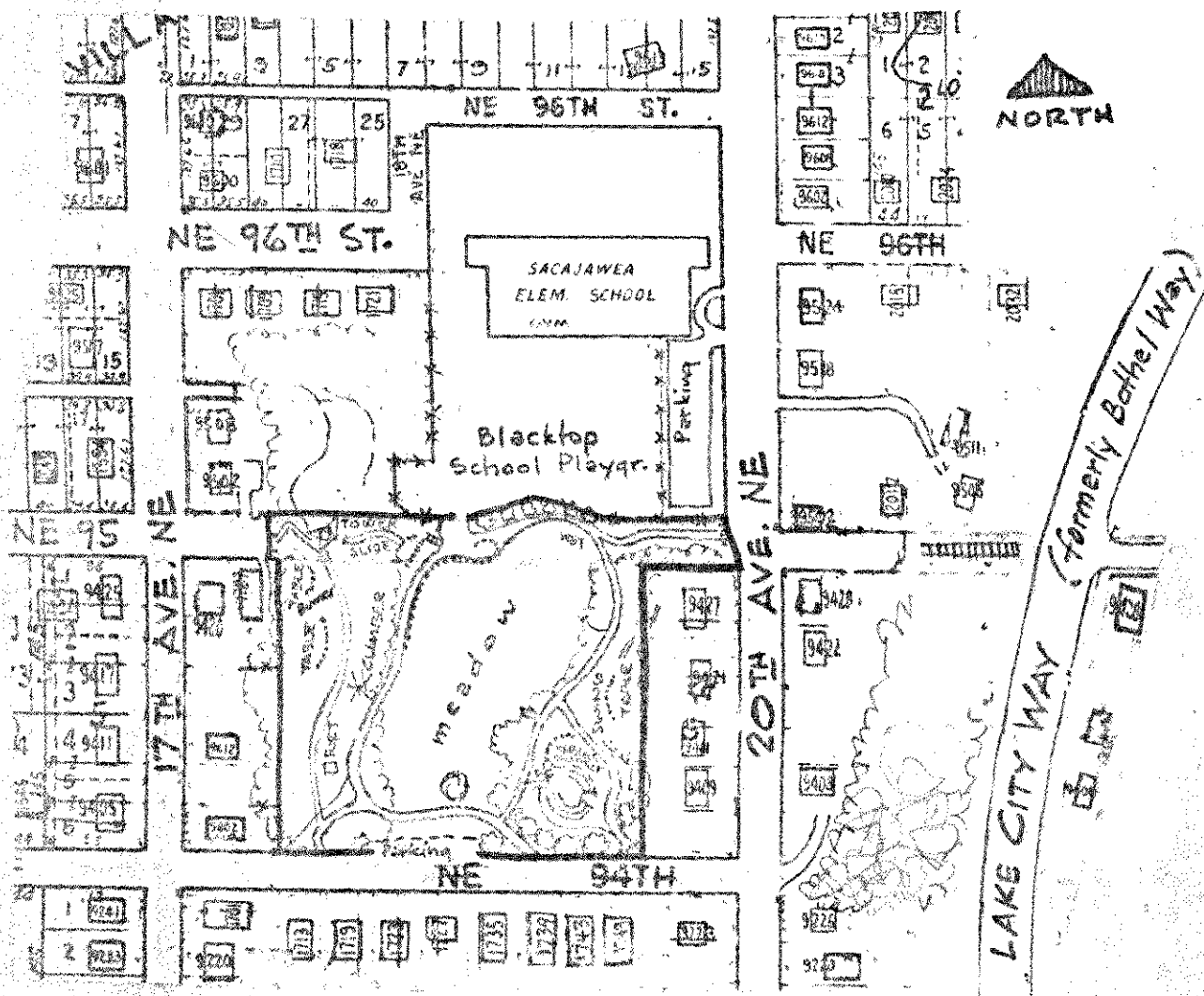

Improvements 1971 ↑

County park at Federal Way  
 State park + Museum @ Pasco  
 Lake in Walla Walla Co.  
 Highest Peak (10,033 ft.) in Wallowa  
 Mts. - NE Oregon.

133

2.6 Acres

Purch. 1961 (\$34,872 - '6000)  
 Street Use Permit: NE 95 (1967)

SACAJAWEA P.G.

0-11376