

"Westwood (Shopping) Village"

SW Barton St.



Headwaters of Longfellow Creek gathered in tile and drains northward under Barton St.; flows on thru West Seattle Golf to Elliott Bay.

Brush

29th Av. SW

(27th Ave. SW)

- 1 Climber
- 3 Chin-bars
- 10 Swings (4 Kiddie)
- 1 slide
- 1 Miracle-whirl
- 4 Pipe funnels

SW Cambridge St.

30th Av. SW

SW Cambridge St.

Small trees

Cambridge St. and Roxbury St. named for pioneer cities in Maryland and Massachusetts, both may be traced to British Isles - Cambridge, famed for its University and possibly Roxburghshire, in Scotland. (Refer to "Highland Park P.G.") There is a variety of apple known as Roxbury Russet.

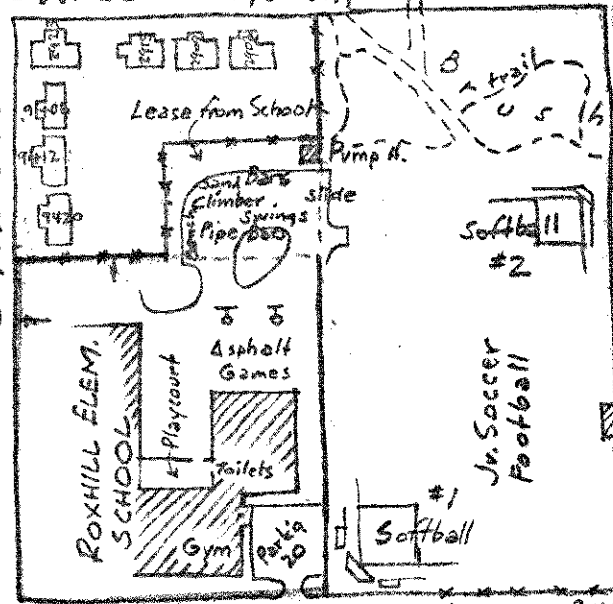

Brush

Old Building

Doctor Clinic

City Limits

SW Roxbury St.

Bus #20

Seattle City Limits King County

SERV. STA.

BOWLING

28th SW

Joint School-Park use agreement (1955) of building + playground.

Name taken from school which was named by the Roxhill Community Club - "Rox" from Roxbury St. and "hill" from the hills that surround the neighborhood.

The Club was instrumental in securing the site and providing playground equipt. (\$1,108) P.T.A. (#223)

13.0 Acres

+ 0.6 Ac. 99 yr. lease from School: 1960

Transferred 1955 (from Bldg. Dept.)

7Ac Gift of "Westwood Village" developers 1960 for zoning variance permit for "Village".

2800 SW Roxbury St. WE 5-2520

ROXHILL P.G.