

OBSERVATORY COURTS (top of Queen Anne Hill: Elev. 455 + "Tower" height")

34,848 sq. ft.

Purch. 1900: for munic. purp. \$10,000 = G.F.

Named "Observatory Park" by Council in 1902: but Tower closed to "observation" after 1934 + stairs removed.

Transf. jurisd. 1911: reserved right for Firehouse. Standpipes, etc.

Tennis Courts: 1939 - WPA + \$700 = Queen Anne Hi School Athletic Fund.

1964 - Light, Water + Fire Depts. (replaced WPA court)

Parkings: "Park Patrons Only" (adjacent to Tennis Ct.) / "Fire Dept. Employees" (on south side)

Lee St.: two pioneers, Lee Terry of Denny Party and Lee DeVries, lower w/ Judge McGilvra

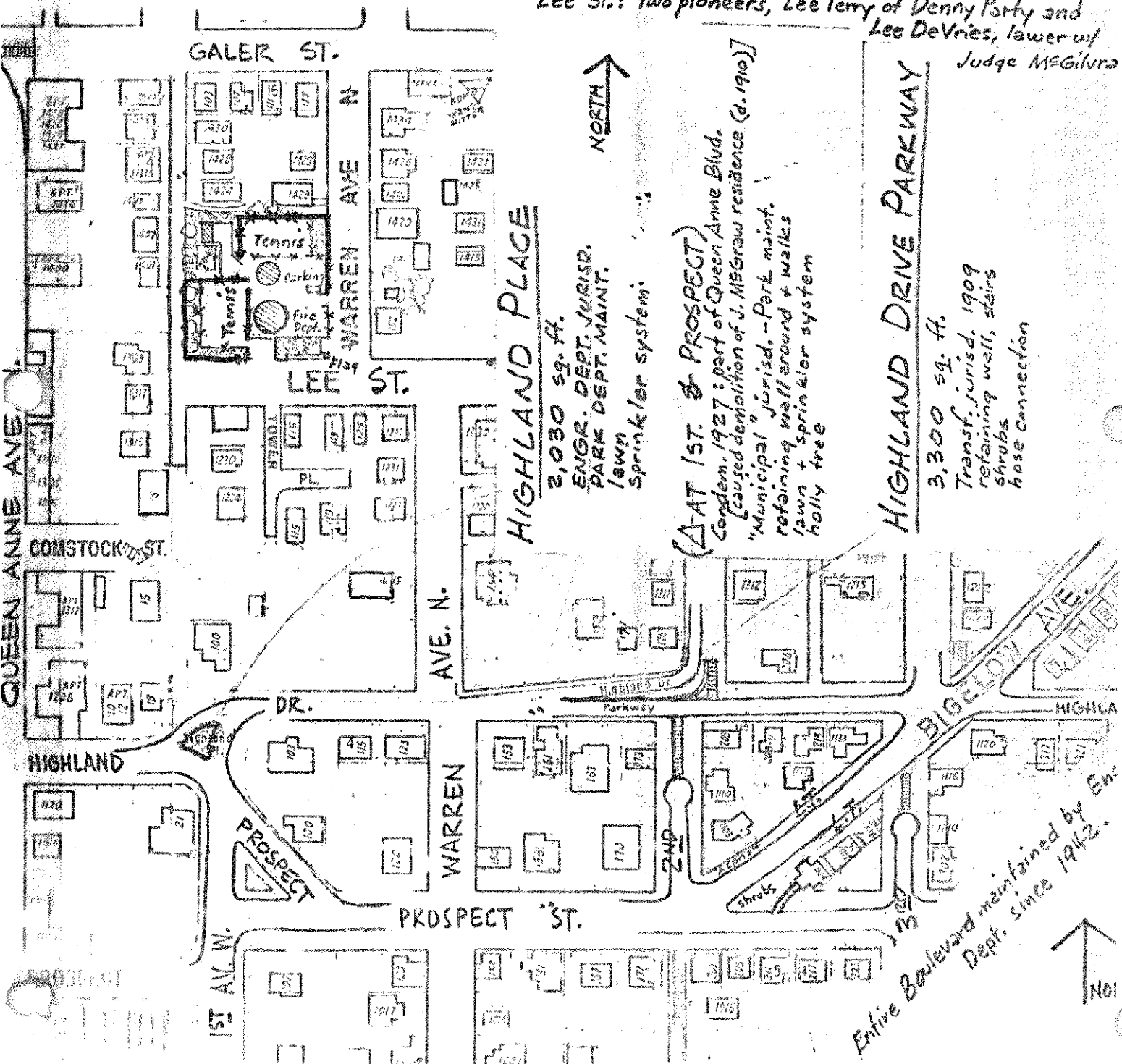

HIGHLAND PLACE
2,030 sq. ft.
ENGR. DEPT. JURIS.
PARK DEPT. MAINT.
lawn
sprinkler system.

(AT 1ST & PROSPECT)
Cordem. 1927: part of Queen Anne Blvd.
[caused demolition of J. McGraw residence (d. 1910)]
"Municipal" jurisd. - Park maint.
retaining wall around + walks
lawn + sprinkler system
holly tree

HIGHLAND DRIVE PARKWAY
3,300 sq. ft.
Transf. jurisd. 1909
retaining wall, stairs
shrubs
hose connection

Entire Boulevard maintained by Fire Dept. since 1942.

051264

HIGHLAND DRIVE PARKWAY
LEAD PULVE ENGR.

101576
OBSERVATORY COURT.

In 1900 the City purchased this small (8 lots) parcel on top of Queen Anne Hill and immediately constructed two Water Department standpipes with a stairway between the tank and masonry envelope leading to an observatory gallery on top. It must have been a popular attraction because in 1902 City Council officially named the property "Observatory Park" and built a similar standpipe with an "observatory" on top in Volunteer Park in 1906. Public use of Observatory Park must have brought pressure to improve the grounds around the standpipes, for the park was transferred to the jurisdiction of the Park Department in the summer of 1911 and it was immediately graded, landscaped and planted with flower gardens. By then the site must have included Fire Station No. 8 on the northeast portion of the park, for the Ordinance that transferred jurisdiction reserved the right to "erect and maintain necessary fire houses . . . and standpipes, water towers, and other appurtenances . . ."

By 1934 numerous complaints were being made regarding "nuisances . . . and more serious matters (with) police records covering same "in the stairways and observation galleries at both Volunteer and Observatory Parks. Neither the Water nor Park Department had employees on the Observatory Park site to provide surveillance of public use, so the adjacent Fire Station was asked "to watch same" (and the one at Volunteer would be closed no later than 6:30 p.m.) The Fire Department's answer is lost, but either then or after a trial period, the observation gallery here was closed to public use.

The discontinued use of this park together with the demand for tennis courts and the availability of WPA labor created a project to build a tennis court here. The firemen's response to this is known: requested that the Department construct rest rooms in one corner of the fire station with outside entrances to prevent continuous traffic through the station. Queen Anne High School agreed to furnish \$700 for materials for a second court, so in 1939 the WPA built two courts here, in spite of a legal hassle that one court would encroach over the "building (code) line". Lights were petitioned in 1945 but no funds were available, nor on the 1948 Bond.

In 1950 the "unused" northwest corner was transferred to Lighting for a microwave station.

In 1962 the Fire Department rebuilt the Fire Station, but in order to maintain fire protection "especially during the Century 21 Fair", the new station was built on a tennis court site at the southeast corner. Upon removal of the old station a new tennis court was built by the Light, Water and Fire Departments, with the Park Department providing necessary plantings. The new station does not provide toilets.

HISTORY: OBSERVATORY COURTS

In 1900 the City purchased this small (8 lots) parcel on top of Queen Anne Hill and immediately constructed two Water Department standpipes with a stairway between the tank and masonry envelope leading to an observatory gallery on top. It must have been a popular attraction because in 1902 City Council officially named the property "Observatory Park" and built a similar standpipe with an "observatory" on top in Volunteer Park in 1906. Public use of Observatory Park must have brought pressure to improve the grounds around the standpipes, for the park was transferred to the jurisdiction of the Park Department in the summer of 1911 and it was immediately graded, landscaped and planted with flower gardens. By then the site must have included Fire Station No. 8 on the northeast portion of the park, for the Ordinance that transferred jurisdiction reserved the right to "erect and maintain necessary fire houses . . . and standpipes, water towers, and other appurtenances . . ."

By 1934 numerous complaints were being made regarding "nuisances . . . and more serious matters (with) police records covering same "in the stairways and observation galleries at both Volunteer and Observatory Parks. Neither the Water nor Park Department had employees on the Observatory Park site to provide surveillance of public use, so the adjacent Fire Station was asked "to watch same" (and the one at Volunteer would be closed no later than 6:30 p.m.) The Fire Department's answer is lost, but either then or after a trial period, the observation gallery here was closed to public use.

The discontinued use of this park together with the demand for tennis courts and the availability of WPA labor created a project to build a tennis court here. The firemen's response to this is known: requested that the Department construct rest rooms in one corner of the fire station with outside entrances to prevent continuous traffic through the station. Queen Anne High School agreed to furnish \$700 for materials for a second court, so in 1939 the WPA built two courts here, in spite of a legal hassle that one court would encroach over the "building (code) line". Lights were petitioned in 1945 but no funds were available, nor on the 1948 Bond.

In 1950 the "unused" northwest corner was transferred to Lighting for a microwave station.

In 1962 the Fire Department rebuilt the Fire Station, but in order to maintain fire protection "especially during the Century 21 Fair", the new station was built on a tennis court site at the southeast corner. Upon removal of the old station a new tennis court was built by the Light, Water and Fire Departments, with the Park Department providing necessary plantings. The new station does not provide toilets.

HISTORY: OBSERVATORY COURTS