

Upon the request of Joint School-Park Staff Committee in 1950, and subsequent approval of City Council, the City Planning Commission made a study of the playground needs of the Community recommending this site as suitable and available - its' topography had prevented development - acquisition by Park + School Boards + local citizens (L.I.D.); and subsequently all three groups gave approval. The PTA + Neighborhood Council became "unusually and enthusiastically" active in the project volunteering to clear the site under the blessing of the City thru the guidance of the Park and Engineering Departments, as well as developing improvement plans for the site together with the Planning Staff of the Park Dept. Many disagreements arose over the timing of various work projects as well as the feasibility of improvements desired related to the rough topography. Grading was done with donated Navy equipment and operators (until 1965 there was a large Navy Housing Project - "Magnolia Manor" - just south of the Park) plus equipment from the Park Dept. The School District shared in payment of the cost of improvements and entered into a Joint-Use Agreement with the Park Dept. (recap below) Formal dedication, including the trail thru 28th Pl., was in 1969. "Mt. Suribachi (conical)": after long, arduous hours of labor on a development model of the park, the finishing touch was placing a flag in the spirit of the Iwo-Jima WWII victory. During the dedication the flag staff raising was repeated.

PARK (and the school) assume name from the District whose major feature, since its purchase in 1897 and naming in 1900, has been Fort Lawton. Honored is the Fort's first Commanding Officer, Maj. Gen. Henry W. Lawton famed captor of the Indian Chief Geronimo in 1886, who was killed in action in the Philippines in 1899.

Play Area:

- 6 swings
- 4 pipe tunnels
- 1 sand box
- 1 climber
- 1 slide
- 1 belly bar
- 2 chin bars

28th Pl. Area: supervision of "natural" improvements given to Park Dept. - Agron. Engr. Dept. & Council - 1955 (petition for this initiated by residents)

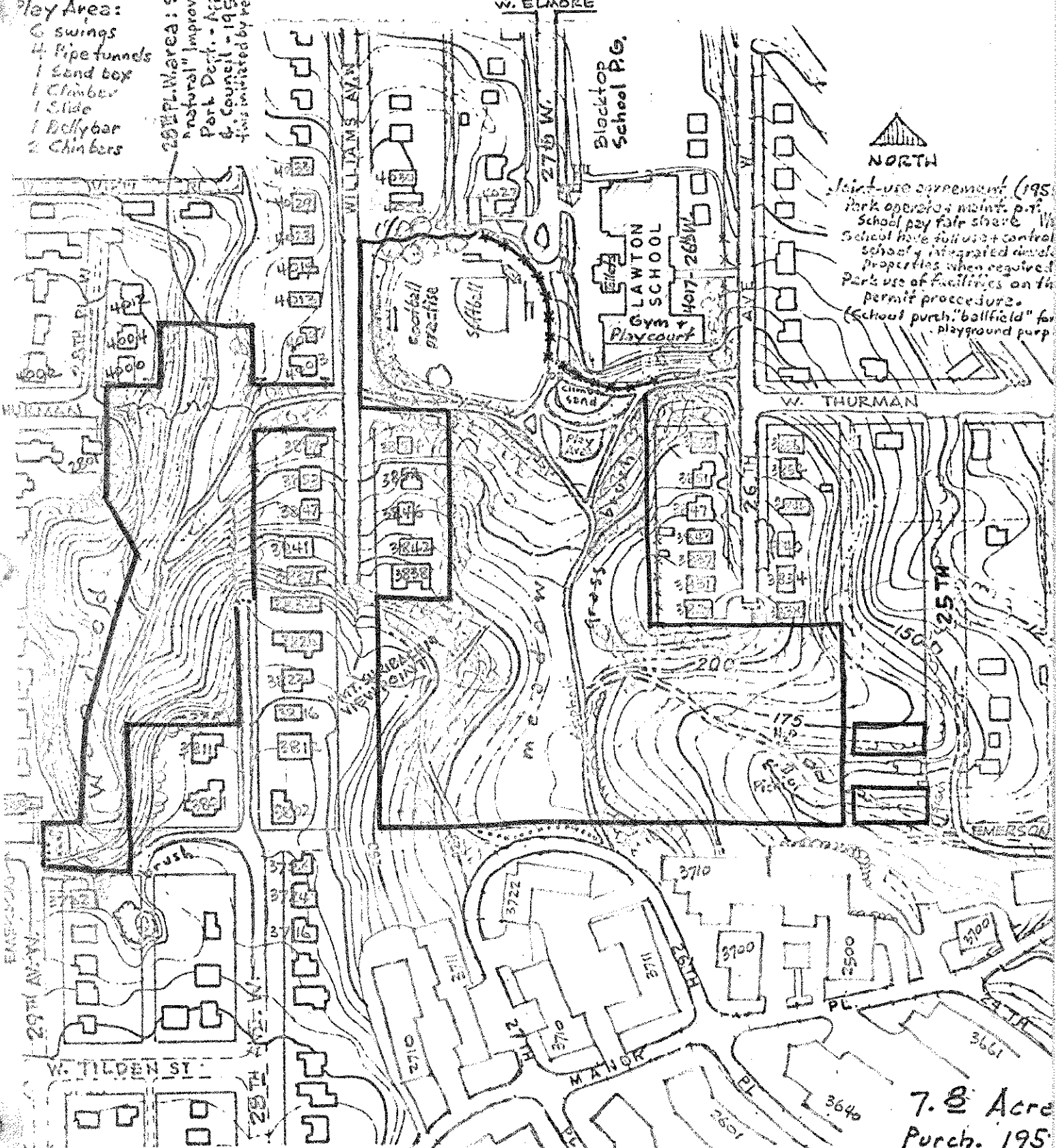

Joint-use agreement (1955)
 Park operates, maint. part.
 School pay part share
 School have full use + control
 school + integrated child
 properties when required
 Park use of facilities on the
 permit procedure.
 (School purch. "ballfield" for
 playground purp.)

321

101176

LAWTON PARK

7.8 Acre
 Purch. 195
 \$30,264 = L.I.D.
 "for park + p.g. purp."