

The Gilman Park Community Club initiated a Local Improv. Distr. to acquire playground: 1928. It was referred to as "West Woodland P.G." until the Club petitioned in 1932 for the name: "Gilman Playground."

This District had been platted in 1882 as "Gilman Park Addition" by Capt. Ballard, Thomas Burke and John Leary who bought it from Donation Claim holders Ira Utter + Hall. The town that developed was named Ballard (refer to Ballard P.G.)

Daniel Hunt Gilman: 1845-1913: native of Maine, Civil War infantryman, entered Columbia Law School in 1870, practicing law in New York, coming to Seattle in 1882. Together with Judge Burke, originated a plan for a railroad from salt water in Seattle connecting with the Canadian Railway at Sumas (Seattle, Lakeshore + Eastern Ry)* because Seattle was being bypassed by Great Northern Ry: poor service + exorbitant rates. Gilman secured financing from Seattle bankers as well as New York. Construction of shops for the railroad attracted worker-residents to Smith Cove (Interbay) area. His brother, L.C. Gilman, was also a lawyer and active in promoting railroads; and Judge Burke's set project was bringing the railroad to Seattle. G.P. Gilman was Northwestern Traveling Agent for the Union Pacific RR in 1869: opening date of regular service from East to Omaha to San Francisco.

* See BURKE-GILMAN TRAIL

Large trees transplanted from Woodland Park in 1932 from Aurora Ave. right-of-way.

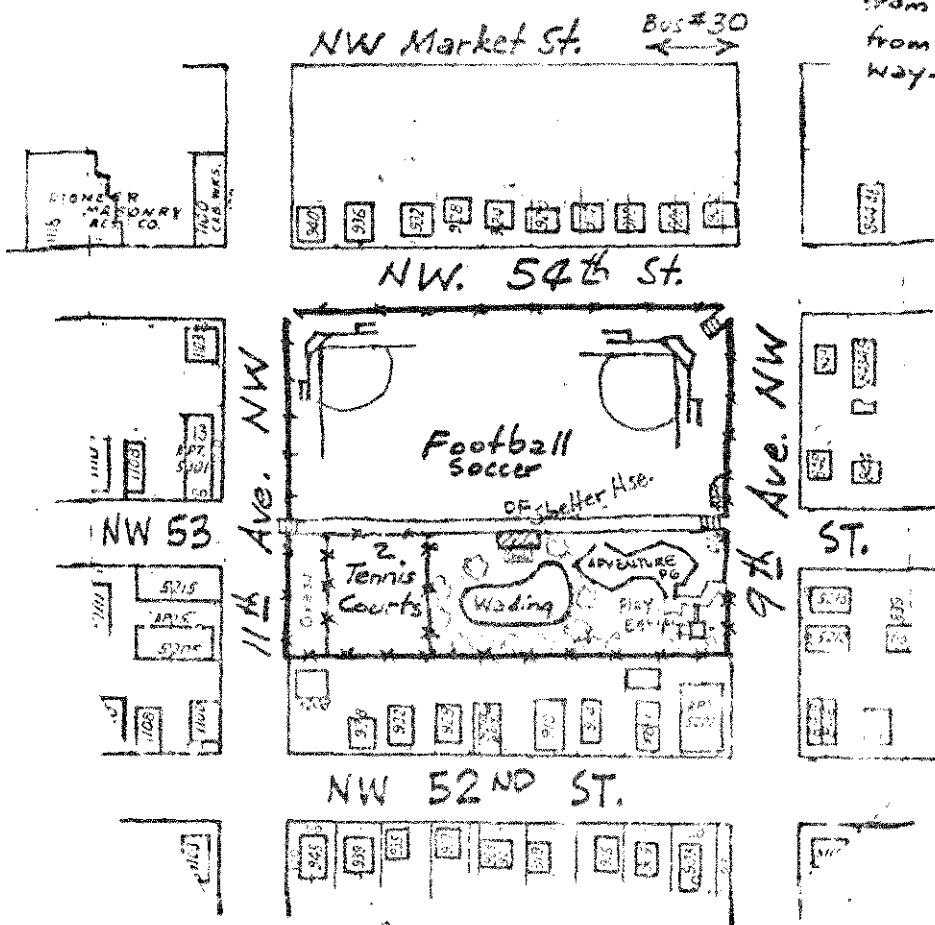

Shelterhouse 1932: \$3,877 = Remodelled 1973

- 1 Tetherball
- 6 swings/2 tire swings
- Climber
- Slide
- Spring board
- "Adventure P.G." (Model Cities Board fence surround 1973)

212

3.9 Acres
 Purch. in 1931 (\$14,355 = L.I.D. 5,658 = G.F.)
 "for park + playgr. purposes"

"ADVENTURE P.G."

923 NW 54th St.

GILMAN P.G.

082476