

(LOFT = 49 people)  
for BAND  
STAGE  
PICNIC USES.

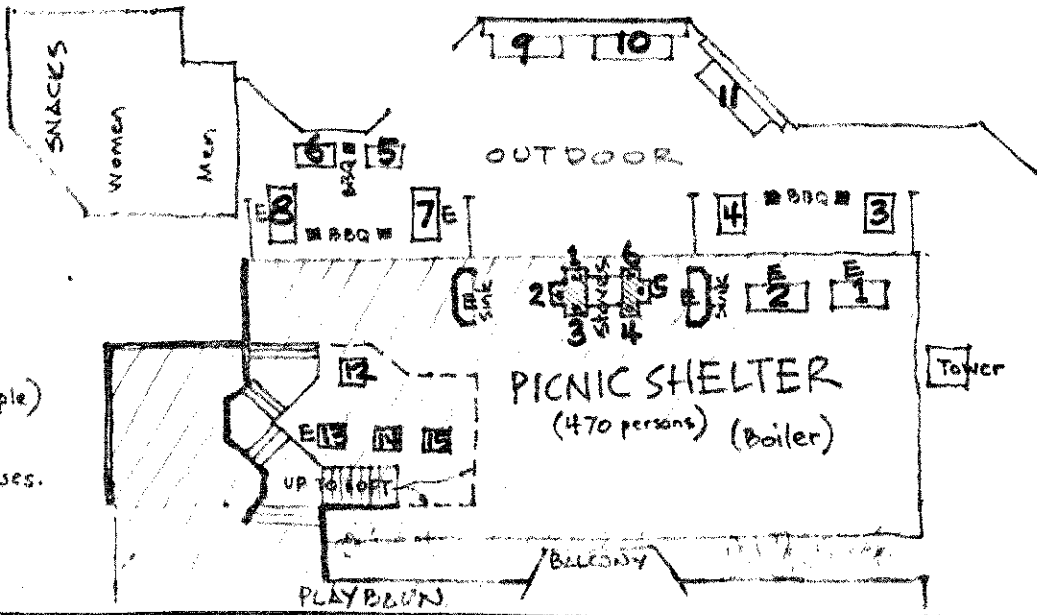

PICNIC TABLES  
that may be reserved:  
Nos. 1, 2, 7 + 8 = 14 persons each  
Nos. 3, 4, 5 + 6 = 10 persons each  
Nos. 12, 13, 14 + 15 = 8 persons each  
Nos. 9, 10 + 11 = 14 persons ea/not reserved  
E = Electric Outlets  
BBQ = Charcoal Burners

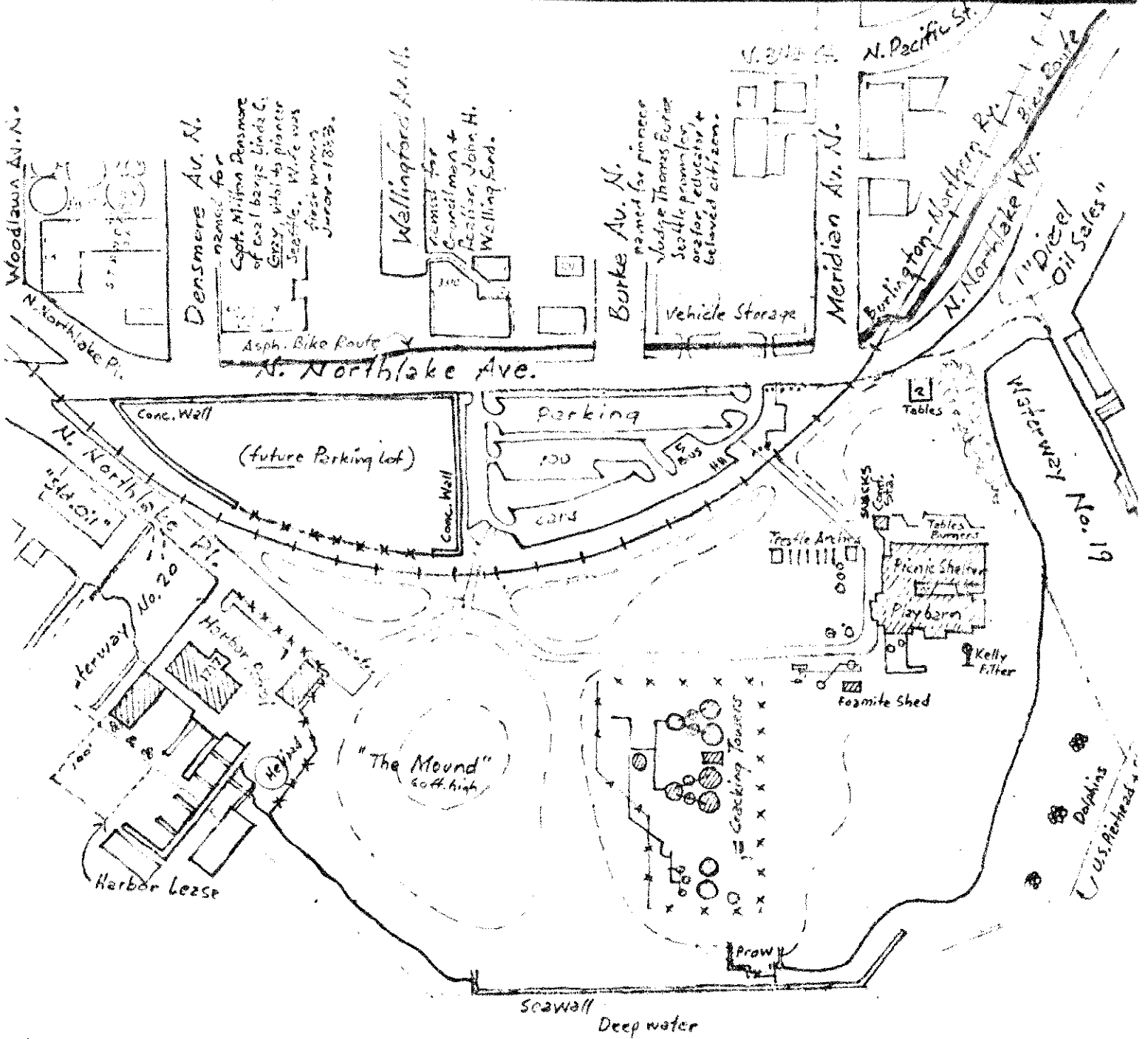

↑ NORTH  
113  
Union

2000 N. Northlake Way  
**GAS WORKS PARK**

20.75 Ac.  
Incl. 0.6 Ac. Shorelands  
+ Harbor Lease = 0.25 Ac.  
shoreline 1900 line.  
Transf. 1963 (\$45,000 @ '60 &  
from Water Dept.  
Purch. 1963-73 (\$1,526,352 @ '61  
from Gas Co. - 10 yr. term contract  
"for park, public use + ship base"  
Cadden 1964 - \$37,000 @ '60 + \$172,500  
+ Harbor Lease - \$1500 @ '60  
for park, etc.  
+ loading +

062476

**GAS WORKS PARK**  
2000 N. Northlake Way

Purchase 1963 - 1973  
1963: \$45,000 (60 bf)  
2 lots fr. Water Dept.  
1963-73: \$1,336,352 (GF, Pk. Fd., FT) fr. Seattle Gas Co. - 10 yr. contract  
1964: \$37,000 (60 bf) & \$120,500 - Harbor Patrol - 30% H.U.D. funds

Acreage: 20.75, incl. 0.6 ac. submerged shoreline & 0.25 ac. harbor lease

Development: 1971 master plan, Rich. Haag Assc. Phase I Stage 1, 2 - \$3,262,000 (2,552,000 FT, 710,000 CDBG) completed 1976.  
Stage 3: \$368,000 (8,000 FT, 360,000 CDBG) completed 1978.

Elements: picnic shelter - 13,000 sq. ft., play barn - 11,000 sq. ft., mound & amphitheater, sundial on mound (C. Greening, K. Lazare - artists 1978), mural (S. Singh - 1978)

