

LAKE CITY RECREATION CENTER: Name assumed from pioneer RR Sta: "LAKE". Site had been King County Park #31 until it was sold in 1953 to the Lake City Lions Club for "recreation purposes." In 1955 the Club built the original portion of the Center and staffed it to provide recreation for youth. (At the NW corner of 28th + 125th was the first school in the district, built in 1914 and abandoned in 1954 upon construction of the school across 125th. (In 1954 the district was annexed to Seattle.) Upon community petition and with approval of The Planning Commission the school property was purchased in 1958 (\$19,500.00) but the school building was not suitable for recreation purposes so it was boarded up and playground equipment installed in the "schoolyard". In 1964 the Lions Club gave their property with the Center, to the City on the condition that the Department sell the old school site to the Library and the \$50,000.00 from the sale be used to enlarge and remodel the Center; improvements actually cost \$56,341.00.

[WILL ROGERS MEMORIAL - placed at the Library in 1966 when the Polo Field it had marked SE of 15th + 137th was developed into residences. The community had petitioned this Dept. to "accept" the shaft + medallion (Alonzo Lewis, sc.) Rogers had starred at Polo Field.]

ALBERT DAVIS PARK: Responding to community petition; play area adjacent to the Center was named in 1972 to honor a leading citizen of the Lake City community: Albert Davis (1890-1971). Born in Buffalo, NY, he was a member of the Keystone Kops then charter member of Lake City Vigilantes, originated annual salmon barbecue (w/ his own "Indian Secret Seasoning") of Lake City Pioneer Days Celebration, prime mover at the Youth Center, portrayed Santa Claus for 8 years - loved children everyday - unofficial goodwill ambassador - mayor of Lake City, awarded the Golden Acorn by the PTA in 1971, just before a fatal cerebral hemorrhage.

Two trees on South side of Library have been killed in sawmill accident, the other in WWI (1919)

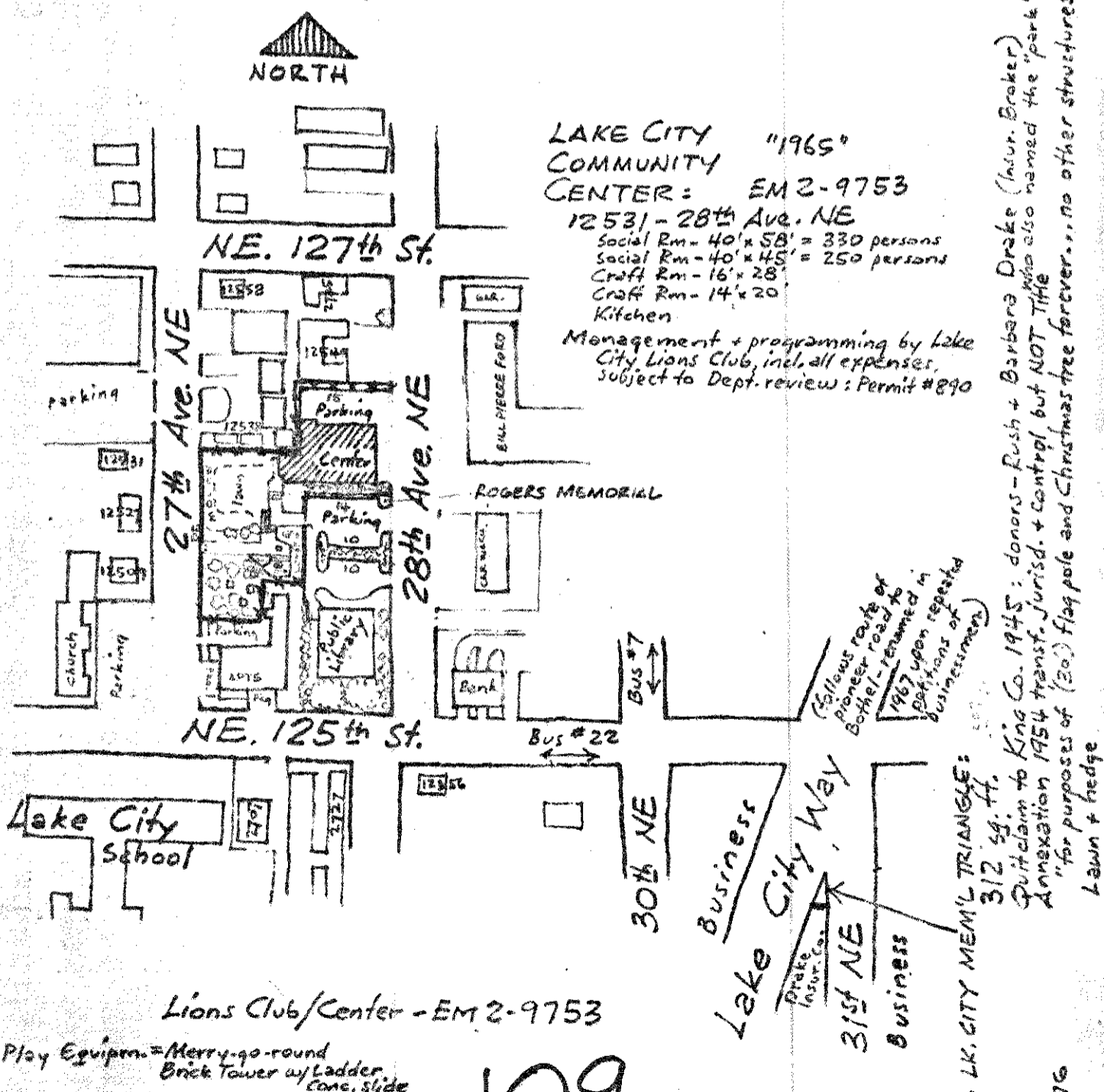

LAKE CITY COMMUNITY CENTER "1965"
 CENTER: EM 2-9753
 12531 - 28th Ave. NE
 Social Rm - 40' x 58' = 330 persons
 Social Rm - 40' x 45' = 250 persons
 Craft Rm - 16' x 28'
 Craft Rm - 14' x 20'
 Kitchen
 Management + programming by Lake City Lions Club, incl. all expenses, subject to Dept. review: Permit #890

Lions Club/Center - EM 2-9753
 Play Equipm. = Merry-go-round
 Brick Tower w/ Ladder
 Conc. slide
 Crawl in room

1.2 Acres
 Gift: 1964
 for developm. of Center.

109

DAVIS PARK/LAKE CITY CENTER

LAKE CITY MEMORIAL TRIANGLE

090876