

Fauntleroy was the name given to the nearby Cove (and subsequently the area) by Lt. Geo. Davidson in 1857, marine surveyor, in honor of the family of his betrothed, Ellinor Fauntleroy.

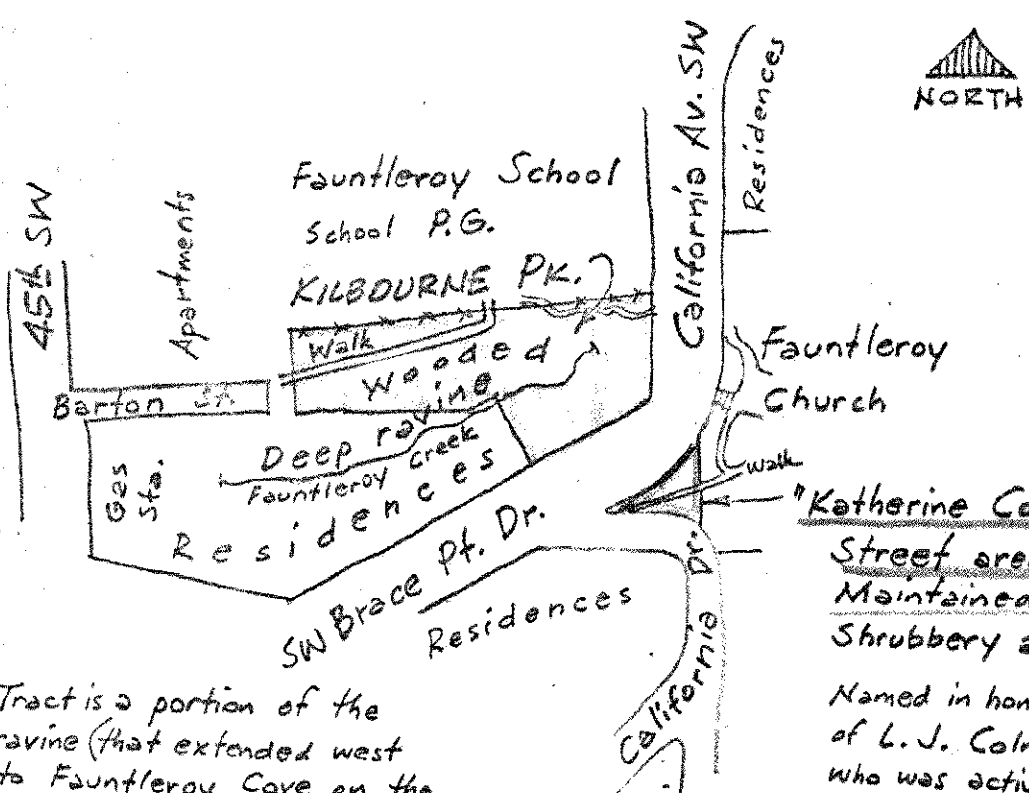

Tract is a portion of the ravine (that extended west to Fauntleroy Cove on the Sound) across which the former Fauntleroy Traction crossed at (45th) on a trestle to end shortly at a station called "Endolyne" (at 45th and Roxbury).

Gift of Dr. Edw. C. Kilbourne - 1951 who had envisioned it as an amphitheater and camp, but is being kept in its natural state. Named in his honor; was a pioneer settler in the vicinity, electrical engineer who brought electrical lighting to Seattle and electrified the horse-car lines to N. Seattle and Lake Union, promoted and developed Fremont District.
13,500 sq. ft.

"Katherine Colman Triangle"
Street area - Engr. Jurisd.
Maintained by Park Dept.
Shrubby and trees, retaining wall.
Named in honor of a daughter of L. J. Colman, pioneer settler, who was active in founding the adjacent church.

WE 5-2520
COLMAN TRIANGLE
KILBOURNE PARK