

BOYLSTON PL.

195 sq. ft.  
 2 Trees, low retaining wall - lawn, Walk  
 Name taken from adjacent street which was named by Arthur Denny.  
 Deed from Mary Denny - 1902 on the condition that it be beautified as a park, monument or fountain.

Marion St. named for James Marion Denny, brother of Arthur and David, who had been named for Gen. Frances Marion, "swamp fox" of the Revolution.

Columbia was the name proposed for the new Territory, but Congress chose to honor Gen. Washington when it named the state in 1889.

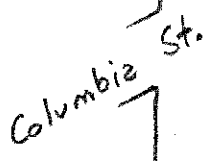

Terry Av. and property subdivision named for Charles Terry, member of the pioneer party that landed at Alki - 1851

Name taken from adjacent Avenue, which was named for the pioneer Boren family who built the first cabin across from Alki - now downtown Seattle. Louisa Boren was first unmarried girl to come to Seattle (1852).

P.G. SHOPS (0.33 Ac.) 14,400 sq. ft.

(Firestation #3 - 1903-24; horse-drawn - now oldest station in Seattle. Deactivated w/ advent of motor trucks. In 1928 USE of property transf. by Council for warehouse (+ repair) purposes.

301 TERRY AV.  
 Ju3-2876

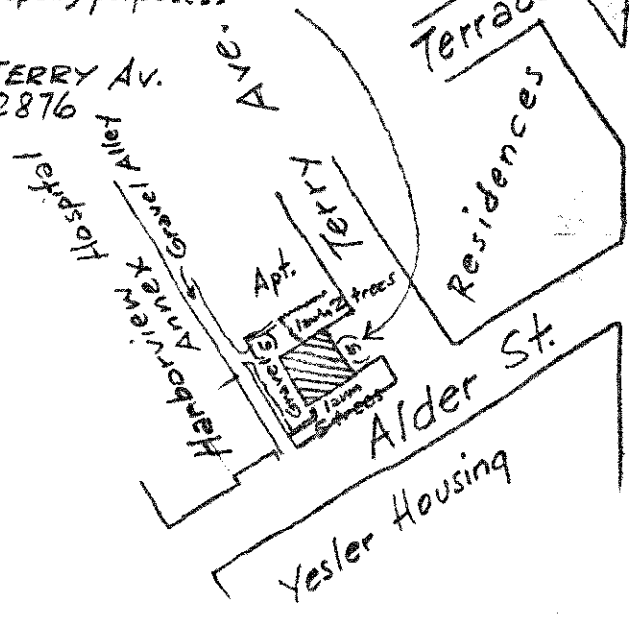

1890: Deed to City by Nellie Scurry et al. understood use for "Boren Av. Engine House!"  
 1909: Supreme Court decision sustained right to use prop. for any city purpose.  
 1912: Transf. jurisd. + control to Park Board  
 1200 sq. ft.

2 benches, 3 trees, lawn  
 Viewpoint of Cascades + Mt. Rainier

BOREN PL.

JU 3-2797 Dist. Foreman

BOREN PL.  
BOYLSTON PL.  
 PLAYGROUND SHOPS 7.