

No sidewalk along either side of boulevard from  
Howe St. to (Highland Dr.)



Spectacular + panoramic viewpoints of Lake Union,  
Capitol Hill and Business Districts from Bly Kracke  
Park and the Boulevard (betw. Blaine + Howe Sts.)

PLAY EQUIP. @ KRACKE: slides, sand,  
climber }  
Bike Racks

Worksheet 2/5  
1930/1958  
ANNIE MI-SCHOOL

QUEEN

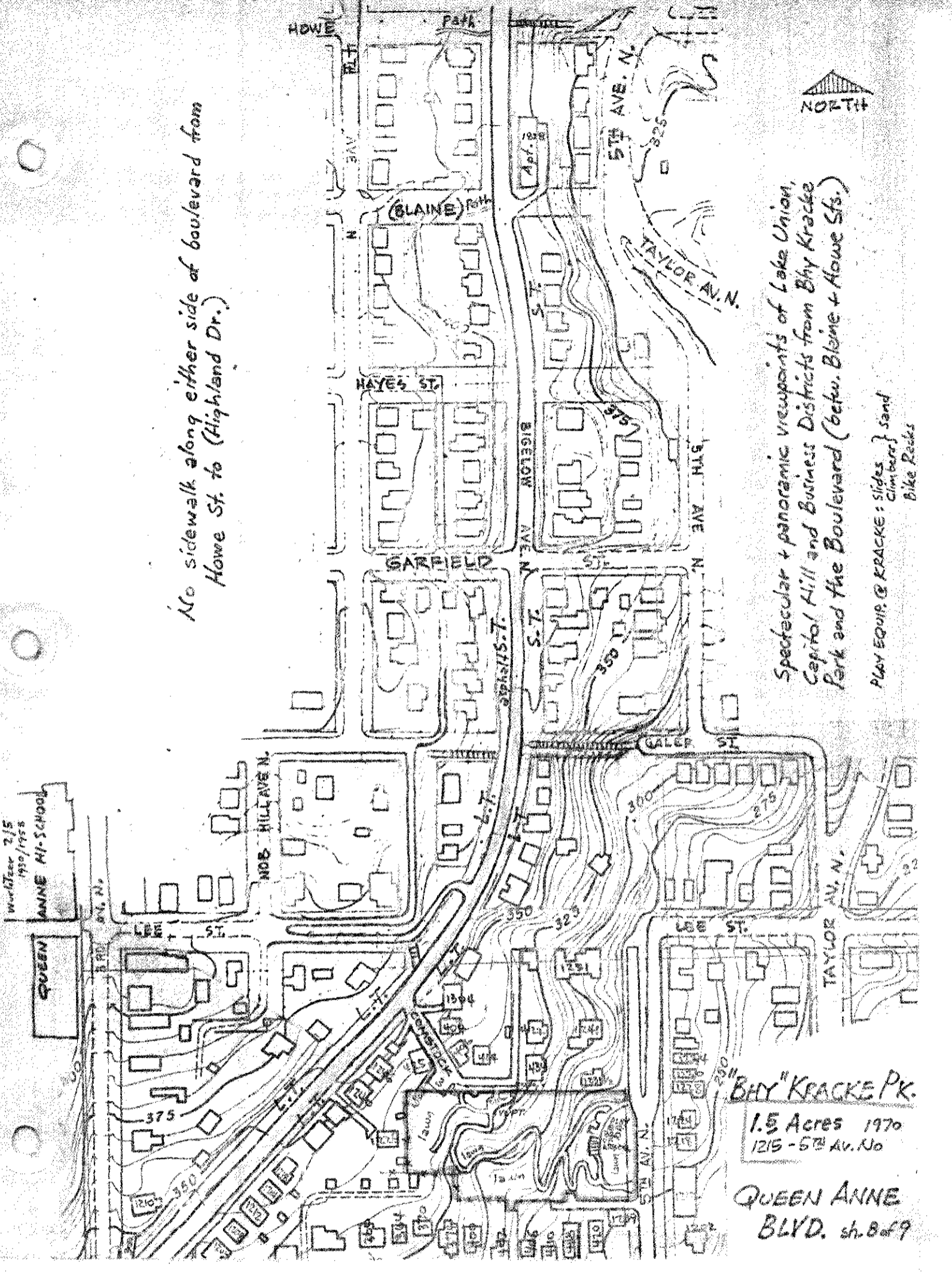

BLY KRACKE PK.  
1.5 Acres 1970  
1215 - 5TH AV. NO

QUEEN ANNE  
BLVD. sh. B of 9

"By cracky, Huck! We done named a park in Seattle!" So Tom Sawyer might have exalimed to his friend, Huckleberry Finn. Not that Mark Twain coined the phrase, because the use of the American spoken idiom in print had pre-  
ceded the writings of Samuel Clemens (1835-1910). "But the use of fragrant vernacular in humorous yarns was brought to full flower in Mark Twain" - (Chas. Neider). The first known use of "By cracky" was in a story by Mary J. Holmes, "Tempest and Sunshine" (1854). Dictionaries of Vernacular and Slang indicate that this expression was widely popular by 1888.

One such fan was WERNER H. KRACKE for it became his favorite expression of surprise or delight. "He was a 'By-cracky' person!" said J. A. Mitchener (WAC) and it became his nickname, although he spelled it "Bhy" or "Bye". His file at the Washington Athletic Club revealed that he was born in Nebraska in 1902, moving to California in 1925, then to Buenos Aires until 1930, when he came to Seattle. He went to work as a teller in the Marine Central Bank and by 1944 had become auditor for the National Bank of Commerce, a position he held until his retirement in 1957.

After spending several summers in San Diego he moved to a condominium in Kaneohe, Hawaii, in 1966, returning to Seattle on regular visits. He lived for many years on the upper level of this park and said that he watched the Denny Regrade from here. Bhy Kracke decided to dispose of this site - either for a park or for an apartment. He wanted certain features included in the park (and he made a "zillion" sketches) so that he would "be interested" in contributing toward the development.

Compromises were made and Mr. Kracke agreed to give \$20,000 toward development and was en route from Hawaii to do that in 1971 when he died aboard ship. But the Estate Administrator had not been so authorized, so the property was bought and developed as a Forward Thrust project.

Mr. Kracke was a golf addict and an avid gardener - he wanted the park to be a miniature Butchart Gardens. He built one of the retaining walls with large jardinieres. The final design of the viewpoint park by Roy Lehner, landscape architect, included many features desired by Mr. Kracke - the path system with the many "surprise" views, the location of the viewpoint, and the reactivation of the barbeque pit that "had been lost" in the brambles, as well as utilizing many of the small retaining walls and plantings by Mr. Kracke.

History - "BHY" KRACKE PARK  
10/11/74