

Seattle City Clerk's Office

Comptroller File

171971

NOTICE: IF THE DOCUMENT IN THIS FRAME IS LESS CLEAR THAN THIS NOTICE  
IT IS DUE TO THE QUALITY OF THE DOCUMENT.

FILE NO. 171971

Petition

OF

Seattle Housing Authority

For vacation of Terry Avenue and alley between Alder and Spruce Streets (Yesler Terrace Add.)

11-13-41 B.P.W. 12/1/42 - file

FILED NOV. 22, 1941.

W. C. THOMAS  
CITY COMPTROLLER AND EX-OFFICIO CITY CLERK

BY *W. C. Blanton* DEPUTY

ACTION OF THE COUNCIL

REFERRED NOV 24 1941 TO STREETS & SEWERS

REFERRED

REPORTED

REPORTED

REF. FOR ORD.

REPORT ADOPTED

REPORT ADOPTED

C. B. ORD.

DISPOSITION

ON FILE

APR 6 - 1942

REPORT OF COMMITTEE

Mr. President:

Your Streets & Sewers Committee

to which was referred the within petition

would respectfully report that we have considered the same and respectfully recommend that

the same be placed on file.

CHAIRMAN

*Carroll*

CHAIRMAN

*P. ...*

NOTICE: IF THE DOCUMENT IN THIS FRAME IS LESS CLEAR THAN THIS NOTICE IT IS DUE TO THE QUALITY OF THE DOCUMENT.

John E. Carroll  
~~XXXXXXXXXXXXXXXXXXXX~~  
Sewer  
Streets & Sewers

November 24, 1941

Board of Public Works  
City of Seattle

Gentlemen:

I am forwarding herewith File No. 171971, being petition of Housing Authority for vacation of Terry Ave. and alley between Alder and Spruce Sts. (Yesler Terrace Add.), with the request that you return same with your report and recommendation thereon.

Very truly yours,

John E. Carroll, Com.

NOTICE: IF THE DOCUMENT IN THIS FRAME IS LESS CLEAR THAN THIS NOTICE  
IT IS DUE TO THE QUALITY OF THE DOCUMENT.

# THE CITY OF SEATTLE

DEPARTMENT OF PUBLIC WORKS  
508 COUNTY-CITY BUILDING

G. W. ROBERGE, SECRETARY  
MAIN 8000 - LOCAL 435

March 26, 1942

Re: Council file #171971 -  
Petition of Seattle Housing Authority  
for vacation of Terry Ave. and  
alley between Alder & Spruce Sts.  
(Yesler Terrace Addition)

Honorable Streets & Sewers Committee  
Seattle City Council

Gentlemen:

The above Council file is herewith  
returned and in view of the fact that the matters  
covered in this petition have been separately  
disposed of it is recommended that the petition  
be placed on file.

Respectfully yours

BOARD OF PUBLIC WORKS



G.W. Roberge - Secy.

CWR:R  
CC: Supt. of Lighting  
Mr. Will

NOTICE:  
IF THE DOCUMENT IN THIS FRAME IS LESS CLEAR THAN THIS NOTICE  
IT IS DUE TO THE QUALITY OF THE DOCUMENT.

Comptroller's File No. 171971  
Pet. of Seattle Housing Author-  
ity for vac. Terry Ave. bet.  
Alder St. and Spruce St., and,  
The Alley from Alder St. to  
Spruce St., between 9th Ave. and  
Terry Ave.

March 19, 1942.

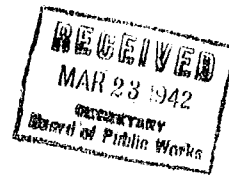

Honorable Board of Public Works,  
Seattle, Washington.

Gentlemen:

The above referenced petition was, on  
January 8, 1942, referred to the Street Vacation  
Committee of the Board for further study.

Since that time, the matters covered  
by the petition have been separately disposed of.

It is therefore recommended that the  
petition be filed.

Respectfully,

A handwritten signature in dark ink, appearing to read "C. L. Warteelle".

C. L. WARTEELLE,  
City Engineer.

CGW:h

Ret. - file

NOTICE: IF THE DOCUMENT IN THIS FRAME IS LESS CLEAR THAN THIS NOTICE  
IT IS DUE TO THE QUALITY OF THE DOCUMENT.

REPORT ON PETITION

12-16-41

File No. 171971

Improvement of Terry Ave. & alley W. thereof  
From Spruce St to Alder St.  
By Vacation

Total Frontage 959.68 Lin. Ft. Total Area \_\_\_\_\_ Sq. Ft.  
% of Frontage % of Area

Valid Signatures 87.5%  
Incomplete Signatures \_\_\_\_\_  
Invalid Signatures \_\_\_\_\_  
King County 0

RECEIVED  
JAN 8 - 1942  
SECRETARY  
Board of Public Works

RECEIVED  
DEC 30 1941  
SECRETARY  
Board of Public Works

\_\_\_\_\_ % Limit of Assessment . . . . \$ \_\_\_\_\_  
Maximum Rate . . . . . \$ \_\_\_\_\_  
Approximate Rate for this Improvement . . . . \$ \_\_\_\_\_

Worked by E.J.  
Approved by [Signature]

h  
6-10-38

NOTICE: IF THE DOCUMENT IN THIS FRAME IS LESS CLEAR THAN THIS NOTICE IT IS DUE TO THE QUALITY OF THE DOCUMENT.



NOTICE: IF THE DOCUMENT IN THIS FRAME IS LESS CLEAR THAN THIS NOTICE  
IT IS DUE TO THE QUALITY OF THE DOCUMENT.

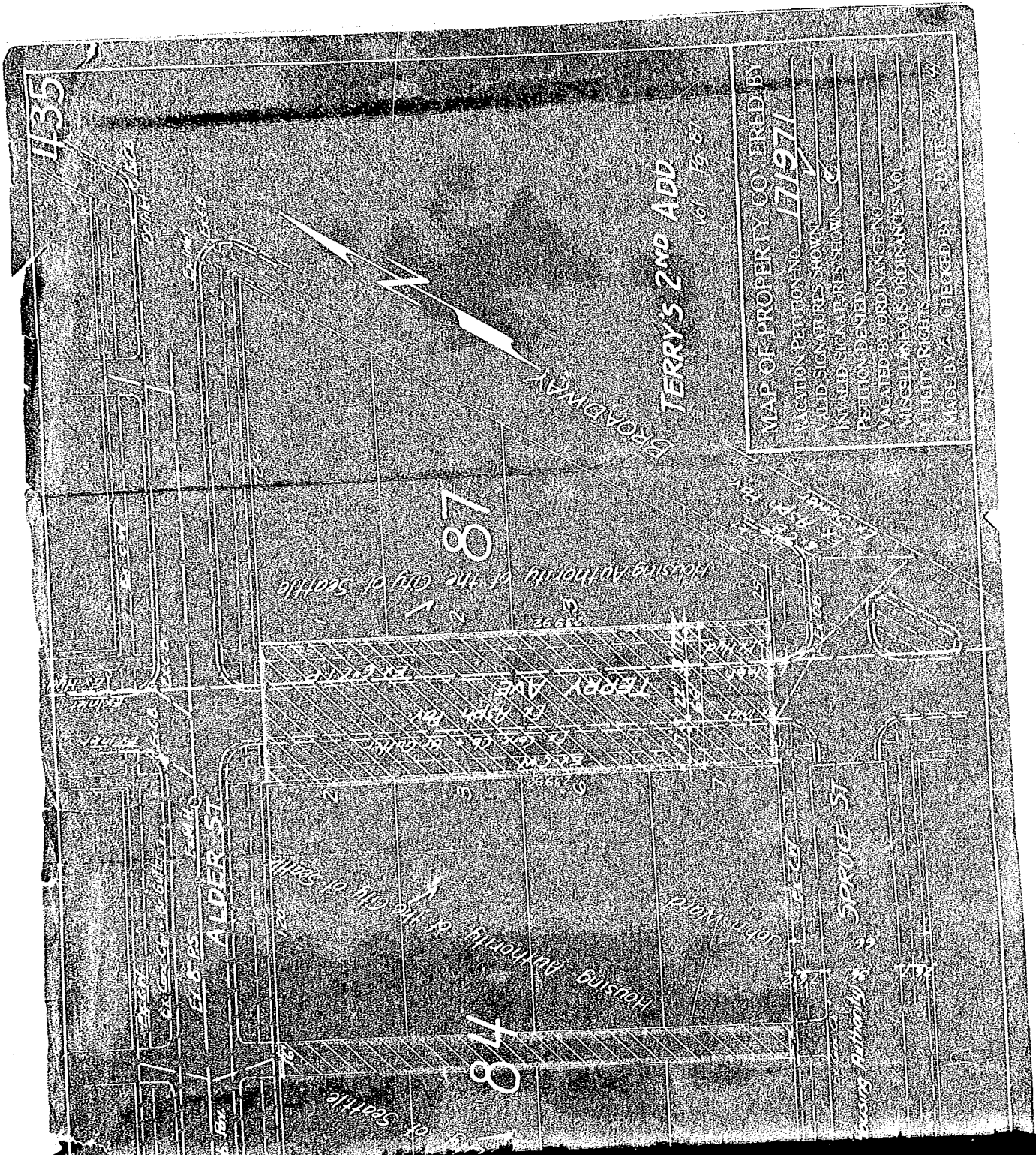

RECEIVED  
DEC 30 1941  
SECRETARY  
Board of Public Works

RECEIVED  
JAN 8 - 1942  
SECRETARY  
Board of Public Works

NOTICE: IF THE DOCUMENT IN THIS FRAME IS LESS CLEAR THAN THIS NOTICE  
IT IS DUE TO THE QUALITY OF THE DOCUMENT.

G. W. COPLEN  
CHAIRMAN

MRS. M. C. HENDERSON  
VICE-CHAIRMAN

KENNETH J. MORFORD

NAY S. ROGERS

CHARLES W. DOYLE

## HOUSING AUTHORITY OF THE CITY OF SEATTLE

TELEPHONE  
MAIN 7854

250 Central Building  
SEATTLE, WASHINGTON  
November 18, 1941

EXECUTIVE DIRECTOR  
JESSE EPSTEIN

The City Council  
City of Seattle  
c/o City Clerk  
County-City Building  
Seattle, Washington

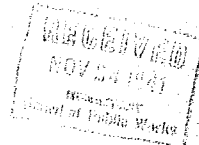

Gentlemen and Madam:

Pursuant to Paragraph 7 of the Cooperation Agreement between the City of Seattle and the Housing Authority of the City of Seattle dated November 6, 1939, we hereby respectfully petition your Honorable Body for the vacation of Terry Avenue and the alley situated in mid-block between said Terry Avenue on the east and Ninth Avenue on the west. The portion of said Terry Avenue and alley sought to be vacated is bounded on the north by Alder Street and on the south by Spruce Street.

The Housing Authority of the City of Seattle is the owner of at least two-thirds of all property fronting on both sides of those portions of said Terry Avenue and the alley, the vacation of which we are seeking.

For your information, this Authority is seeking the vacations herein petitioned for in connection with the development of the Yesler Terrace Addition, Project No. WASH-1-5, the location of which was filed with you by virtue of our letter dated December 2, 1940.

Sincerely yours,

*Jesse Epstein*  
Jesse Epstein  
Executive Director

✓  
JE:HAN:BG

NOTICE: IF THE DOCUMENT IN THIS FRAME IS LESS CLEAR THAN THIS NOTICE IT IS DUE TO THE QUALITY OF THE DOCUMENT.